

TOWER CABINET

84", 86 1/4", 92 1/4" & 98 1/4"
Diag Corner Larder
with Wine Rack Cabinet

Assembly Guide

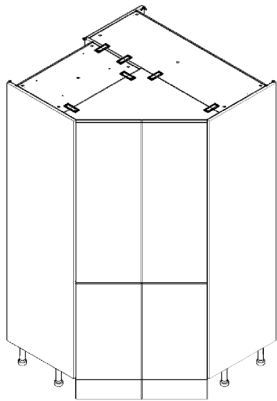

70/30 Door

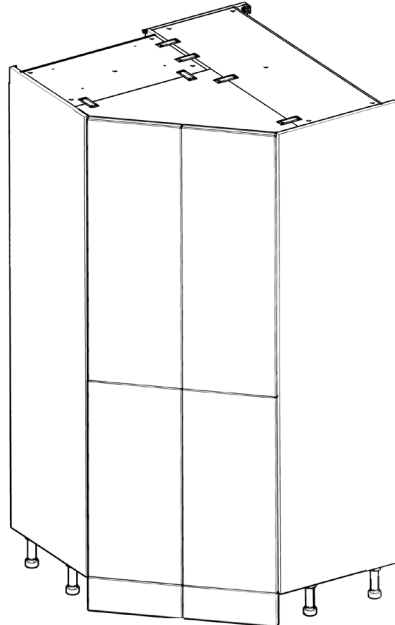

84" x 24"

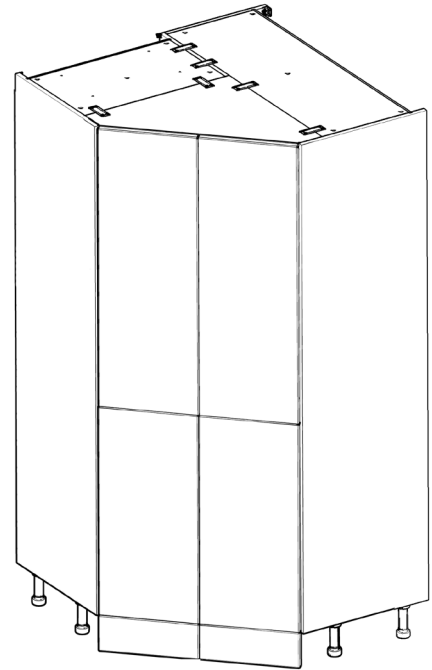

86 1/4" x 24"

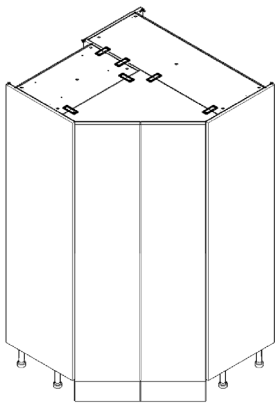

2 Door

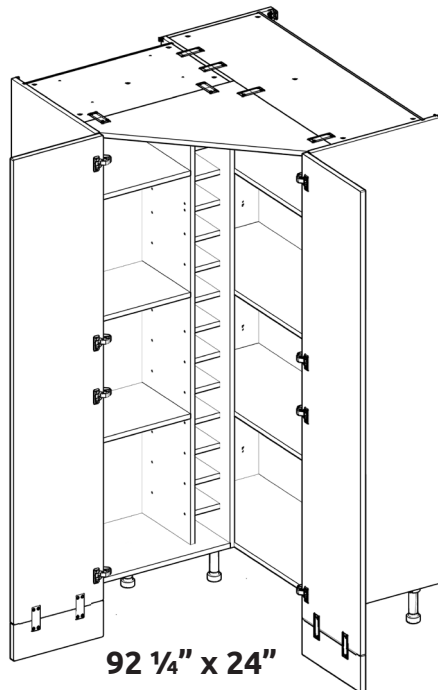

92 1/4" x 24"

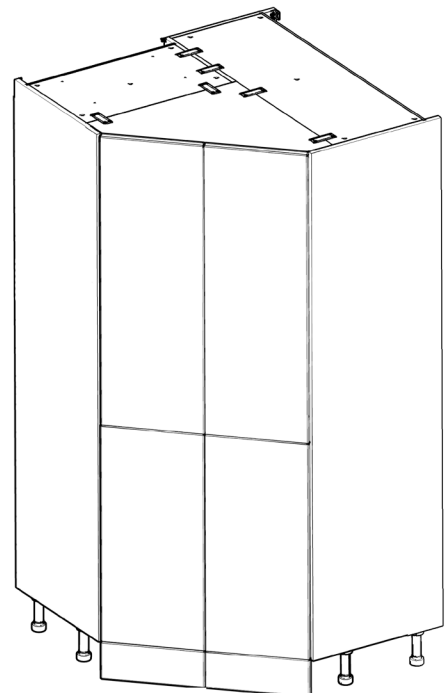

98 1/4" x 24"

wren
KITCHENS

TOWER CABINET

84", 86 1/4", 92 1/4" & 98 1/4"
 Diag Corner Larder
 with Wine Rack Cabinet

Assembly Guide

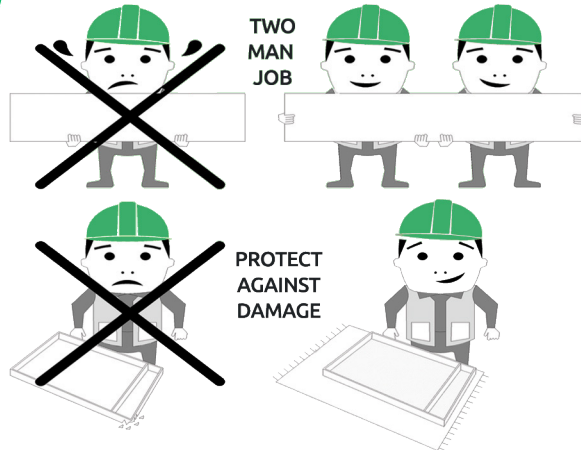

BEFORE YOU START

INSTALLATION SHOULD BE PERFORMED BY A COMPETENT PERSON ONLY.

THIS PRODUCT COULD BE DANGEROUS IF INCORRECTLY INSTALLED

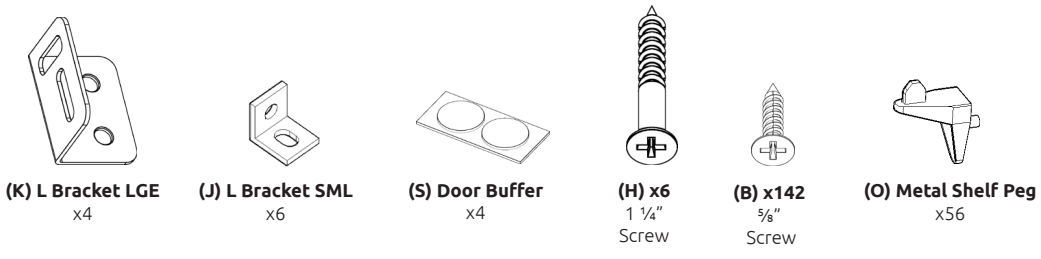
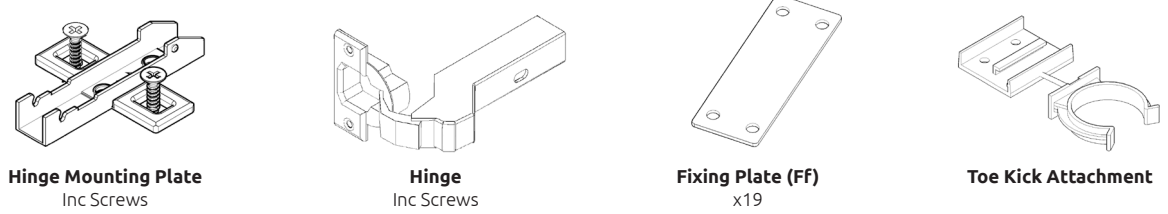
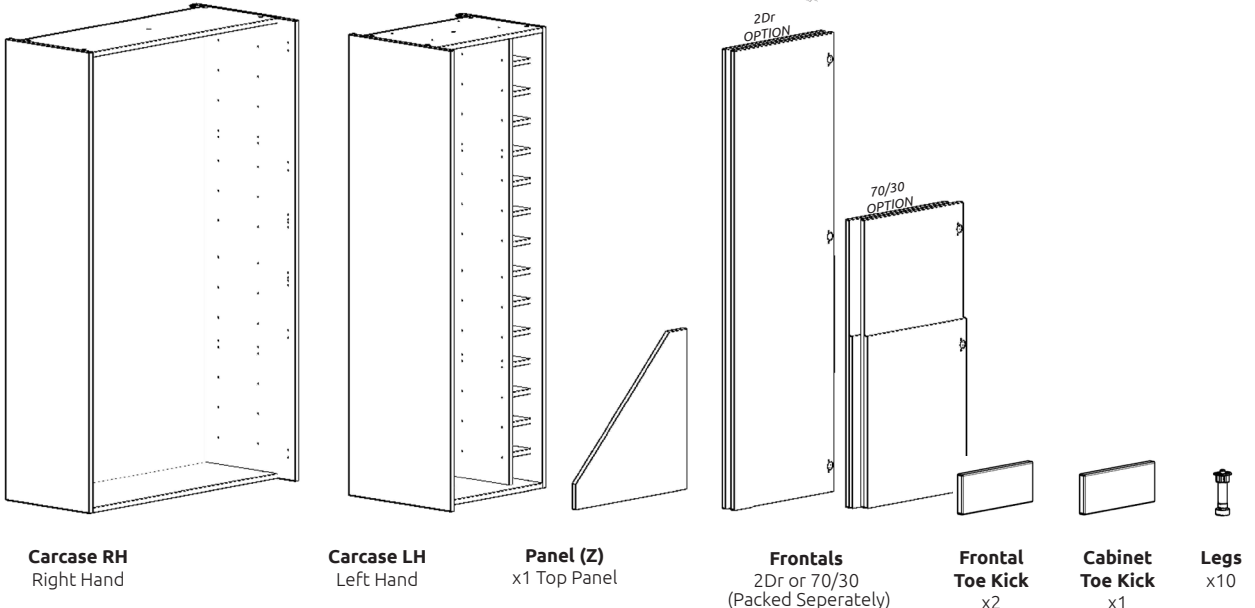

TOWER CABINET

84", 86 1/4", 92 1/4" & 98 1/4"
Diag Corner Larder
with Wine Rack Cabinet

Assembly Guide

Step 1.

Lay both carcasses **LH** & **RH** flat as shown.
Secure 5 x fixing plates (**Ff**) positioned onto
outside face of panel (**Y**) of carcase **RH** equally
spaced using 2 x 5/8" screws (**B**) as shown.

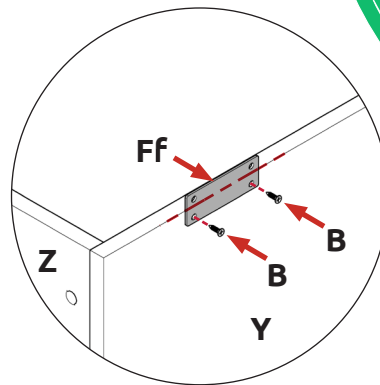

View from above
Carcase **RH**

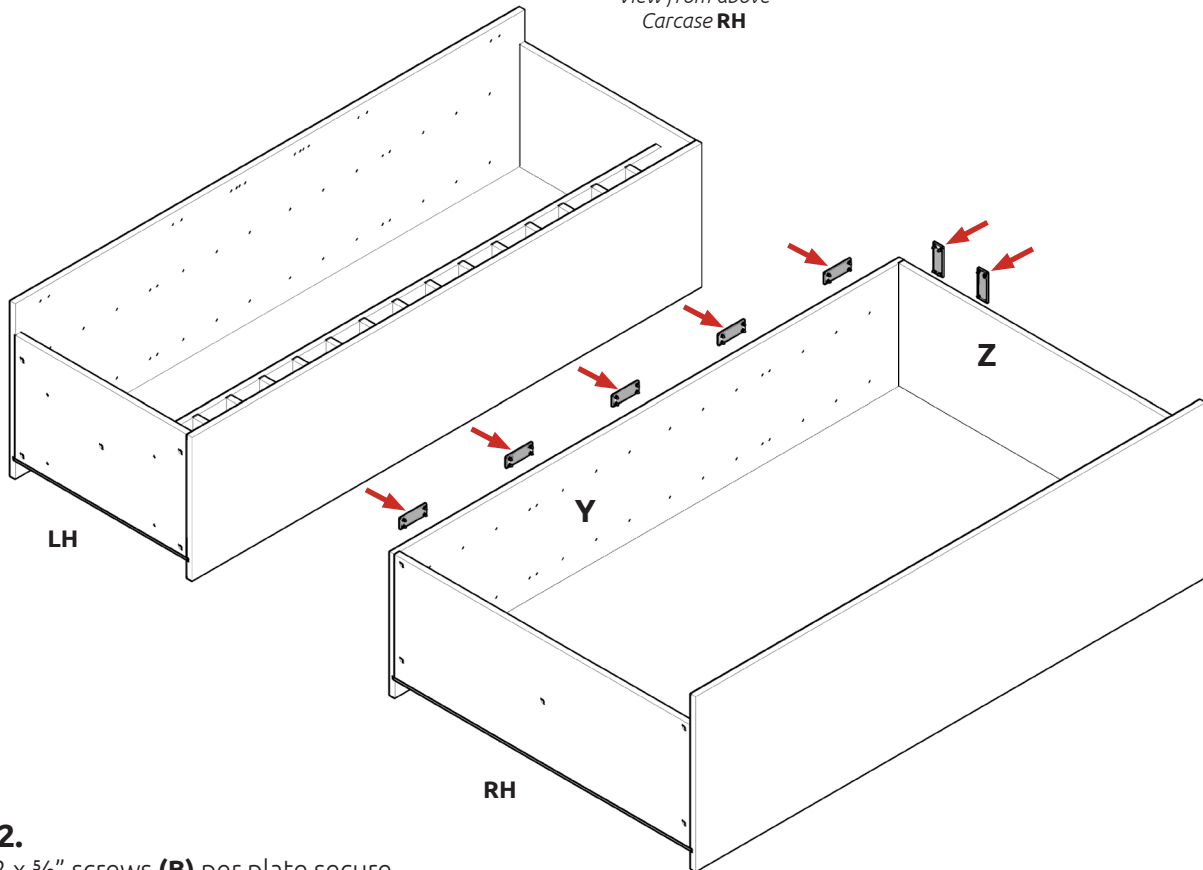

Step 2.

Using 2 x 5/8" screws (**B**) per plate secure
2 x fixing plates (**Ff**) positioned onto
outside face of panel (**Z**) of carcase **RH**
using measurements shown.

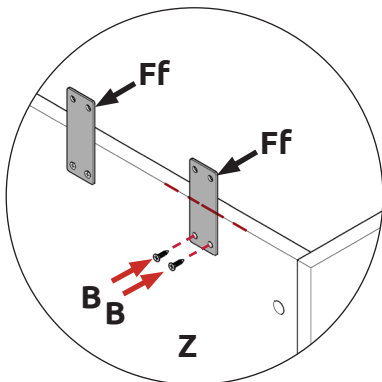

View from above
Carcase **RH**

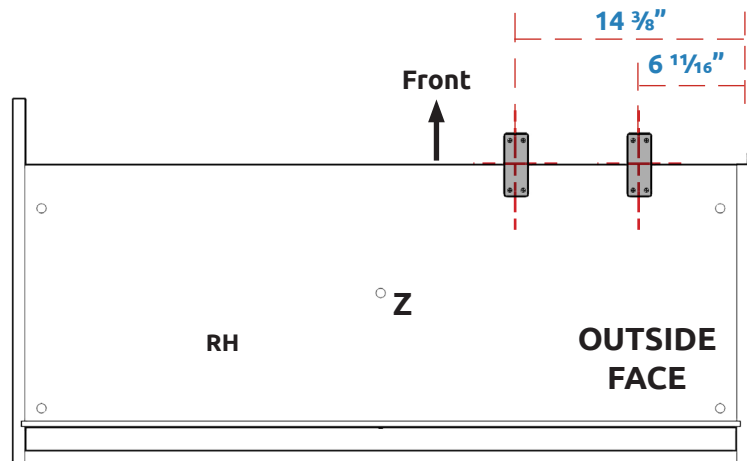

View from Above
Fixing Plate diagram

TOWER CABINET

84", 86 1/4", 92 1/4" & 98 1/4"

Diag Corner Larder
with Wine Rack Cabinet

Assembly Guide

Step 3.

Secure leg base into place with
2 x 5/8" screws (B) per leg as shown.

Ensure legs are rotated to also provide
support to the end panels (Y).

Front legs should have flat edge to the
front.

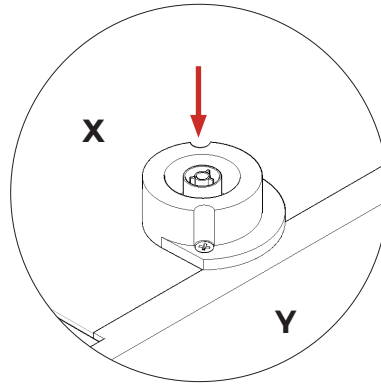
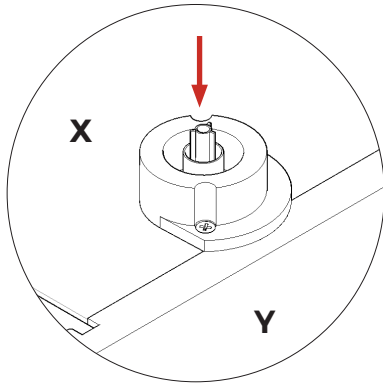
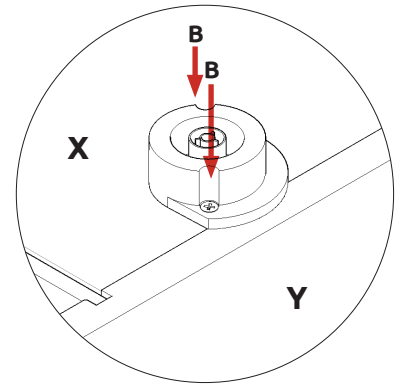

Step 4.

Lightly hit centre peg of leg
bases with hammer until flush.

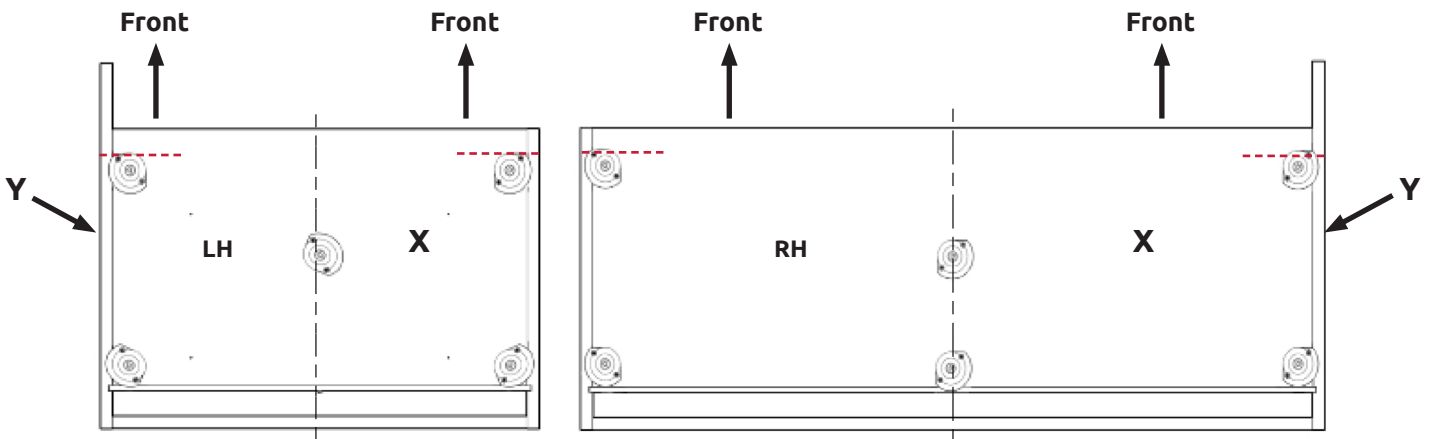

View From Underside

Leg position diagram

Step 5.

Push leg firmly down into leg base.
Adjust legs to 4 1/2" before turning both carcasses upright.
Once in situ level accordingly.

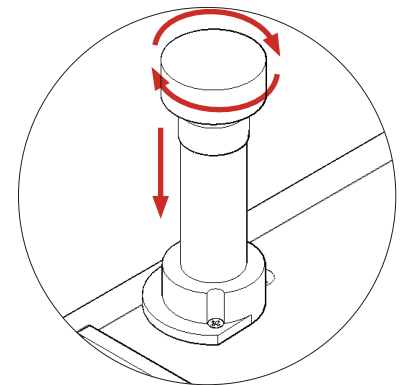

It is **important** to lift cabinet onto its legs.
Do not tilt as depicted in image.

TOWER CABINET

84", 86 1/4", 92 1/4" & 98 1/4"
Diag Corner Larder
with Wine Rack Cabinet

Assembly Guide

Step 6.

Position carcass **LH** and carcass **RH** together as shown.

Ensure carcasses are flush & square.

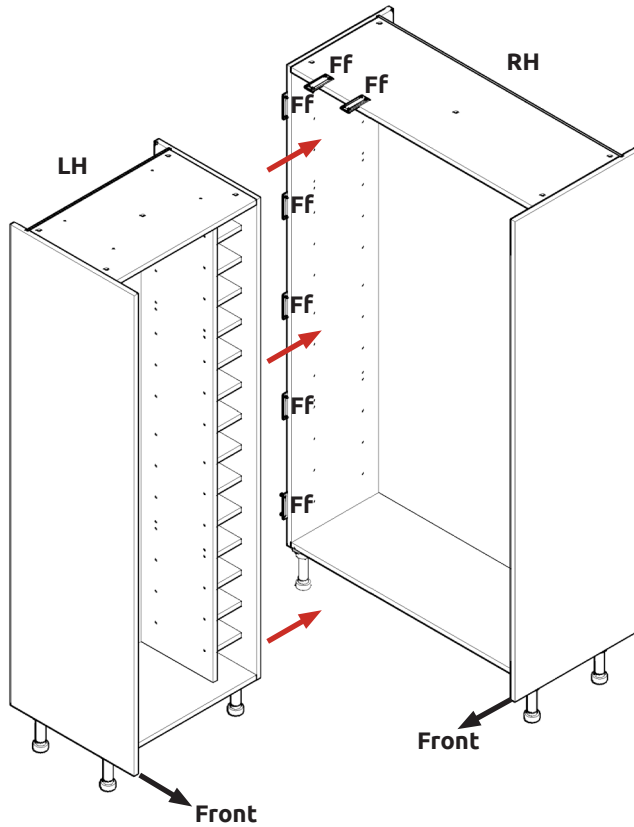

Step 7.

Screw through fixing plates (**Ff**) into adjoining carcass **LH** using 2 x 5/8" screws (**B**) per plate to secure both carcasses together. Repeat per fixing plate (**Ff**).

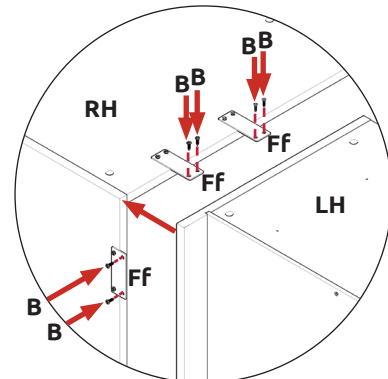

View from rear of cabinet

Step 8.

Align 2 x L bracket SML (**J**) combined with 2 x 5/8" screws (**B**) per bracket as shown. Secure carcass from inside the cabinet as shown.

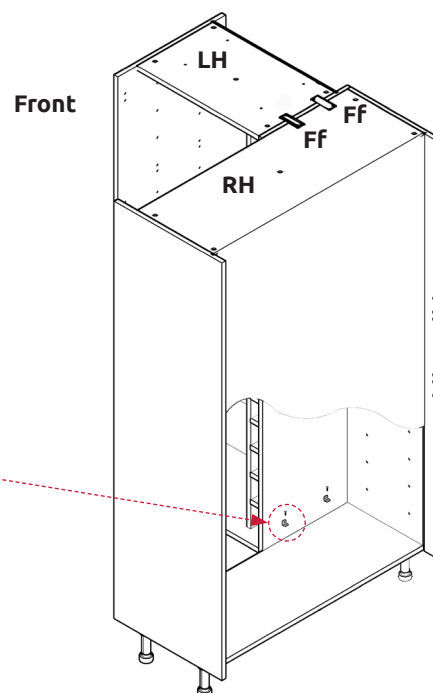
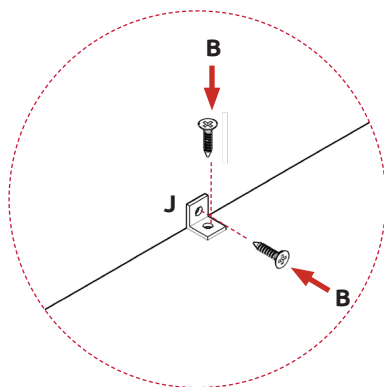

TOWER CABINET

84", 86 1/4", 92 1/4" & 98 1/4"
Diag Corner Larder
with Wine Rack Cabinet

Assembly Guide

Step 9.

Use 2 x 5/8" screws (**B**) to secure each of the
4 x L brackets LGE (**K**) to both carcasses positioned as shown.

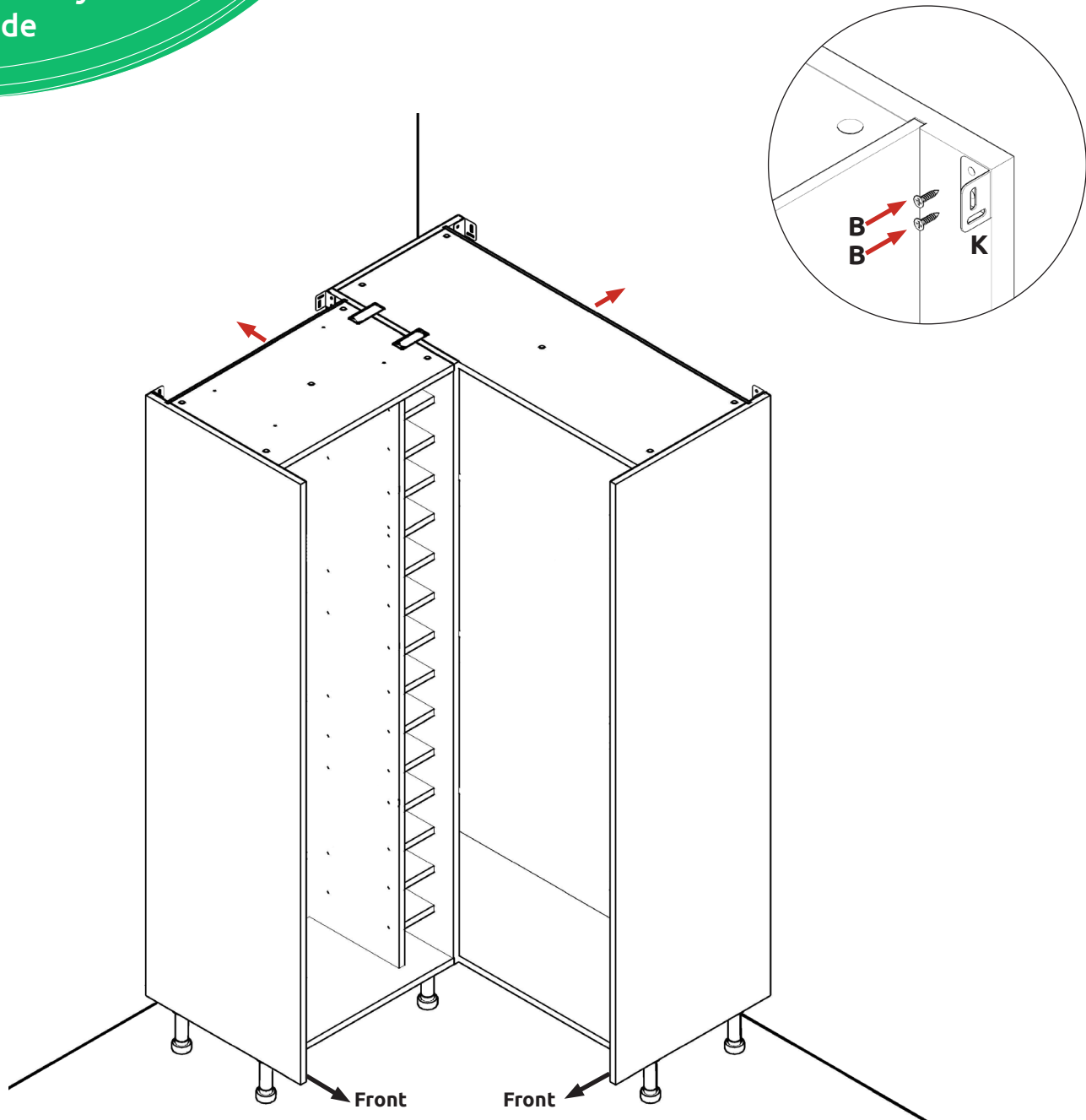

Step 10.

Screw through into the wall as shown.

**Screws for fixing to walls are not provided as these vary
depending on your wall material and construction.
Ensure appropriate fixings for wall constructions are used.**

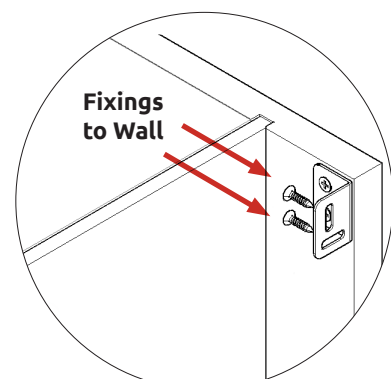

Step 11.

When cabinet is combined and secured in position, attach top Panel (Z), using 4 x fixing plates (FF) combined with 4 x 5/8" screws (B) per plate, positioned as shown.

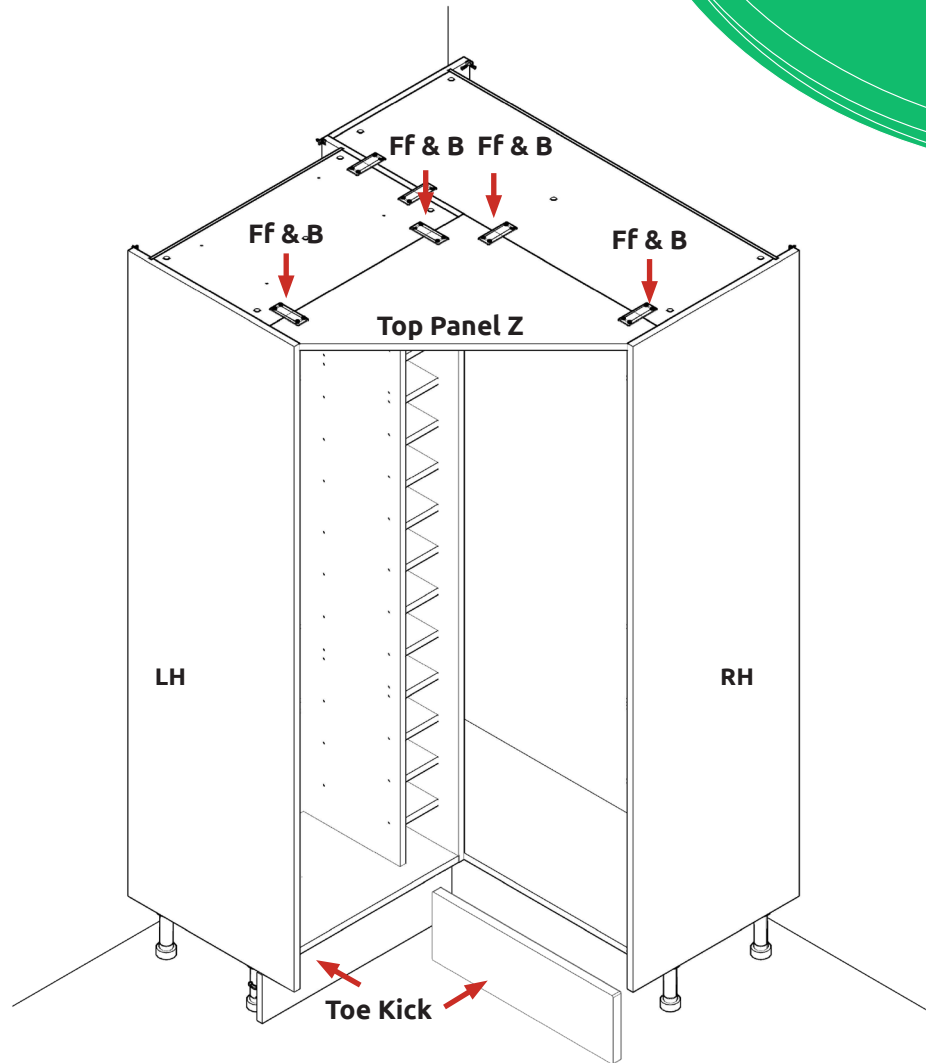

Step 12.

Measure toe kick and cut to suit the width of carcass (LH) and again for (RH). Mark clip positions by aligning toe kick sections to legs. Use 2 x 5/8" screws (B) as shown to fix clip to toe kick. Detach the leg clip from the toe kick clip. Slide leg clip into toe kick clip as shown.

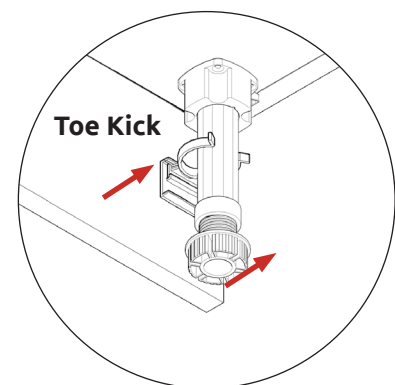
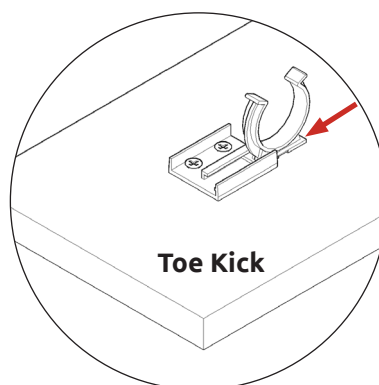
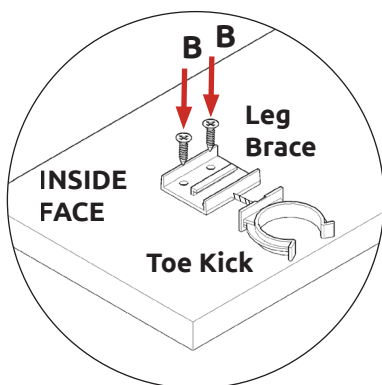

Step 13.

Secure toe kick by pushing clip firmly onto legs, as shown.

TOWER CABINET

84", 86 1/4", 92 1/4" & 98 1/4"
 Diag Corner Larder
 with Wine Rack Cabinet

Assembly Guide

Step 14.

Attach hinge plates onto end panels (Y) to suit as shown using 2 x 5/8" screws (B) included per plate.

Hinge side to be mounted in accordance to customer specific kitchen plan.

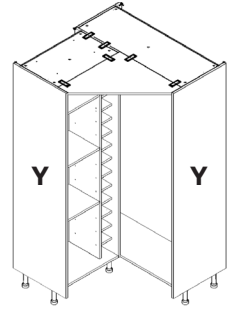

84" 70/30 HINGE POSITION

84" 2 Door HINGE POSITION

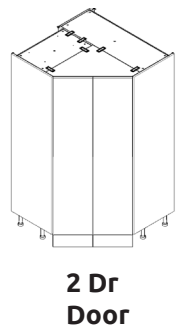
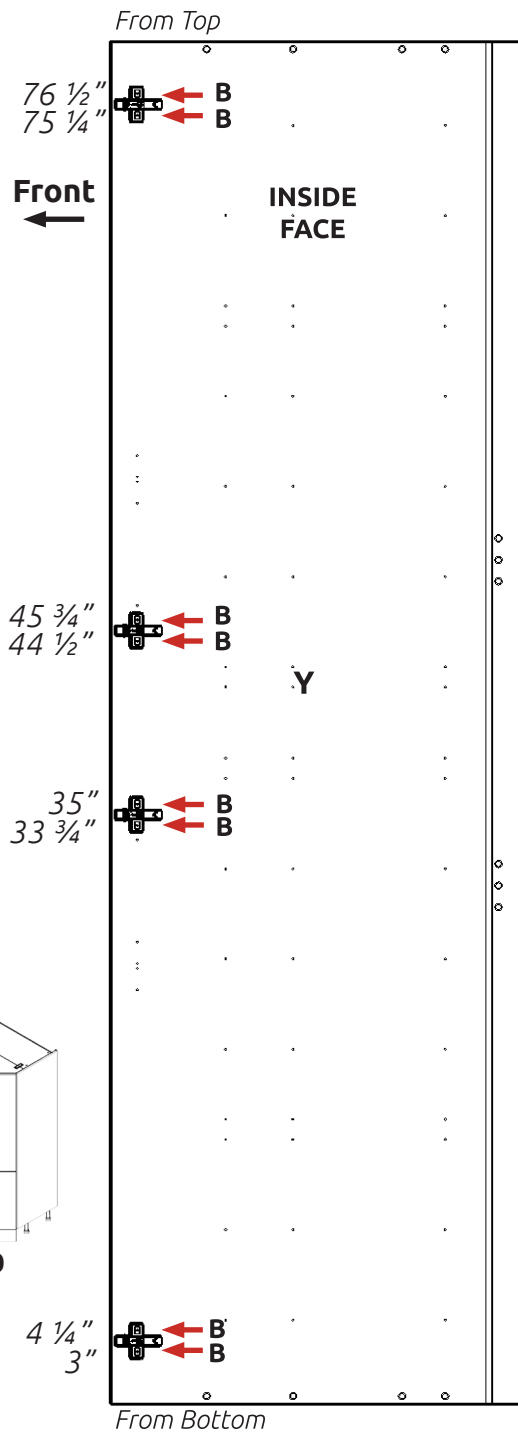
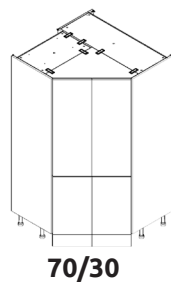
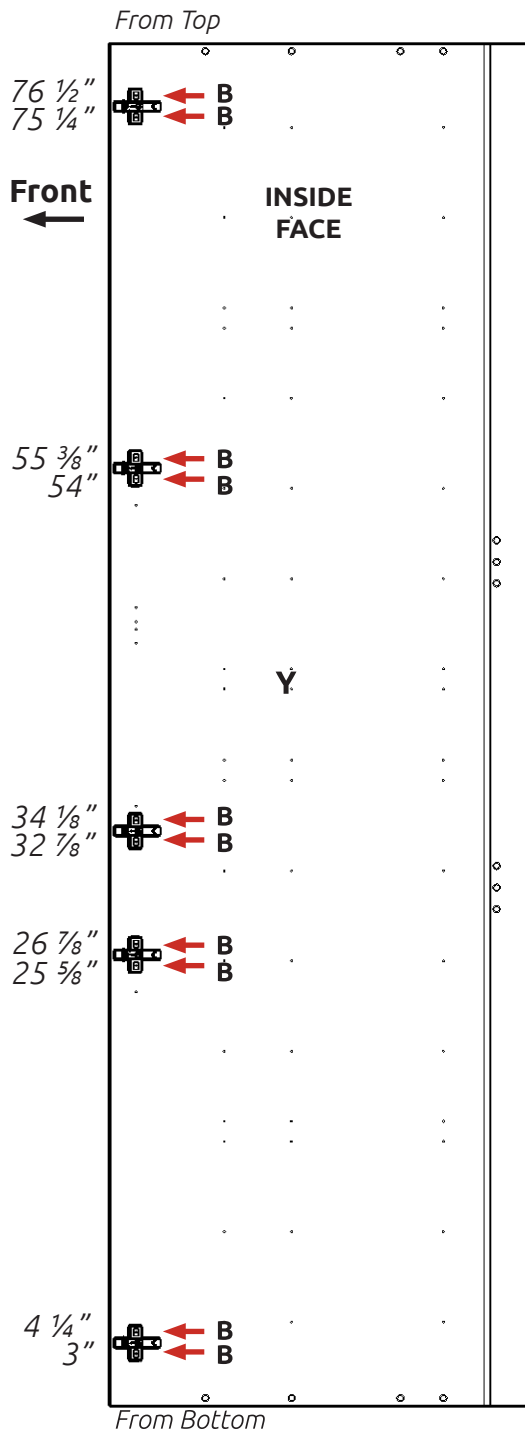

TOWER CABINET

84", 86 1/4", 92 1/4" & 98 1/4"
 Diag Corner Larder
 with Wine Rack Cabinet

Assembly Guide

Step 14.

Attach hinge plates onto end panels (Y) to suit as shown using 2 x 5/8" screws (B) included per plate.

Hinge side to be mounted in accordance to customer specific kitchen plan.

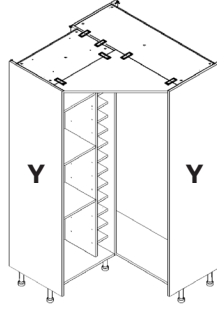

86 1/4" 70/30 HINGE POSITION

86 1/4" 70/30 HINGE POSITION

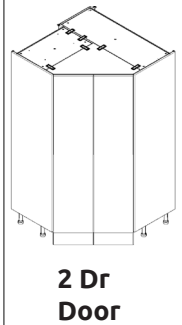
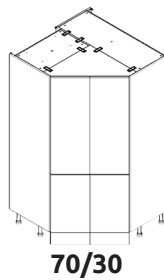
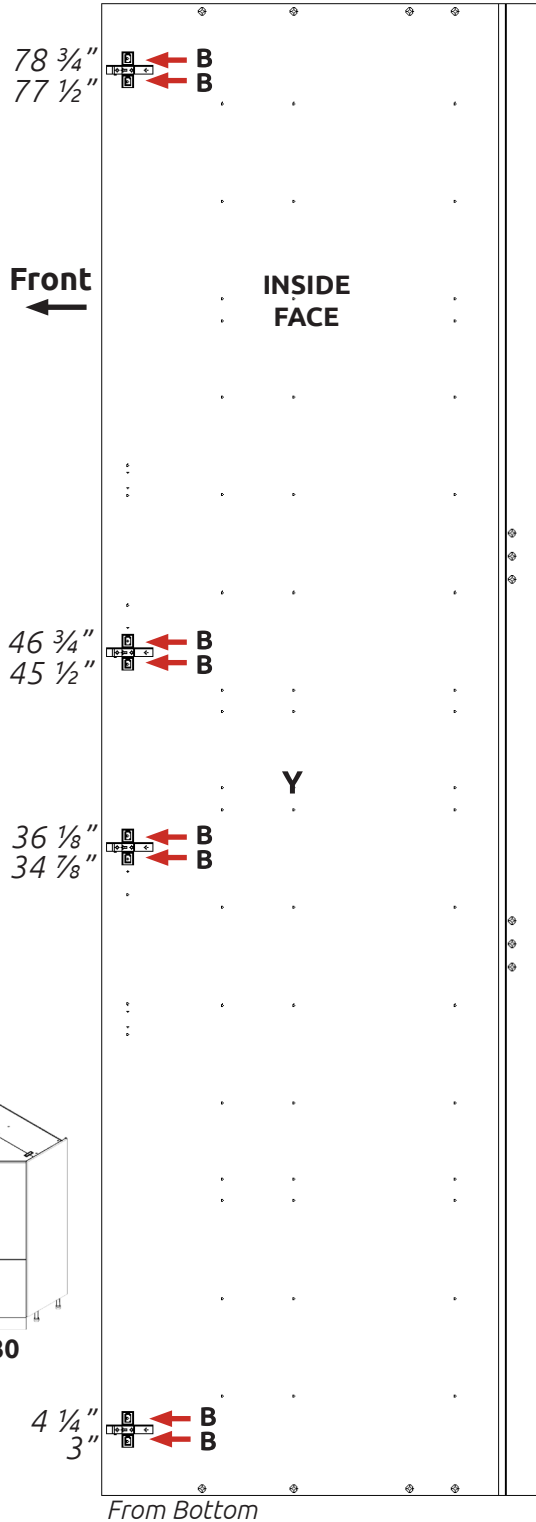
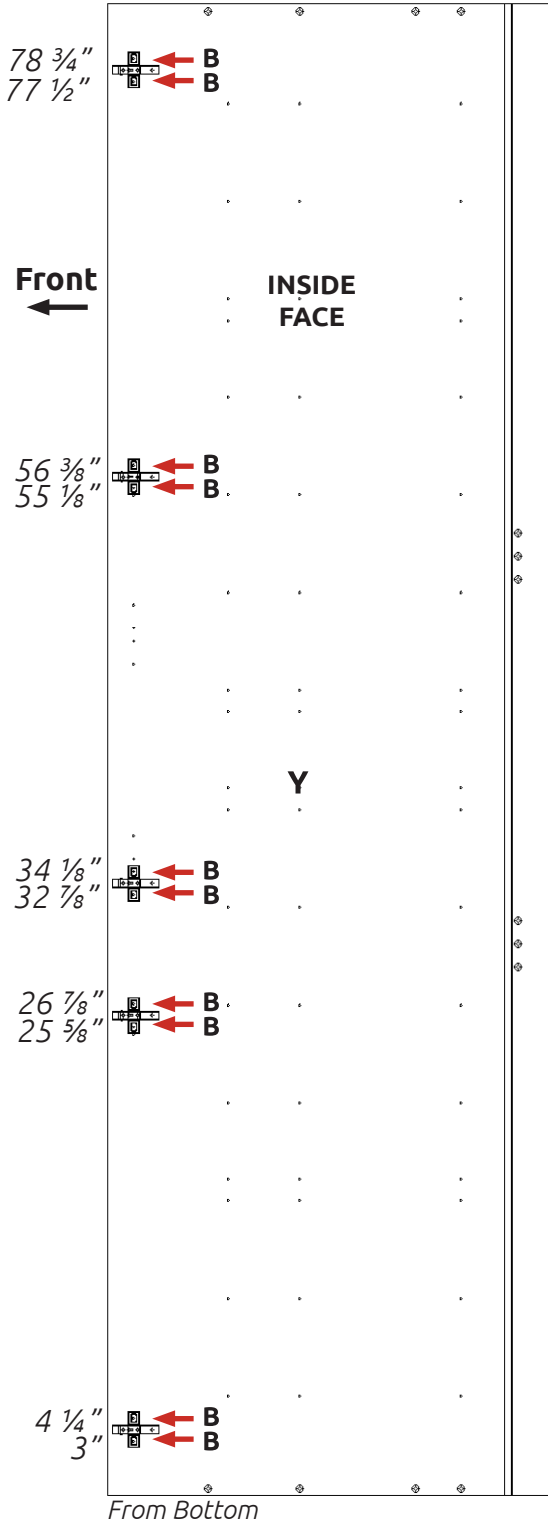

TOWER CABINET

84", 86 1/4", 92 1/4" & 98 1/4"
 Diag Corner Larder
 with Wine Rack Cabinet

Assembly Guide

Step 14.

Attach hinge plates onto end panels (**Y**) to suit as shown using 2 x 5/8" screws (**B**) included per plate.

Hinge side to be mounted in accordance to customer specific kitchen plan.

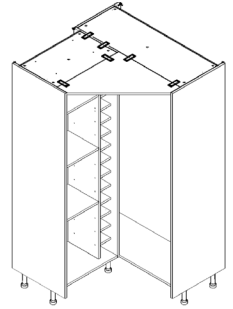

92 1/4"
70/30
HINGE
POSITION

92 1/4"
2 Door
HINGE
POSITION

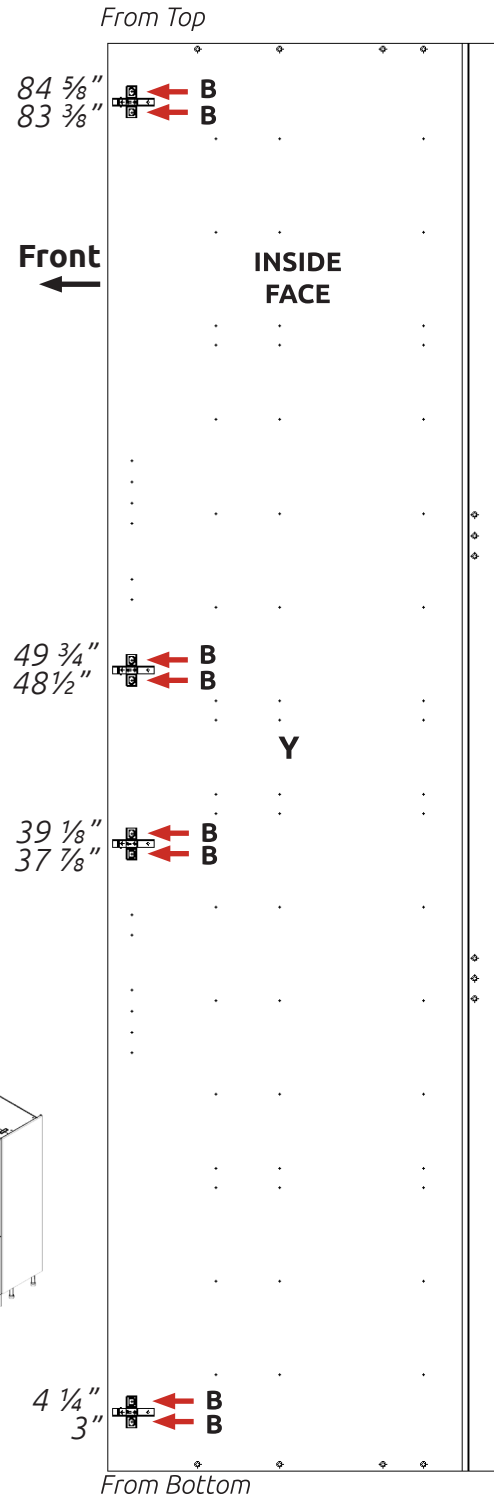
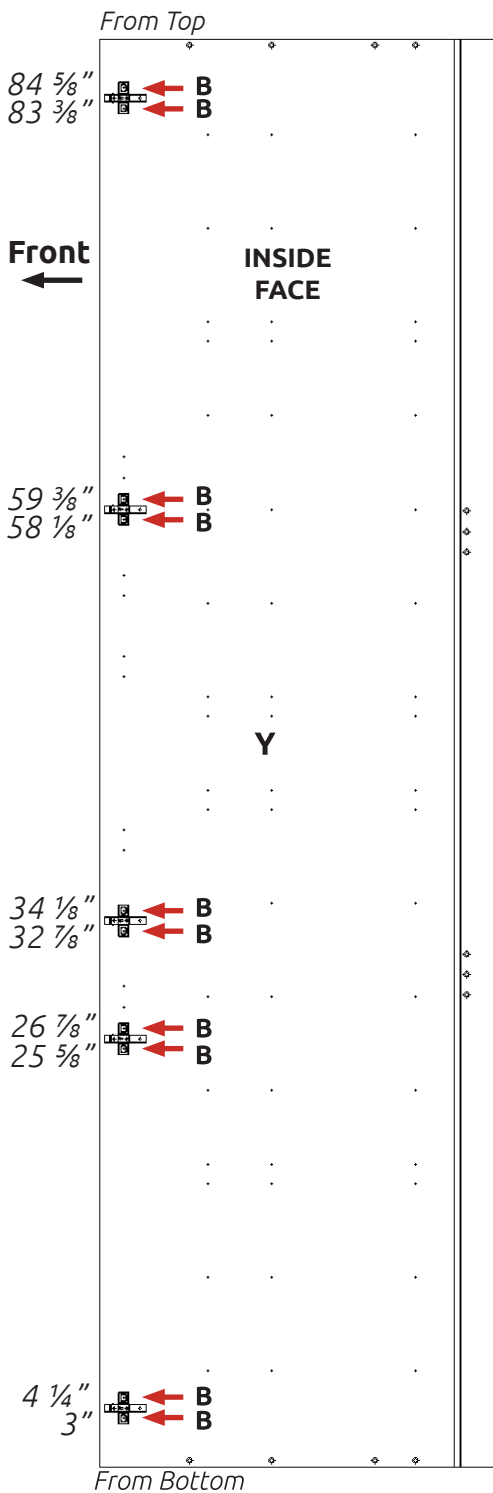

TOWER CABINET

84", 86 1/4", 92 1/4" & 98 1/4"
 Diag Corner Larder
 with Wine Rack Cabinet

Assembly Guide

Step 14.

Attach hinge plates onto end panels (**Y**) to suit as shown using 2 x 5/8" screws (**B**) included per plate.

Hinge side to be mounted in accordance to customer specific kitchen plan.

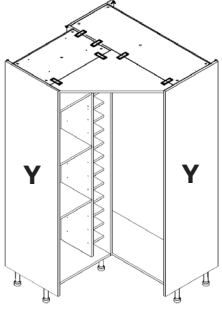

98 1/4"
 70/30
 HINGE
 POSITION

98 1/4"
 2 Door
 HINGE
 POSITION

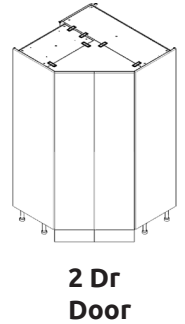
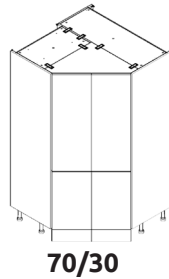
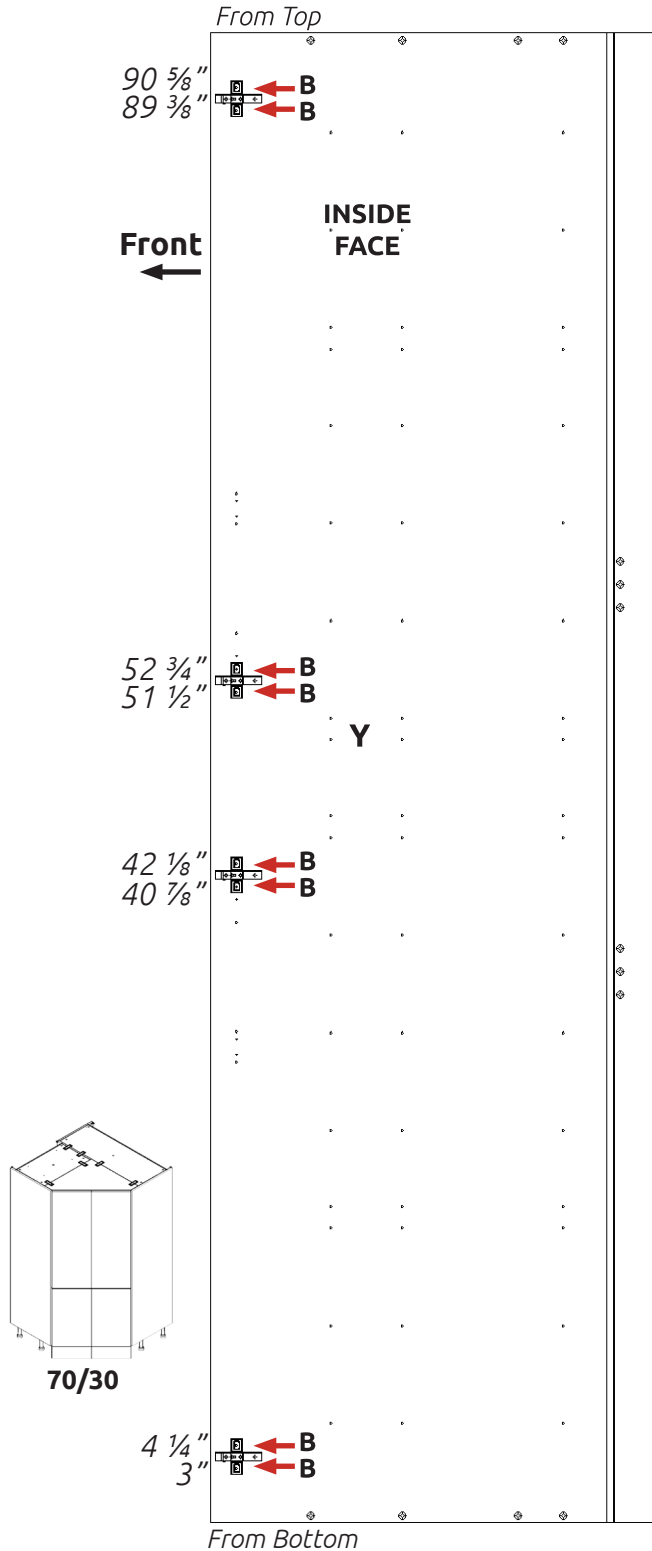
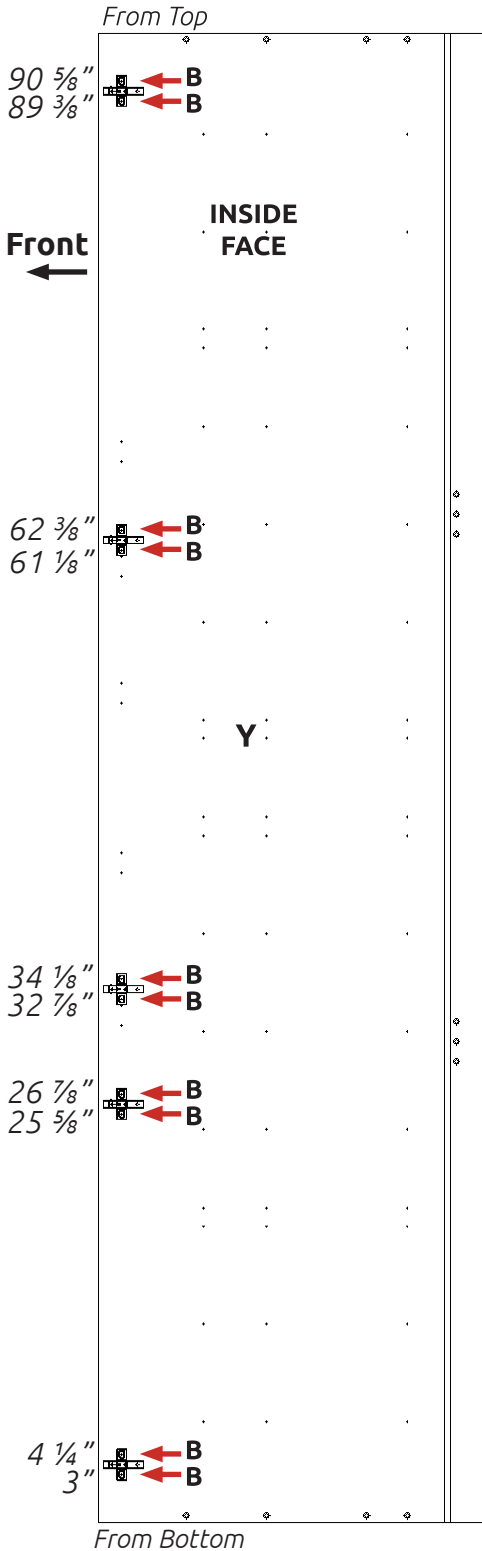

TOWER CABINET

84", 86 1/4", 92 1/4" & 98 1/4"
 Diag Corner Larder
 with Wine Rack Cabinet

Assembly Guide

Step 17.

Secure hinges by tightening 2 x screws with hinge dowels attached. These are already positioned within the hinges.

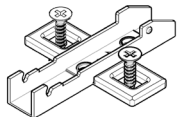
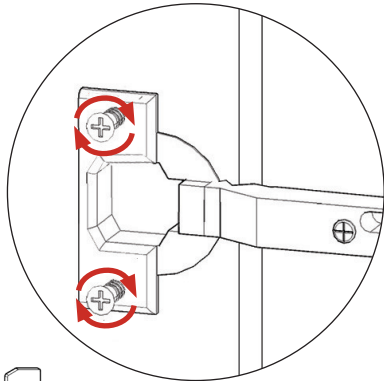

Hinge Plates

Step 18.

Adjust hinge to suit. As shown below.

FRONTAL HINGE ADJUSTMENT

To **adjust** hinge using a screw driver, tighten or loosen as required at points **1** & **2**.
 Point **1** - In - Out
 Point **2** - Left - Right

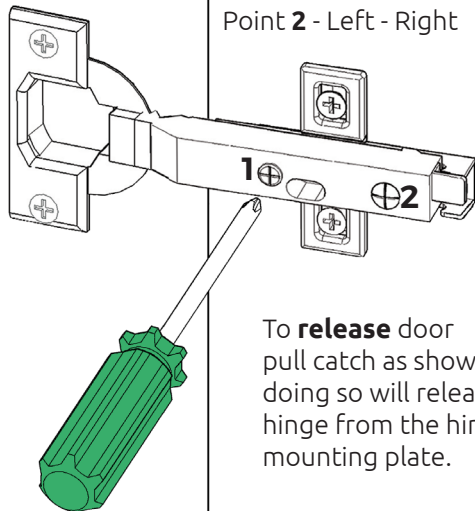

To **release** door pull catch as shown, doing so will release the hinge from the hinge mounting plate.

View from Inside of Carcase

See Customer Specific Kitchen Plan For Tower Frontals

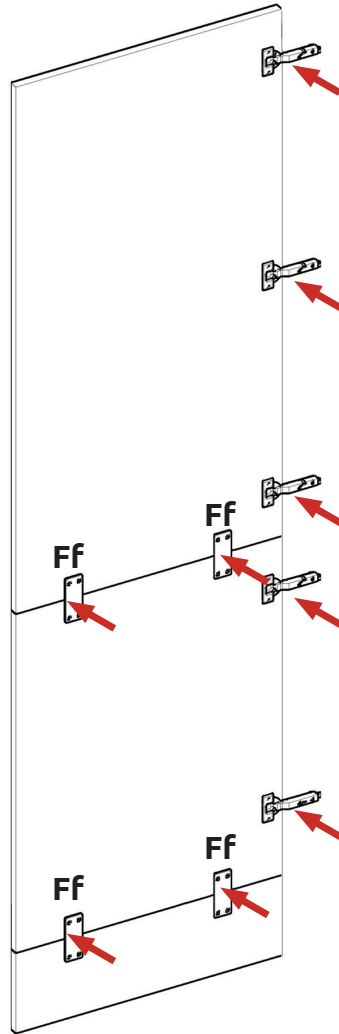

Step 15.

Insert hinge where required in holes as shown.

Step 16.

Align doors & frontal toe kick to join together using 4 x fixing plates (**FF**) to the back of both frontals. Ensure a 1/8" gap is maintained between each frontal once fixed together. Screw in place using 4 x 5/8" screws (**B**) per fixing plate.

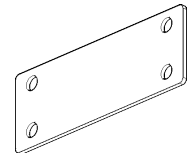

Fixing plates

Step 19.

Fit cover caps to hinge. Adjust soft-close to suit.

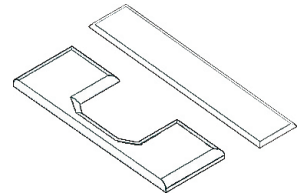

Hinge Cover Caps

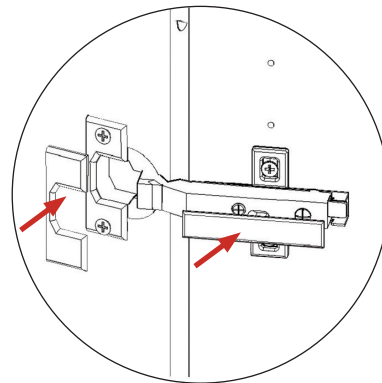

The Top and Bottom hinges **MUST** be adjusted to the **SAME STRENGTH**.

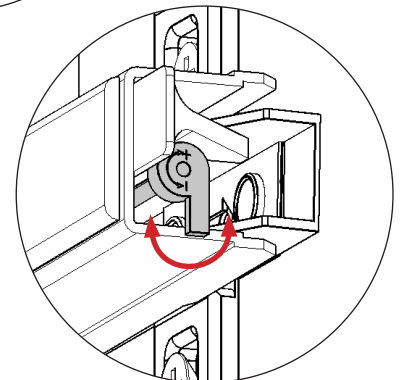

Soft-Close adjustment