

STACKED TRAD/CLASSIC CROWN MOLDING

FITTING GUIDE

Traditional / Classic
Crown Molding

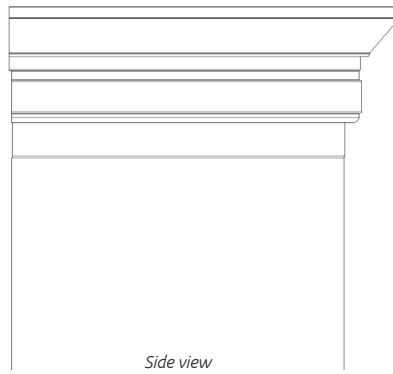

Cabinet shown for illustration
purposes only.

Stepped Traditional / Classic
Crown Molding

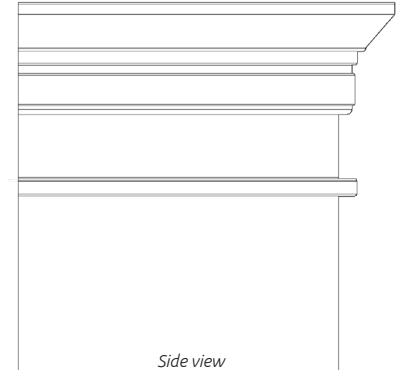

Cabinet shown for illustration
purposes only.

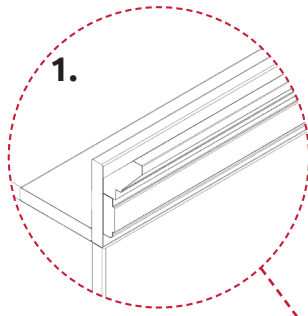

1.

Straight Cut

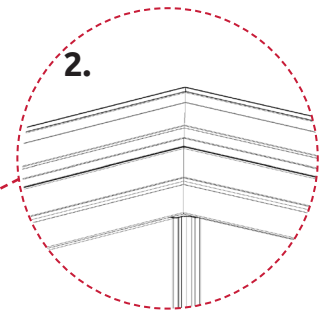

2.

Internal Mitre

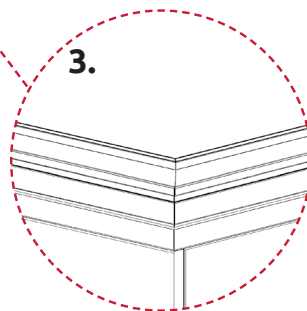
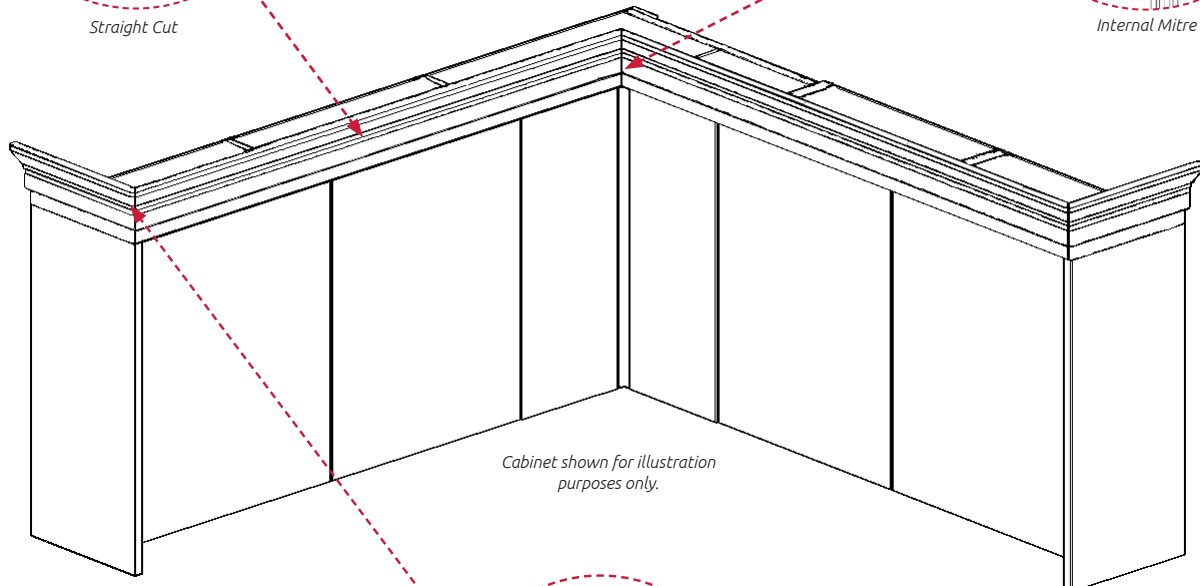

3.

External Mitre

Contents:

Traditional / Classic Crown Molding

1. Straight cut - Pages 1-4
2. External mitre joint - Pages 5-8
3. Internal mitre joint - Page 9-11

4. Final Fit - Page 22

Stepped Traditional / Classic Crown Molding

1. Straight cut - Pages 12- 14
2. External mitre joint - Pages 15-18
3. Internal mitre joint - Page 19-21



STACKED TRAD/CLASSIC CROWN MOLDING

FITTING GUIDE

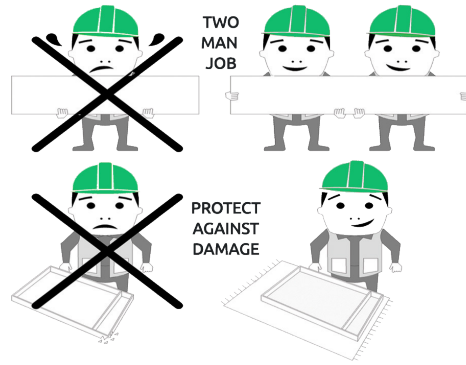

BEFORE YOU START

INSTALLATION SHOULD BE PERFORMED BY A COMPETENT PERSON ONLY.

THIS PRODUCT COULD BE DANGEROUS IF INCORRECTLY INSTALLED

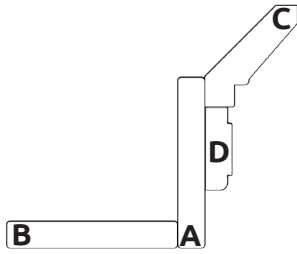

Throughout the following installation guide the parts that make up this stacked traditional/classic crown molding will be labelled as per the illustration on the left. **Please note part D is applicable on the classic crown molding only.**



Please note the stacked traditional/classic crown molding should be fully assembled at ground level then lifted into position.

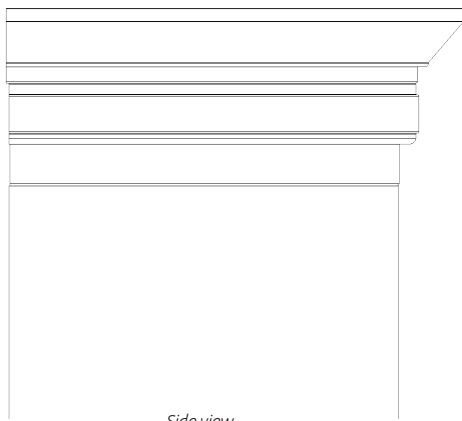

Side view
Cabinet shown for illustration purposes only.

Traditional / Classic Crown Molding Pages 1 - 11



Please note that the stacked traditional/classic crown molding has a minimum and maximum height limitation as below.

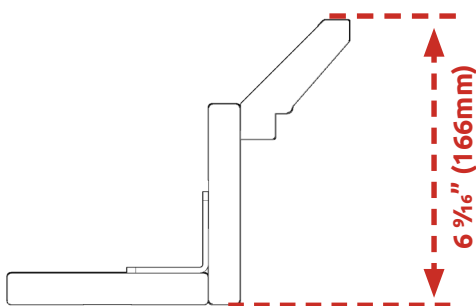

Traditional Crown Maximum height

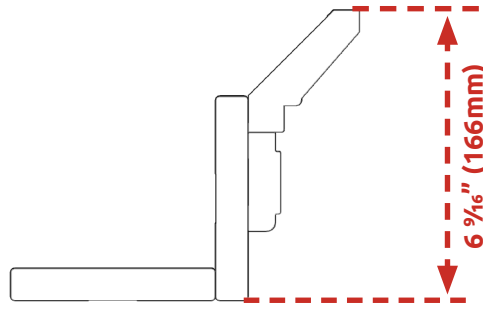

Classic Crown Maximum height

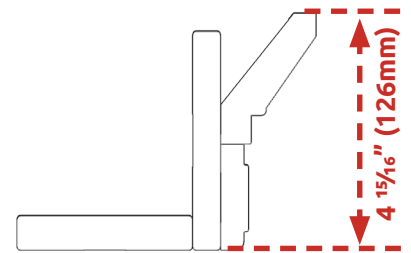

Classic Crown Minimum height

Straight Length

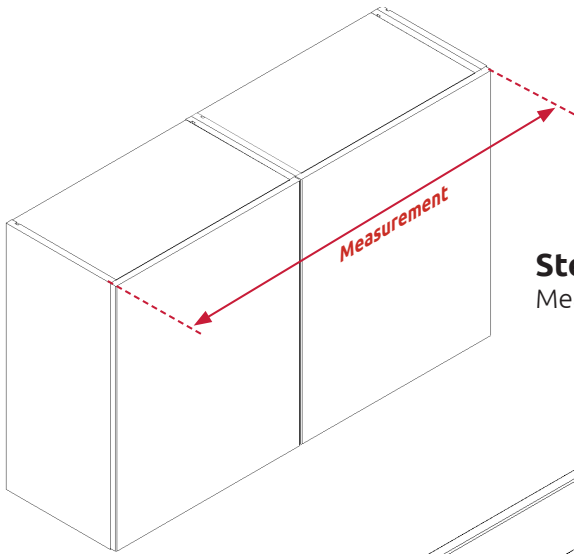

Step 1.

Measure the distance from each end of the wall cabinets.

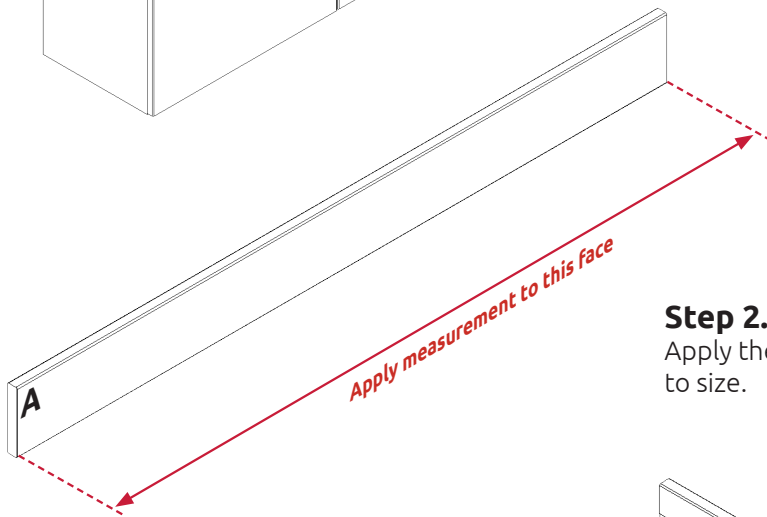

Step 2.

Apply the measurement to part A and cut to size.

Step 3.

Measure the inside face of part A.

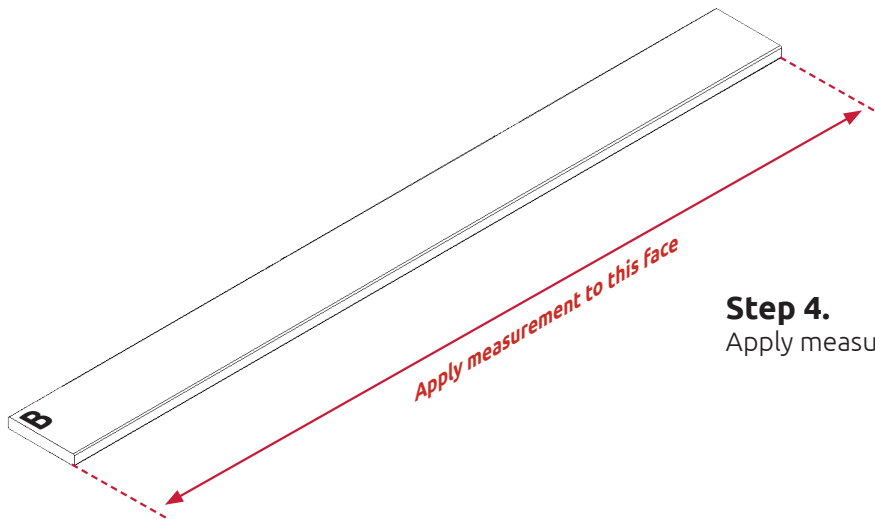
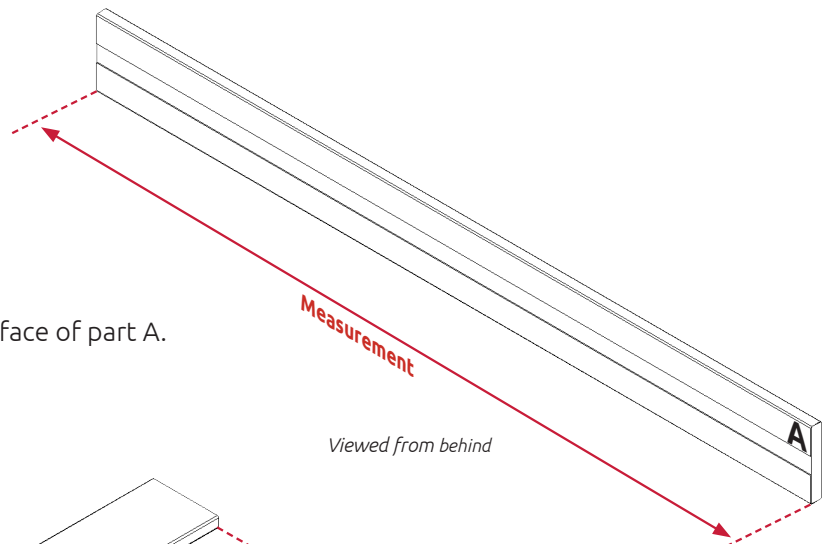

Step 4.

Apply measurement to the front edge of part B.

STACKED TRAD/CLASSIC CROWN MOLDING

FITTING GUIDE

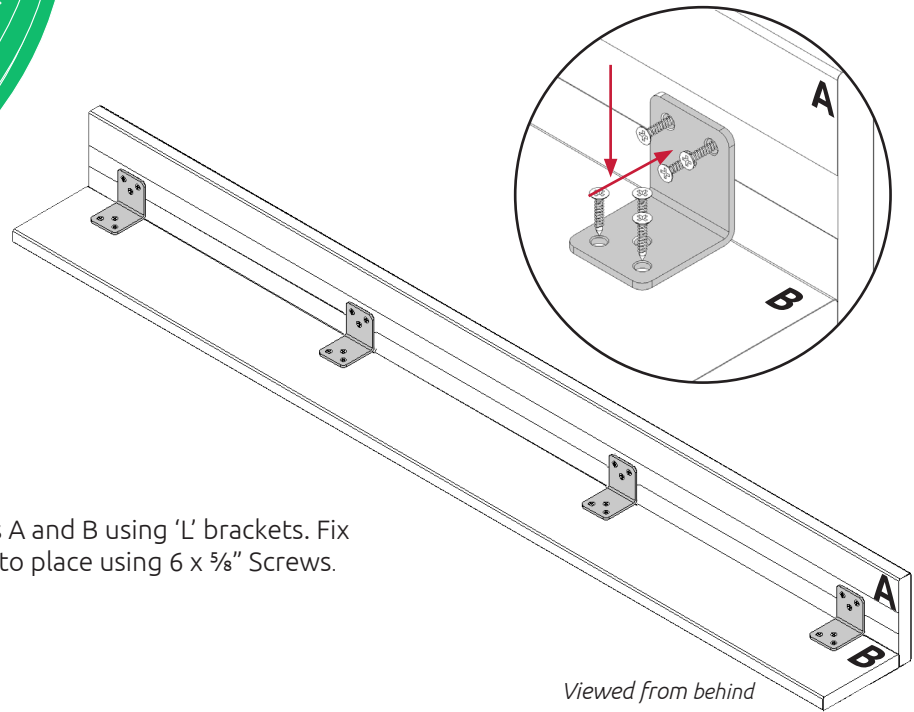

Step 5.

Fix together parts A and B using 'L' brackets. Fix each 'L' Bracket into place using 6 x 5/8" Screws.

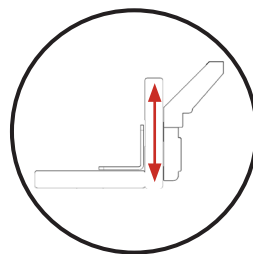
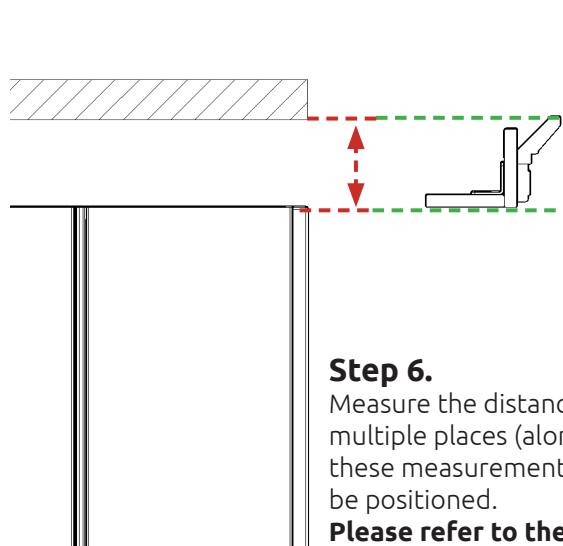

Stacked crown molding is adjustable along the toe kick upright

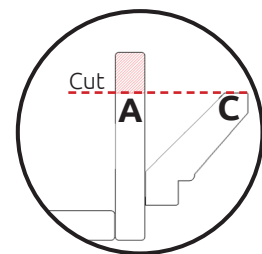

Please note: if part C sits lower than part A then part A should be cut down to size.

Step 6.

Measure the distance from the top of cabinet to the ceiling in multiple places (along the full run of cabinets). Take the lowest of these measurements to obtain where the stacked crown molding will be positioned.

Please refer to the minimum and maximum positions on page 1

Step 7.

Measure the outside face of part A.

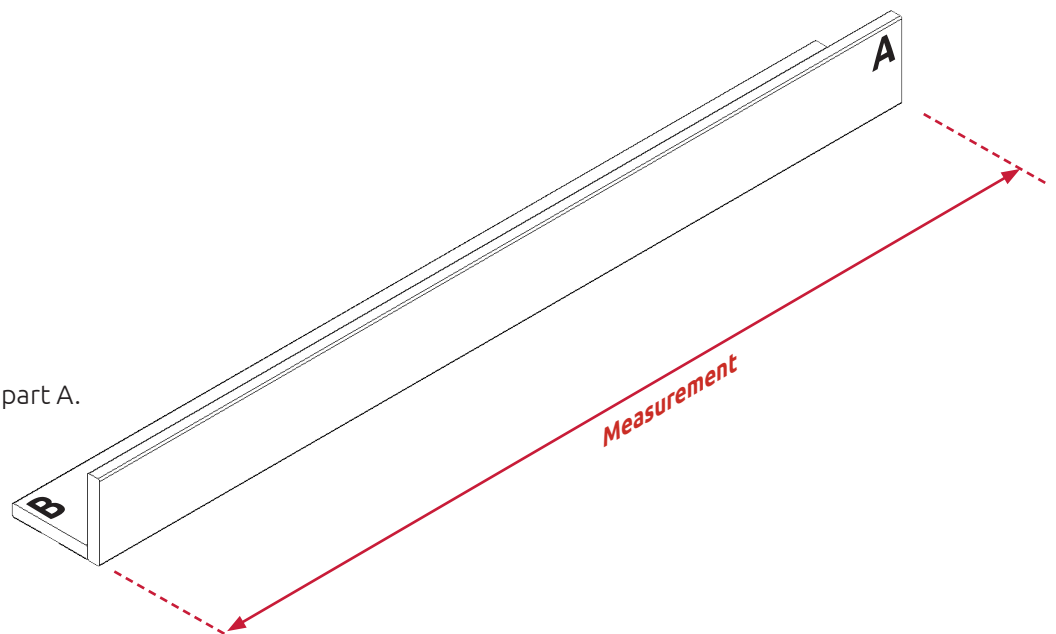

Step 8.

Apply measurement to the inside face of part C and cut to size.

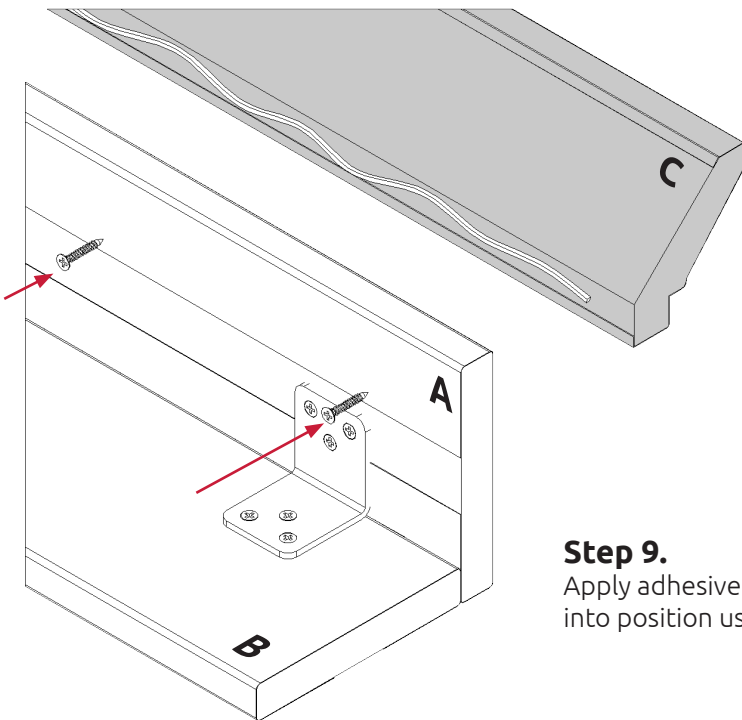
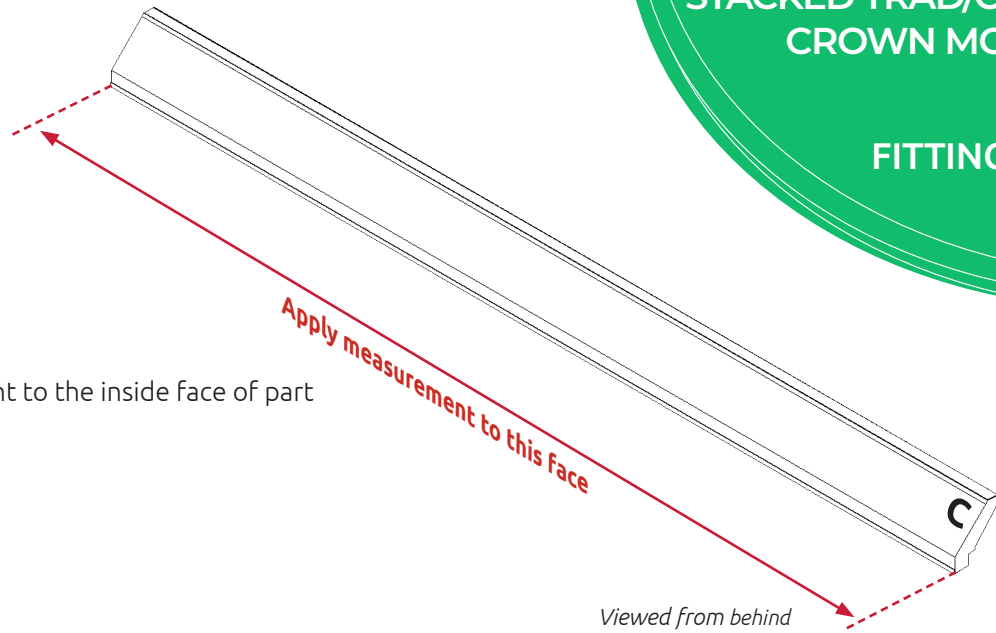

Step 9.

Apply adhesive to the back of part C. Fix part C into position using 1 1/4" screws.

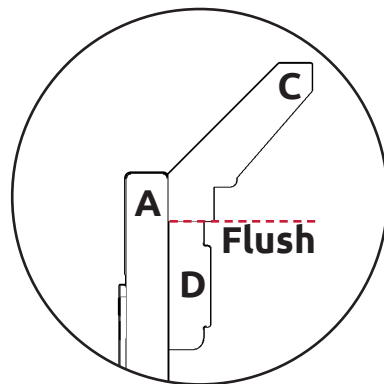
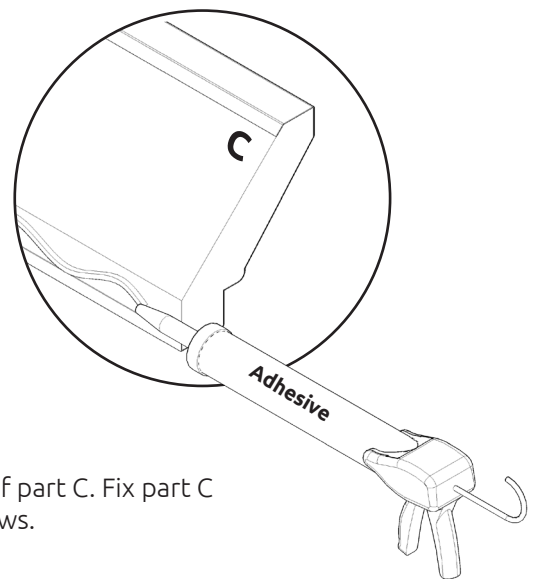

Step 10.

If using the classic traditional crown molding repeat steps 7-9. Make sure the top face of part D is touching the bottom face of part C.

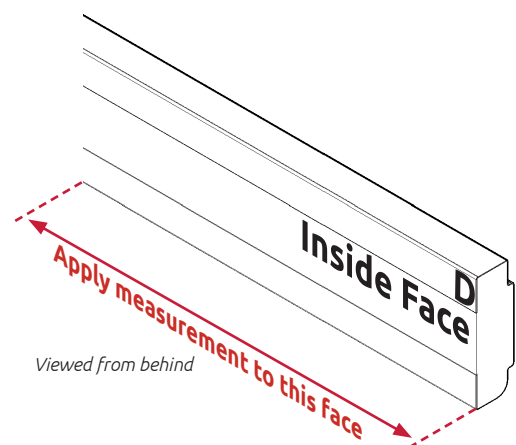

External Mitre Joint

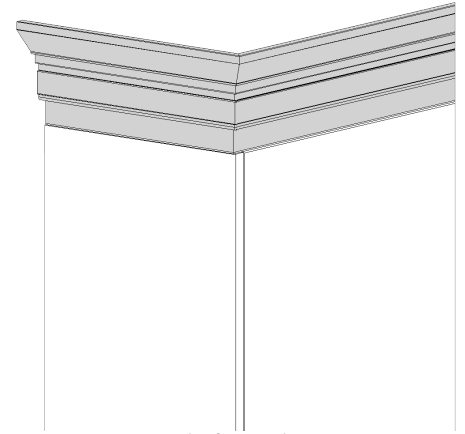

*Example of external mitre joint.
cabinet shown for illustration purposes only.*

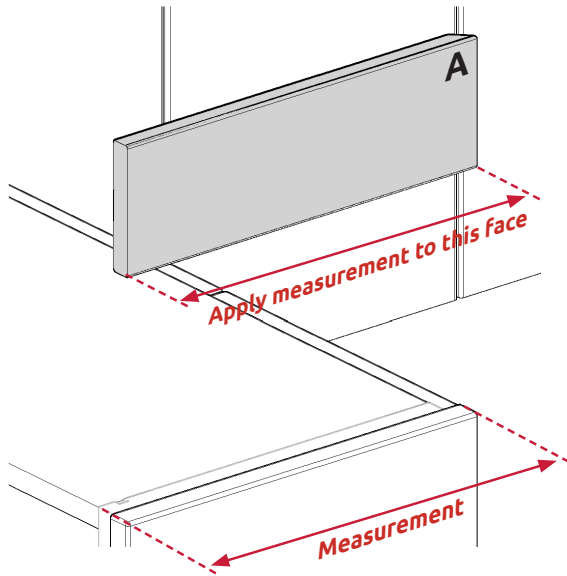

Step 11.

Measure the distance from the wall to the front face of the decor end.

Step 12.

Apply the measurement to part A and cut to size. Mitre cut the front edge (that will line up with the doors) at a 45° angle.

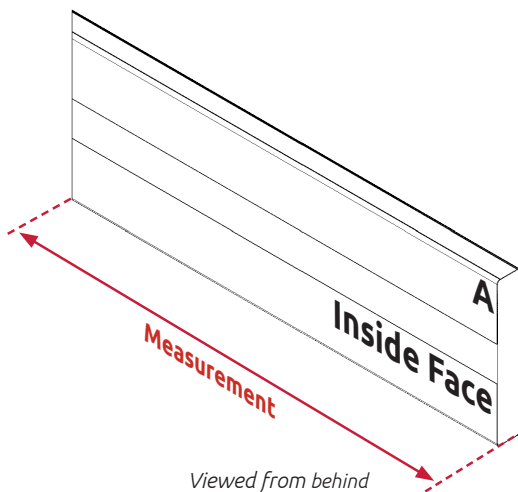
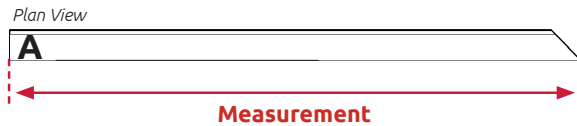

Step 13.

Measure the inside face of part A (from the wall to the internal mitre).

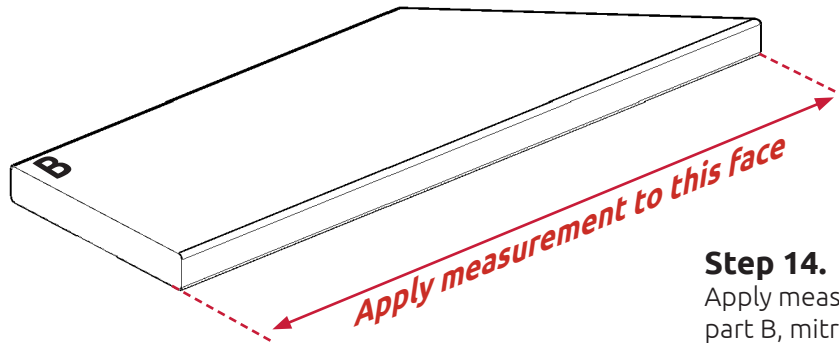

Step 14.

Apply measurement to the front edge of part B, mitre at a 45° angle.

Step 15.

Fix together parts A and B using 'L' brackets. Fix each 'L' Bracket into place using 6 x 5/8" Screws.

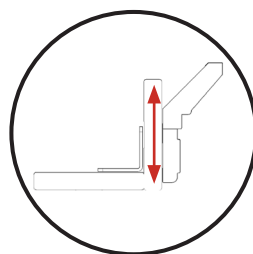
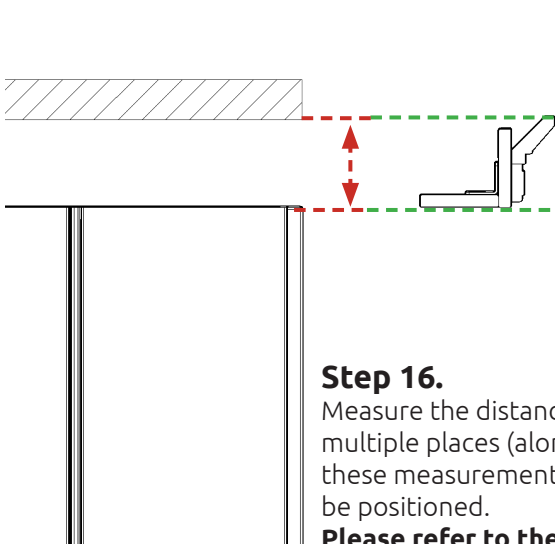
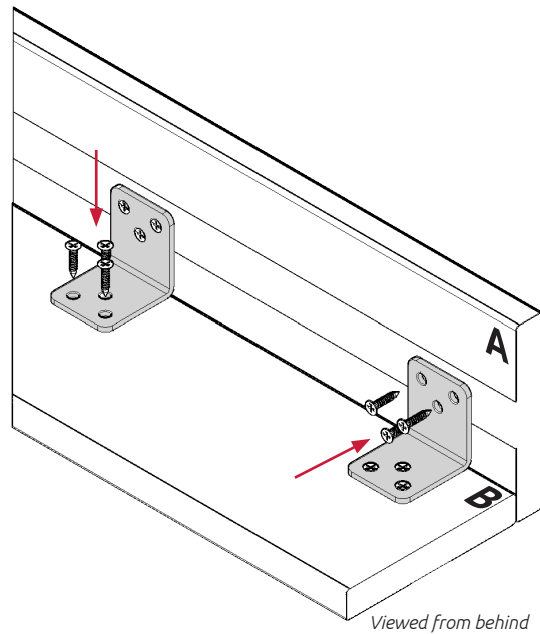

Stacked crown molding is adjustable along the part A upright

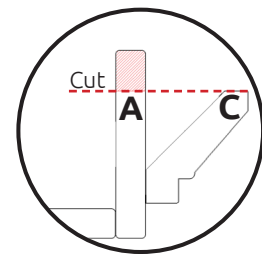

Please note: if part C sits lower than part A then part A should be cut down to size.



Step 16.

Measure the distance from the top of cabinet to the ceiling in multiple places (along the full run of cabinets). Take the lowest of these measurements to obtain where the stacked crown molding will be positioned.

Please refer to the minimum and maximum positions on page 1

STACKED TRAD/CLASSIC CROWN MOLDING

FITTING GUIDE

Step 17.

Measure the outside face of part A.

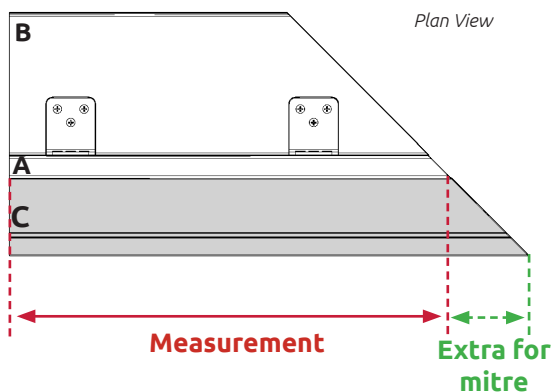
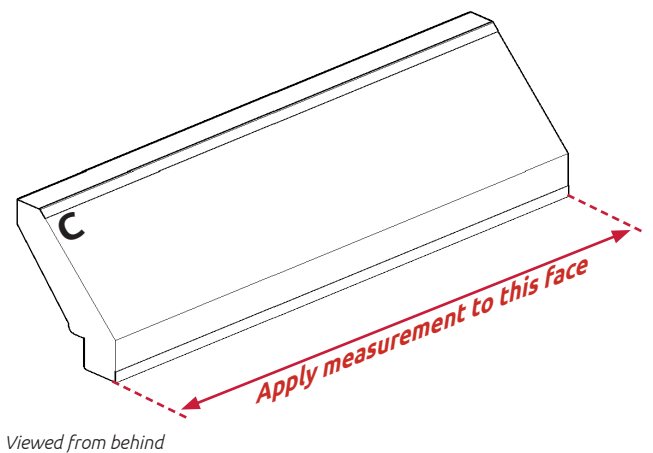
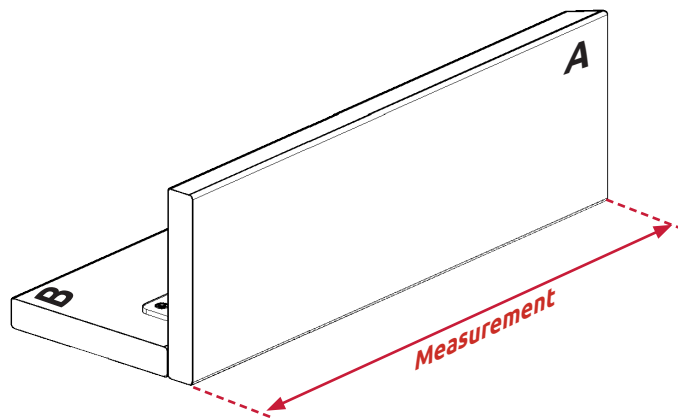

Step 18.

Apply measurement to the inside face of part C and cut to size. Part C should be mitred at a 45° angle, make sure to add extra material to the measurement in order to achieve the required mitre joint (see illustration right).

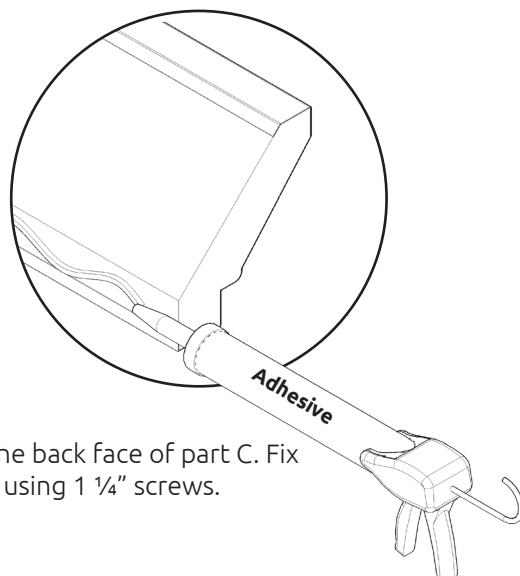

Step 19.

Apply adhesive to the back face of part C. Fix part C into position using 1 1/4" screws.

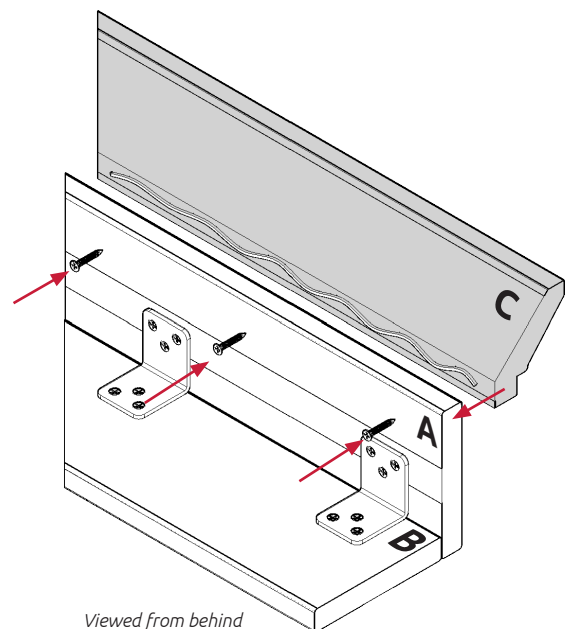

Step 20.

If using the classic crown molding repeat steps 17-19. Make sure the top face of part D is touching the bottom face of part C.

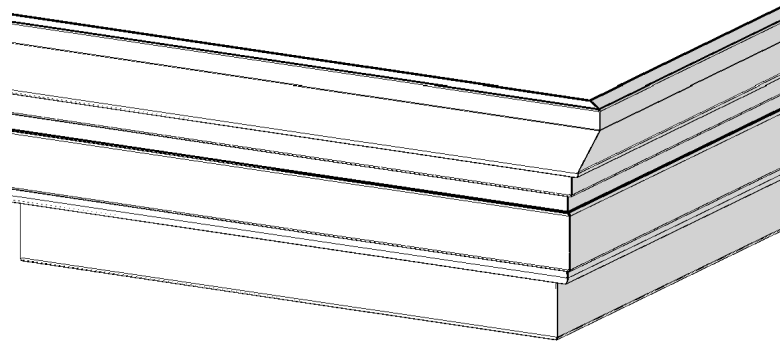
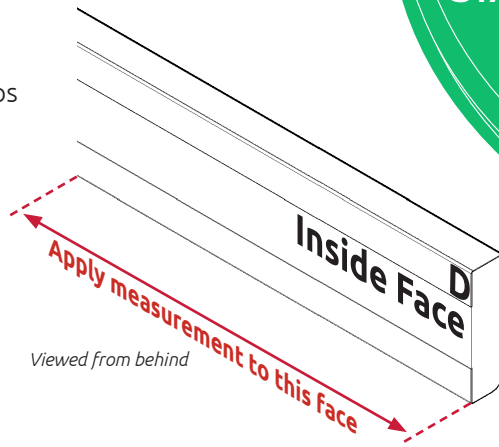
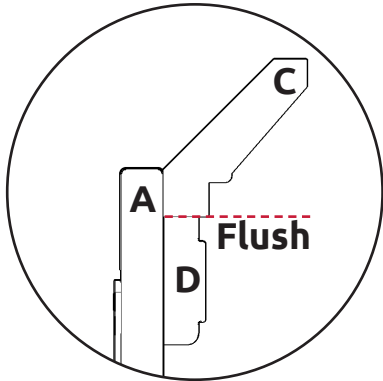

Step 21.

Repeat steps 11 - 20 to build the next adjoining crown molding.

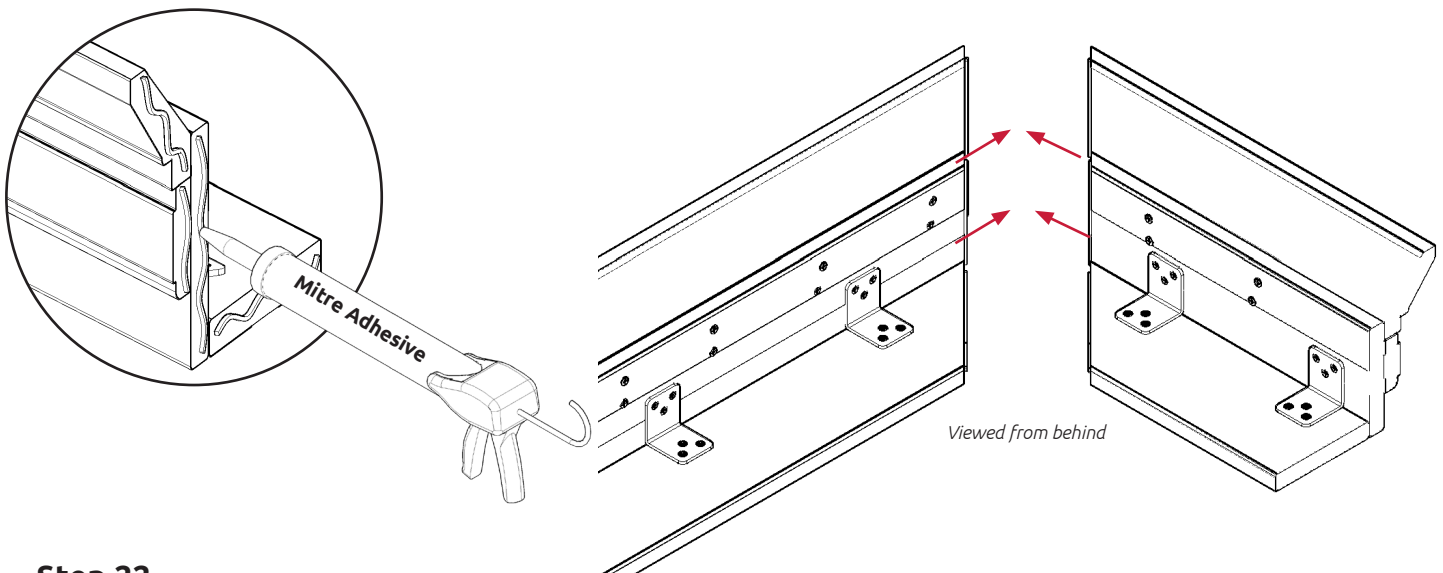

Step 22.

Apply mitre adhesive to each of the mitred joints and fix together. Make sure all the mitred joints are aligned properly.



Assembly should be carried out at ground level and lifted into place in one piece.

Internal Mitre Joint

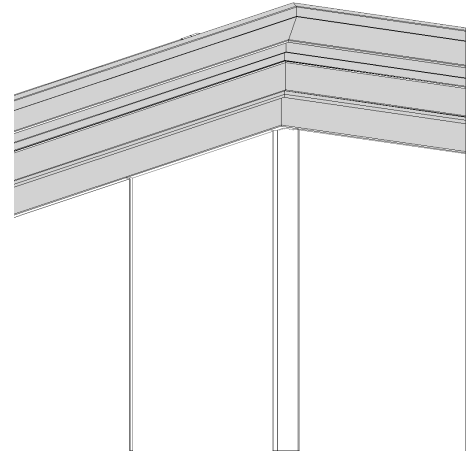

Example of internal mitre joint.
cabinet shown for illustration purposes only.

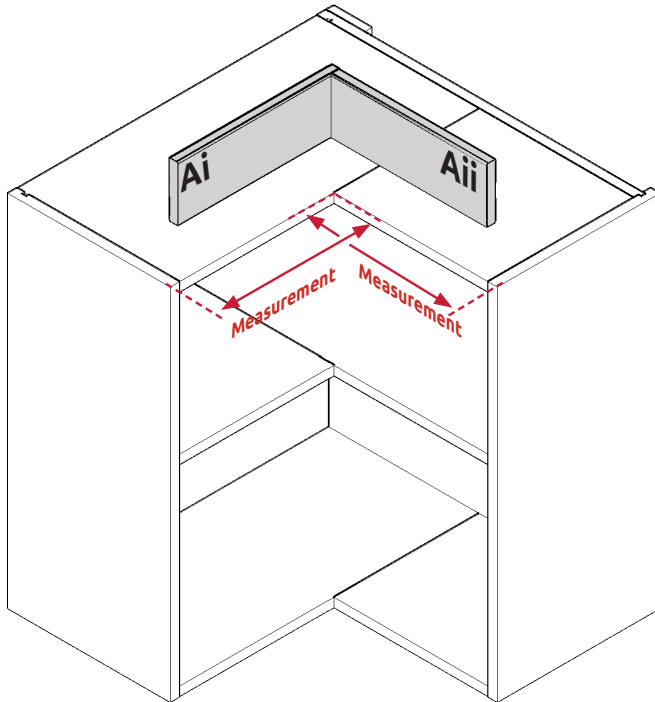

Step 23.

Take measurements from the outside face of the cabinets to the adjacent corner points (as per illustration on the left). The front face of part A must be flush with the front face of the doors

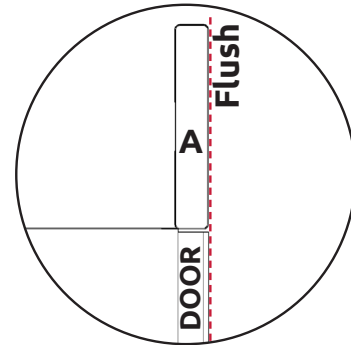

Step 24.

Cut parts A to size

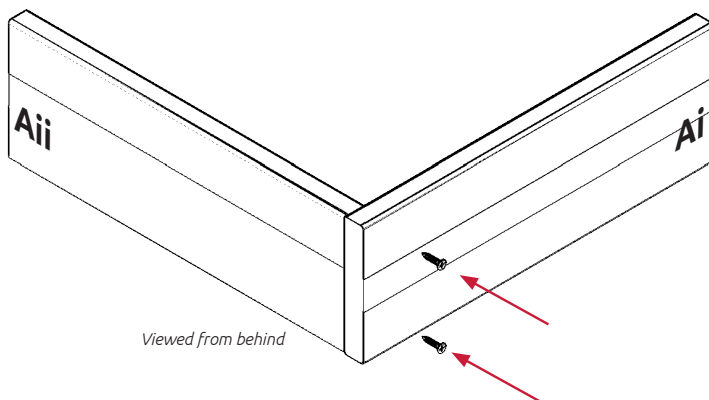
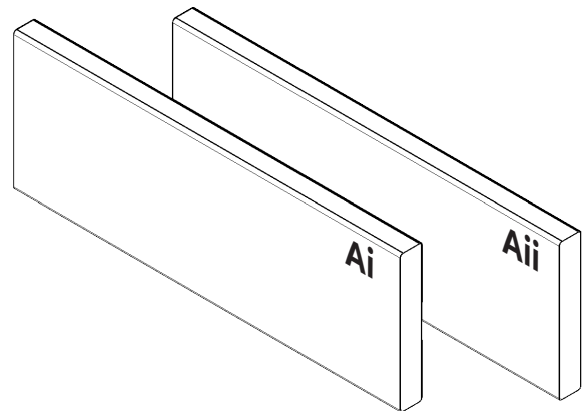

Step 25.

Screw through the inside face of part Ai into Aii using 1 1/4" screws fixing both parts together.

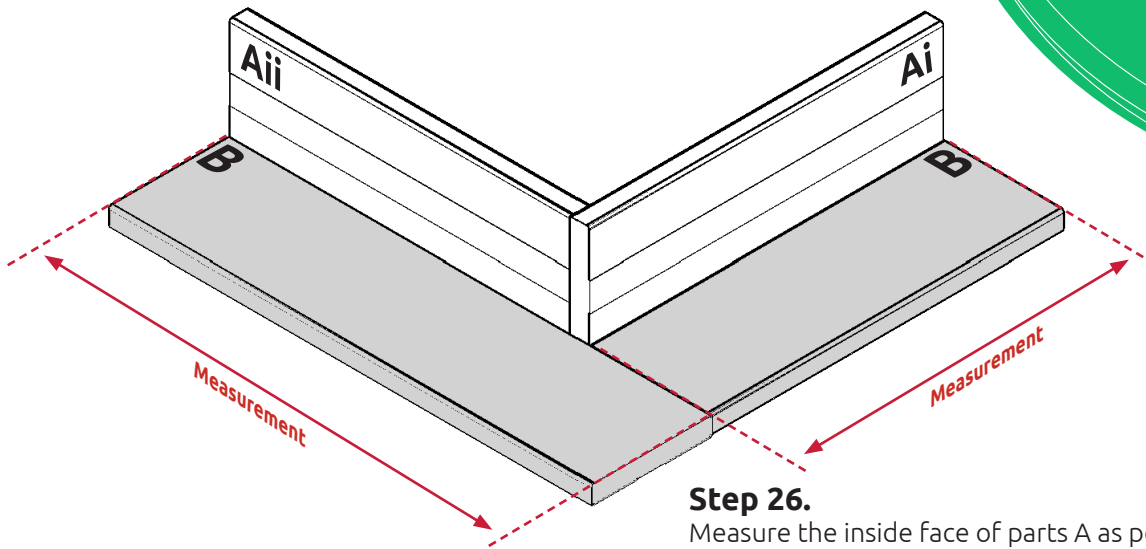

Step 26.

Measure the inside face of parts A as per the illustration above. Apply these measurements to parts B and cut to size.

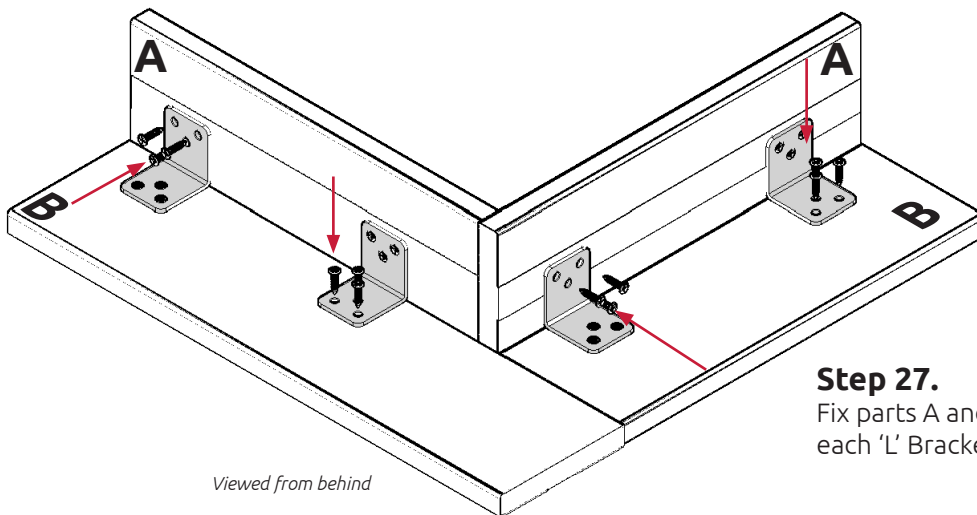

Step 27.

Fix parts A and B together using 'L' brackets. Fix each 'L' Bracket into place using 6 x 5/8" Screws.

Viewed from behind

Step 28.

Measure the outside face of part A.

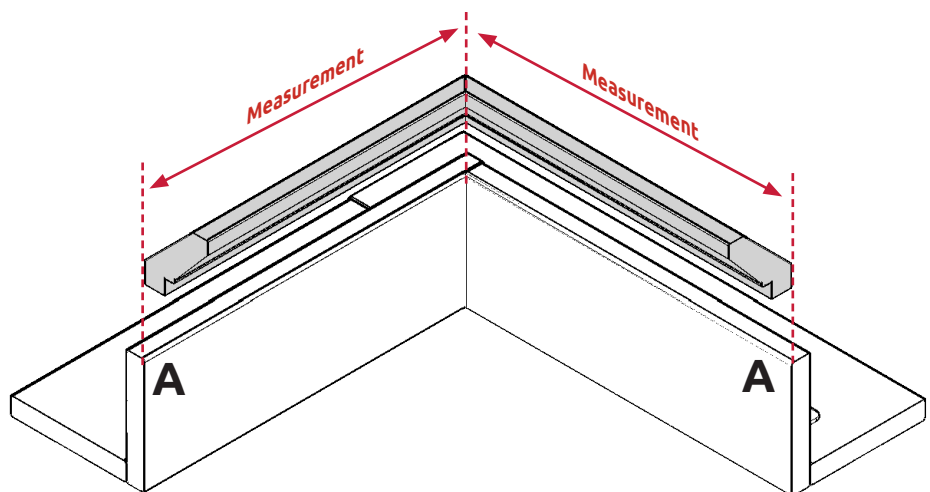

STACKED TRAD/CLASSIC CROWN MOLDING

FITTING GUIDE

Step 29.

Apply measurements to the inside face of part C and cut to size. Part C should be mitred at a 45° angle.

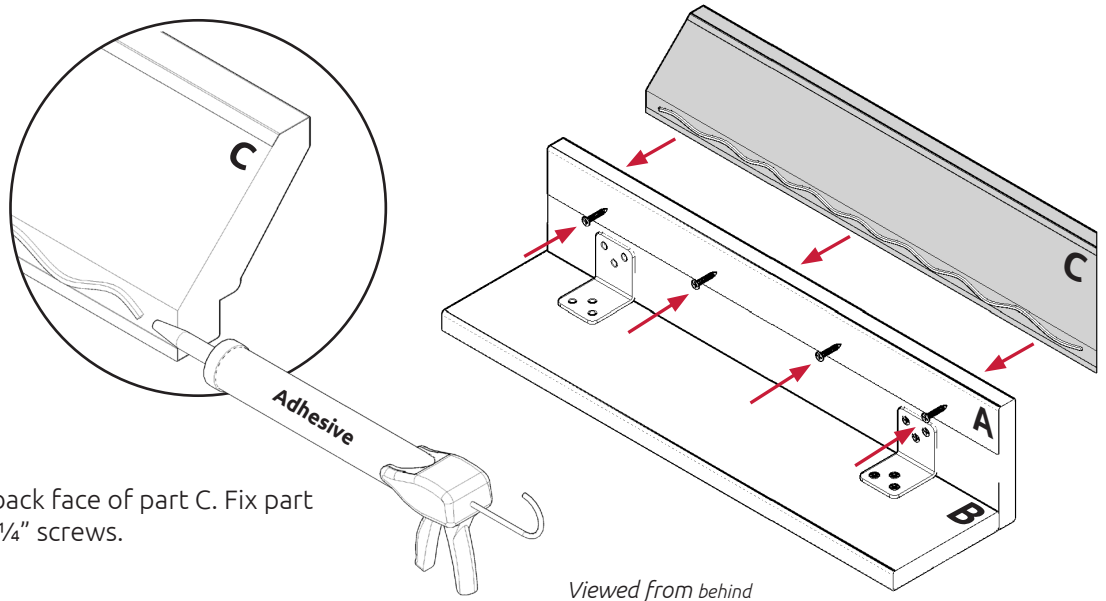
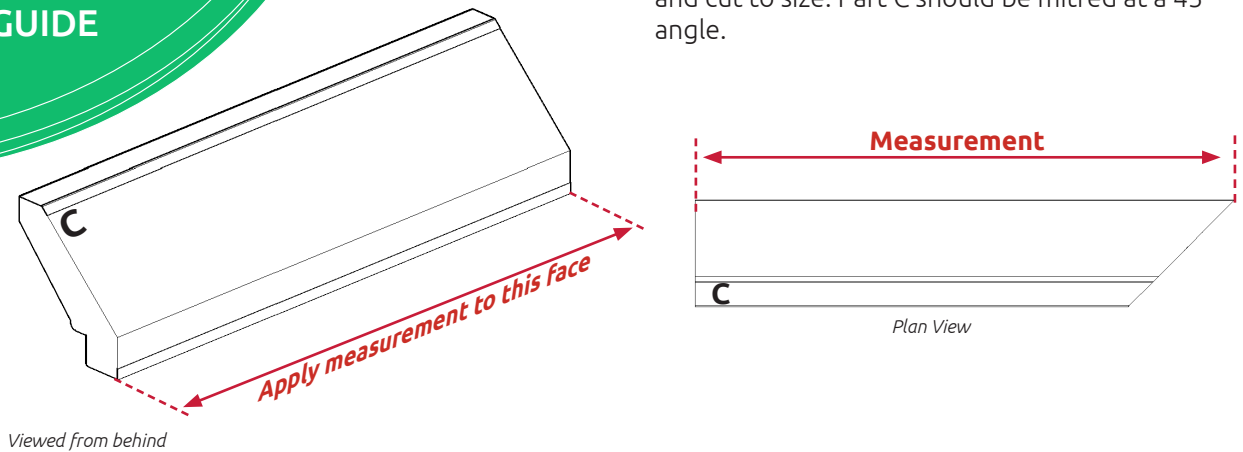

Step 30.

Apply adhesive to the back face of part C. Fix part C into position using 1 ¼" screws.

Step 31.

If using the classic crown moulding repeat steps 28-30. Make sure the top face of part D is touching the bottom face of part C.

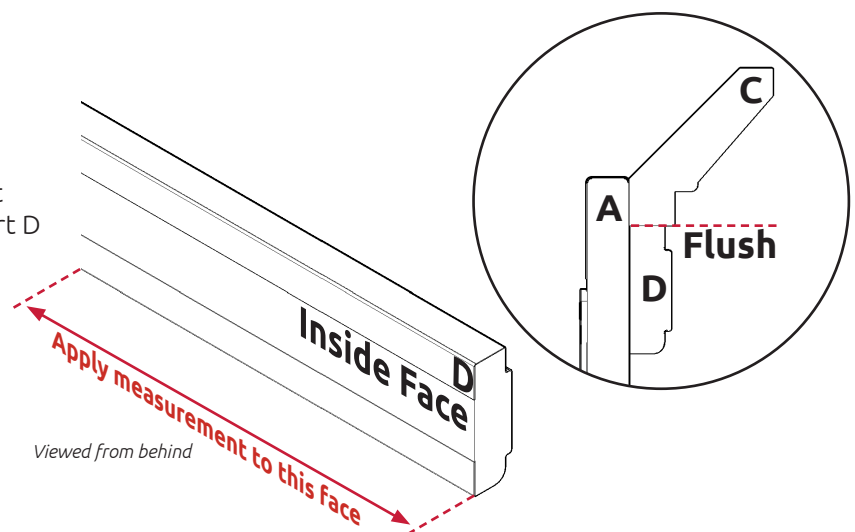

For final fitting instruction please turn to page 22

**Stepped Traditional / Classic
Crown Molding**
Pages 12 - 21

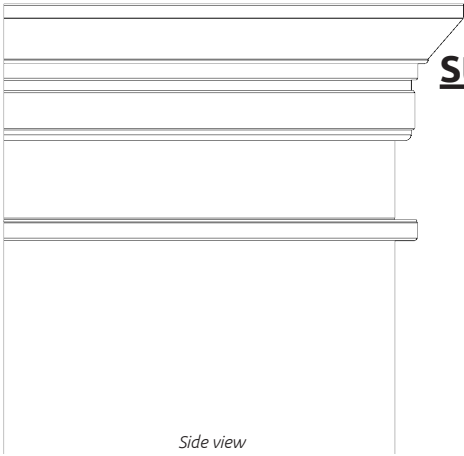

Side view
Cabinet shown for illustration
purposes only.



Please note that the stepped traditional/
classic crown molding has a minimum and
maximum height limitation see below.

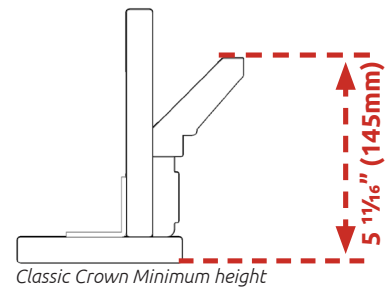
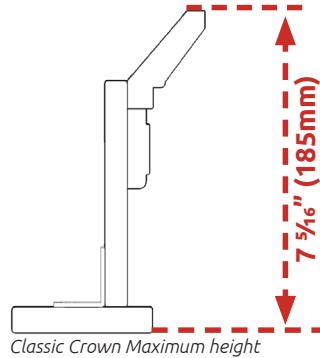
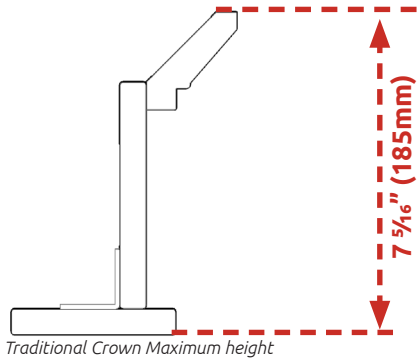

Straight Length

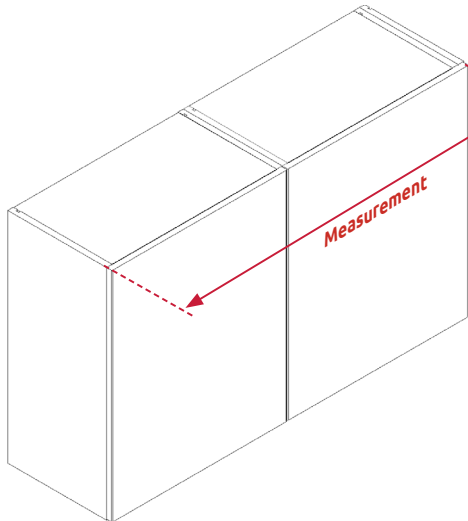

Step 33.

Measure the distance from each end of the wall cabinets.

Step 34.

Apply the measurement to part A and
cut to size.

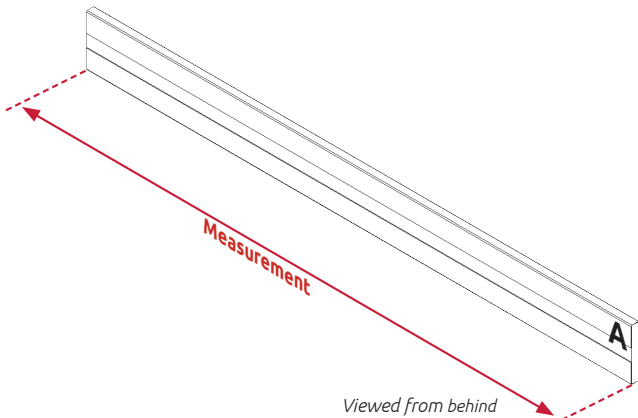
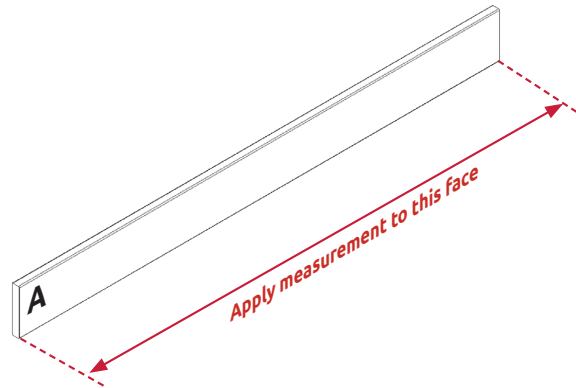

Step 35.

Measure the inside face of part A.

STACKED TRAD/CLASSIC CROWN MOLDING

FITTING GUIDE

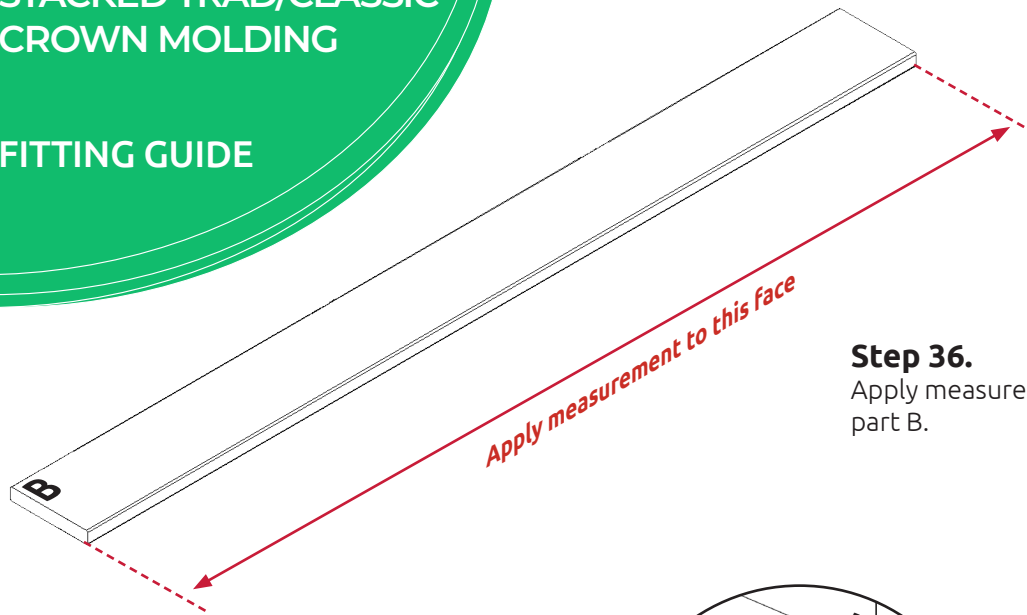

Step 36.

Apply measurement to the front edge of part B.

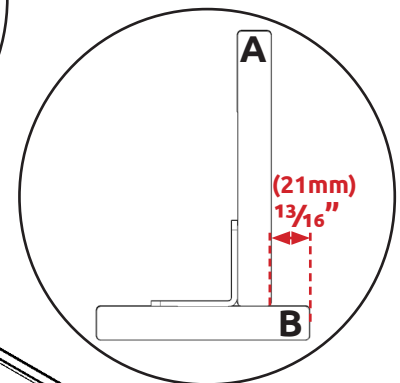
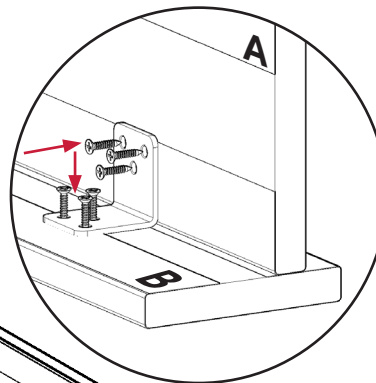

Step 37.

Placing parts A on top of parts B fix together using 'L' brackets. Fix each 'L' Bracket into place using 6 x 5/8" Screws. Make sure there is a 13/16" (21mm) gap from the front of part A to the front of part B.

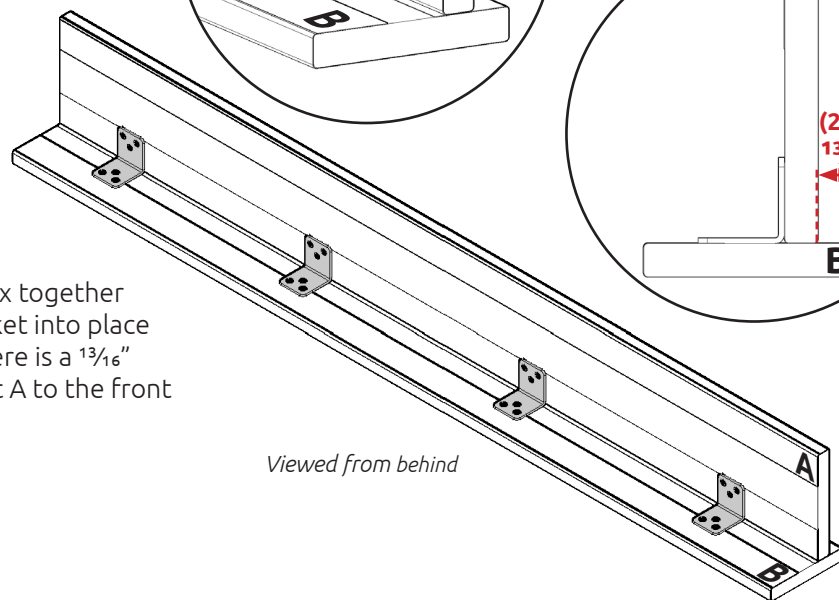

Viewed from behind

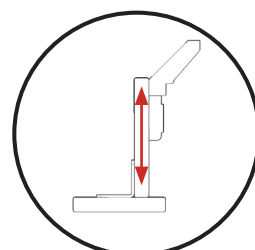
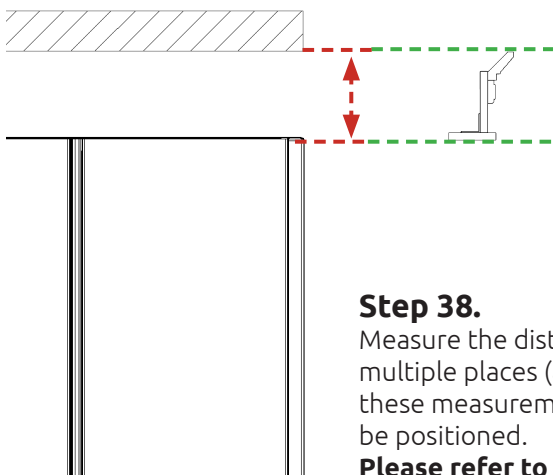

Stacked crown molding is adjustable along the toe kick upright

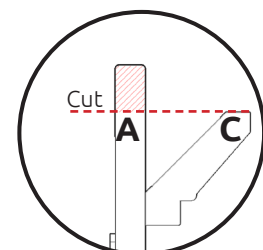

Please note: if part C sits lower then part A then part A should be cut down to size.

Step 38.

Measure the distance from the top of cabinet to the ceiling in multiple places (along the full run of cabinets). Take the lowest of these measurements to obtain where the stacked crown molding will be positioned.

Please refer to the minimum and maximum positions on page 12

Step 39.

Measure the outside face of part A.

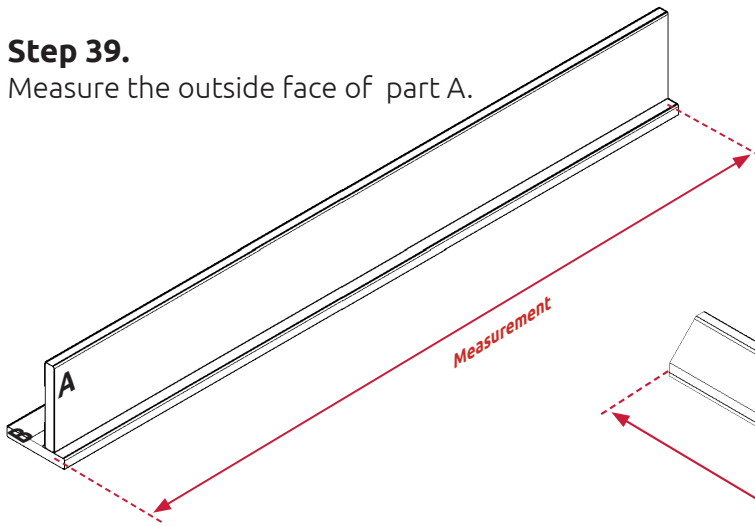

Step 40.

Apply measurement to the inside face of part C and cut to size.

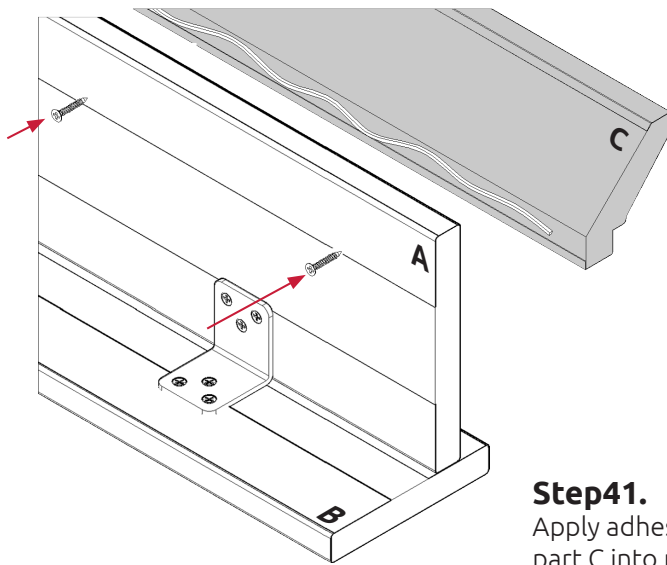
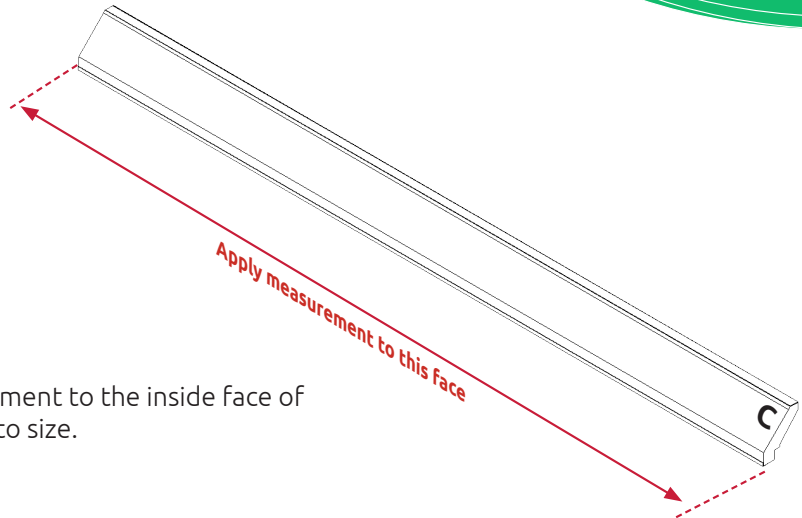

Viewed from behind

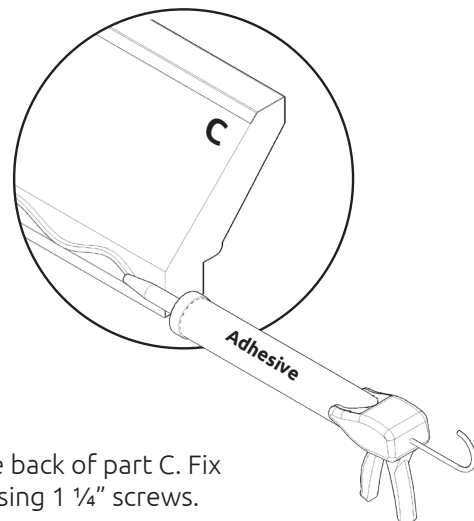

Step 41.

Apply adhesive to the back of part C. Fix part C into position using 1 1/4" screws.

Step 42.

If using the classic traditional crown molding repeat steps 39-41. Make sure the top face of part D is touching the bottom face of part C.

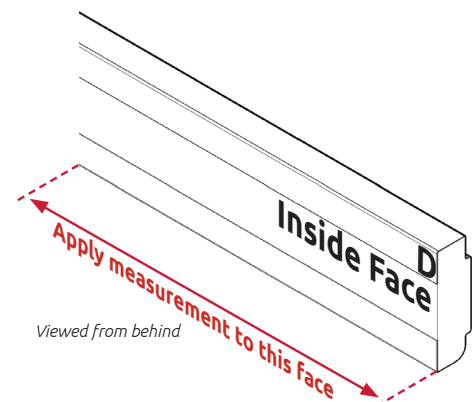
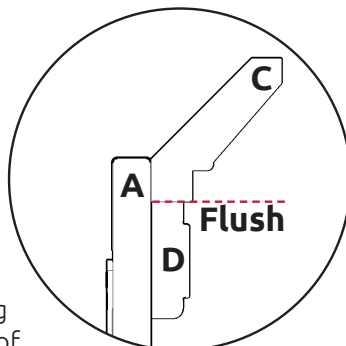

Viewed from behind

External Mitre Joint

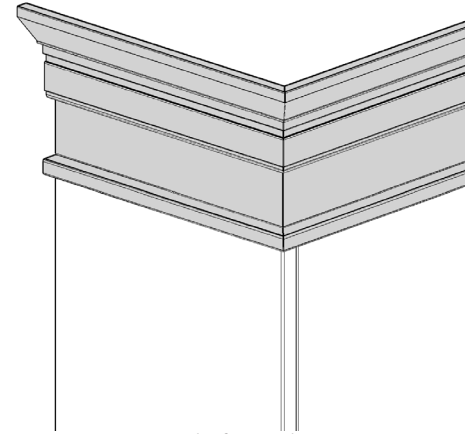

Example of external mitre joint.
cabinet shown for illustration purposes only.

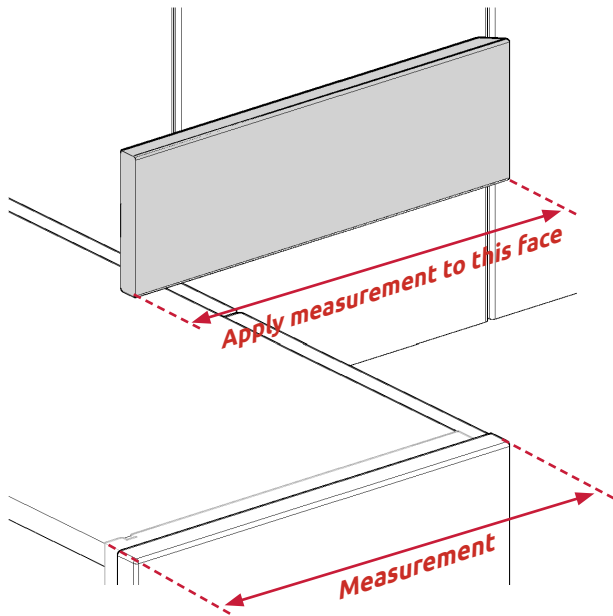

Step 43.

Measure the distance from the wall to the front face of the decor end.

Step 44.

Apply the measurement to part A and cut to size. Mitre cut the front edge (that will line up with the doors) at a 45° angle.

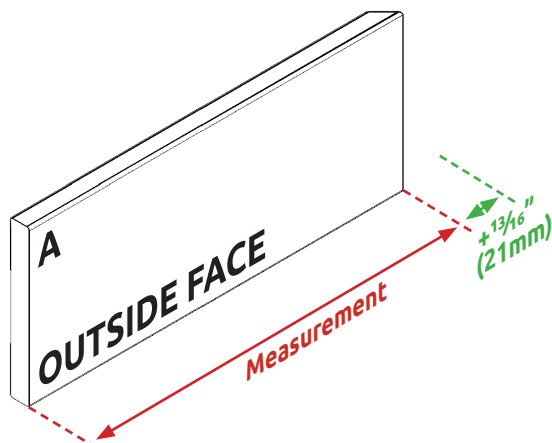
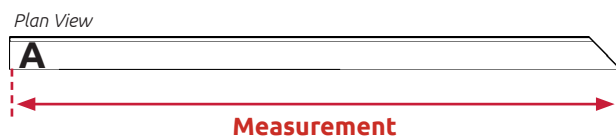

Step 45.

Measure the outside face of part A (from the wall to the external mitre) and add $1\frac{3}{16}$ " (21mm).

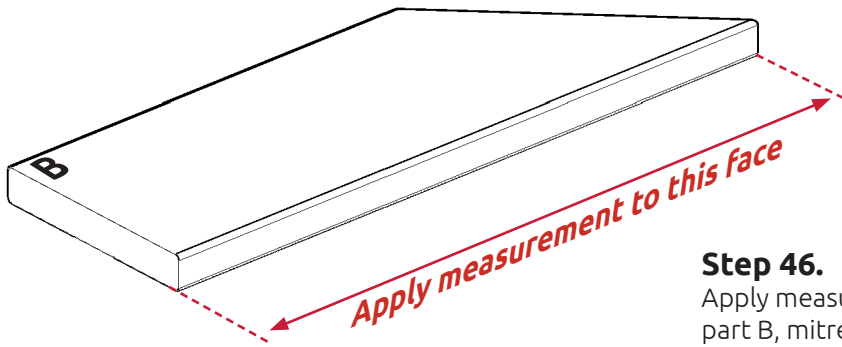

Step 46.

Apply measurement to the front edge of part B, mitre at a 45° angle.

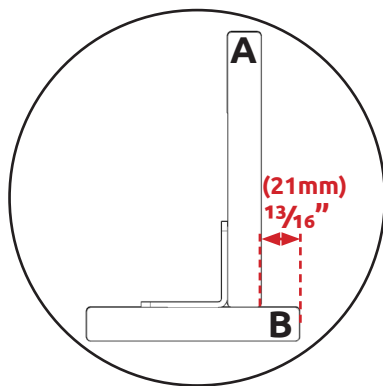

Step 47.

Fix together parts A and B using 'L' brackets. Fix each 'L' Bracket into place using 6 x 5/8" Screws. Make sure there is a 13/16" (21mm) gap between the front faces of parts A and B.

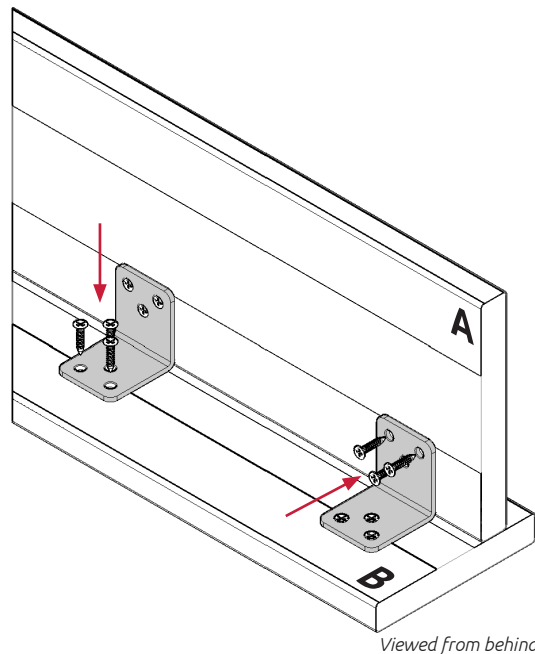

Viewed from behind

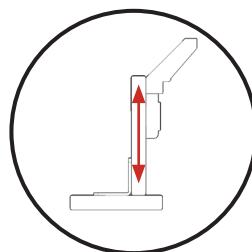
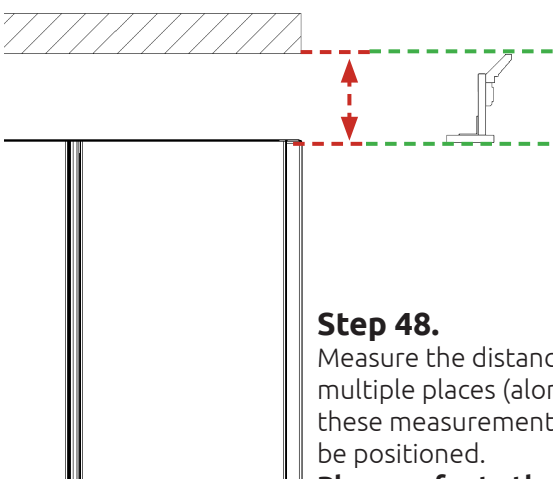

Stacked crown molding is adjustable along the toe kick upright

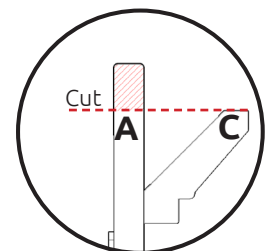

Please note: if part C sits lower than part A then part A should be cut down to size.

Step 48.

Measure the distance from the top of cabinet to the ceiling in multiple places (along the full run of cabinets). Take the lowest of these measurements to obtain where the stacked crown molding will be positioned.

Please refer to the minimum and maximum positions on page 12



STACKED TRAD/CLASSIC CROWN MOLDING

FITTING GUIDE

Step 49.

Measure the outside face of part A.

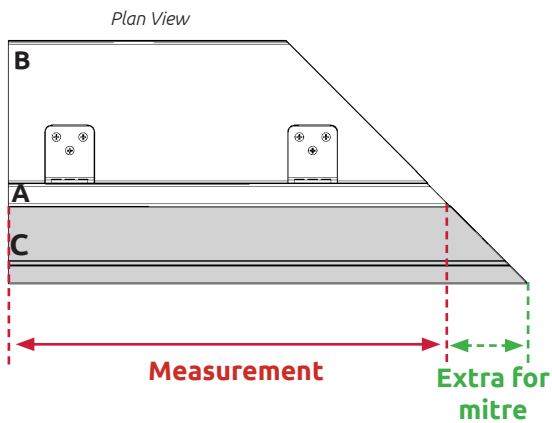
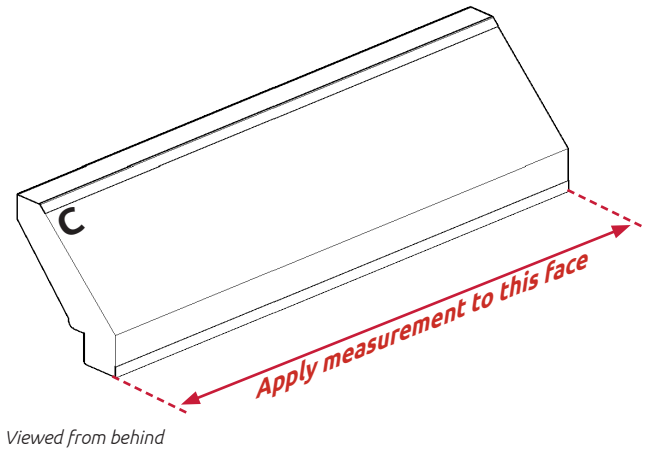
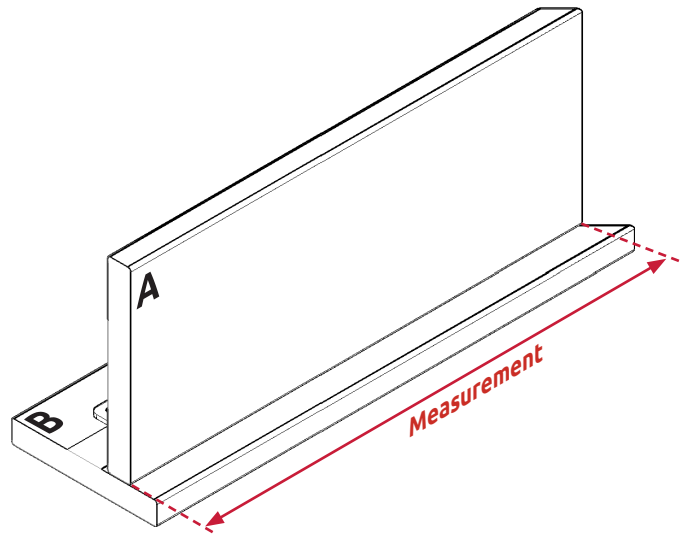

Step 50.

Apply measurement to the inside face of part C and cut to size. Part C should be mitred at a 45° angle, make sure to add extra material to the measurement in order to achieve the required mitre joint (see illustration right).

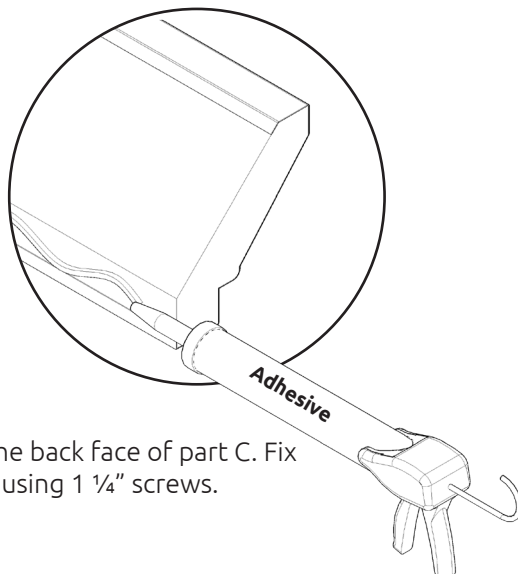

Step 51.

Apply adhesive to the back face of part C. Fix part C into position using 1 1/4" screws.

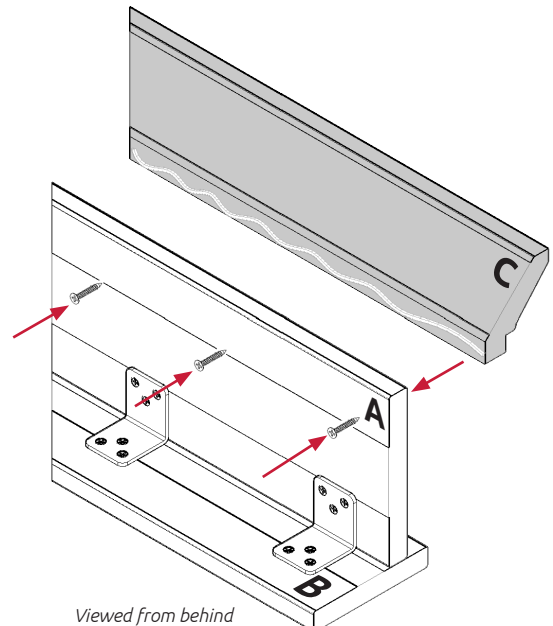

Step 52.

If using the classic crown molding repeat steps 49-51. Make sure the top face of part D is touching the bottom face of part C.

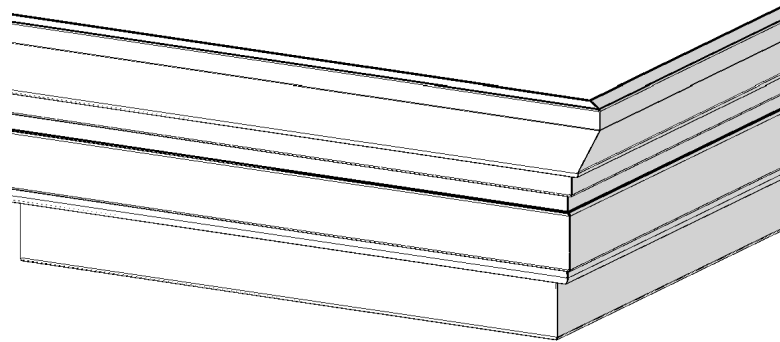
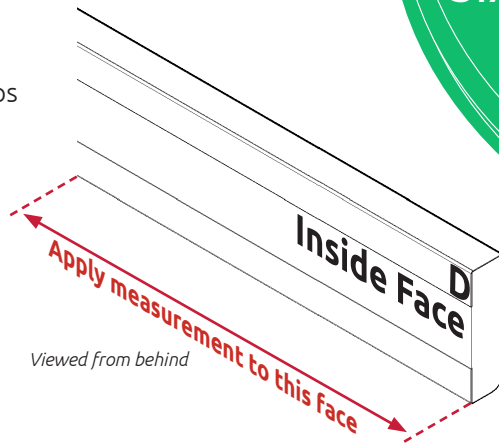
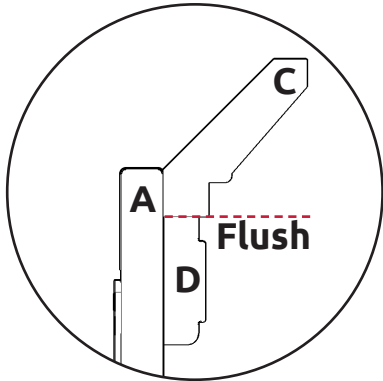

Step 53.

Repeat steps 43 - 51 to build the next adjoining crown molding.

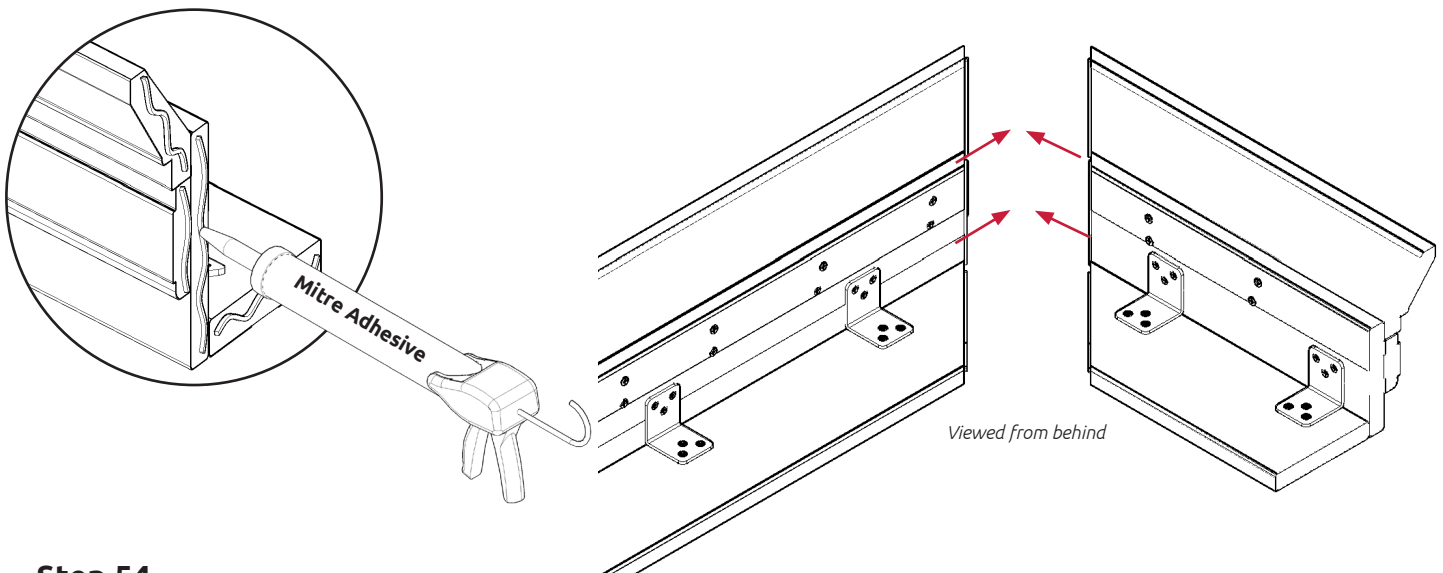

Step 54.

Apply mitre adhesive to each of the mitred joints and fix together. Make sure all the mitred joints are aligned properly.



Assembly should be carried out at ground level and lifted into place in one piece.

Internal Mitre Joint

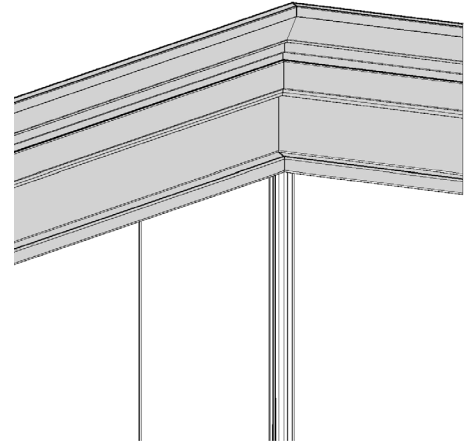

Example of internal mitre joint.
cabinet shown for illustration purposes only.

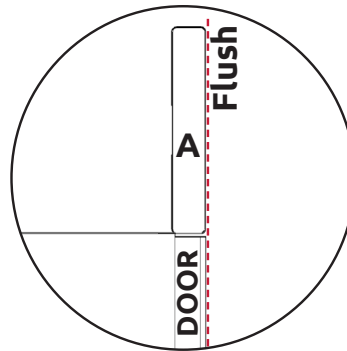
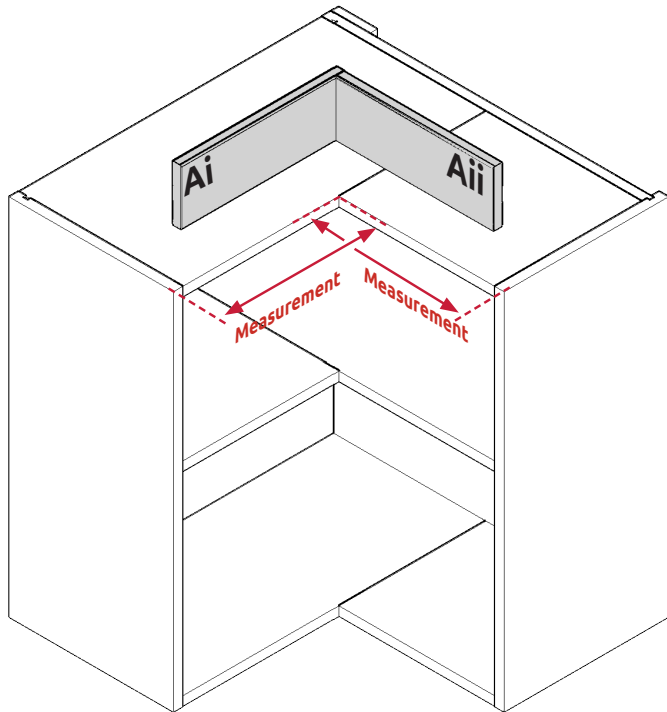

Step 55.

Take measurements from the outside face of the cabinets to the adjacent corner points (as per illustration on the left). The front face of part A must be flush with the front face of the doors.

Step 56.

Cut parts A to size.

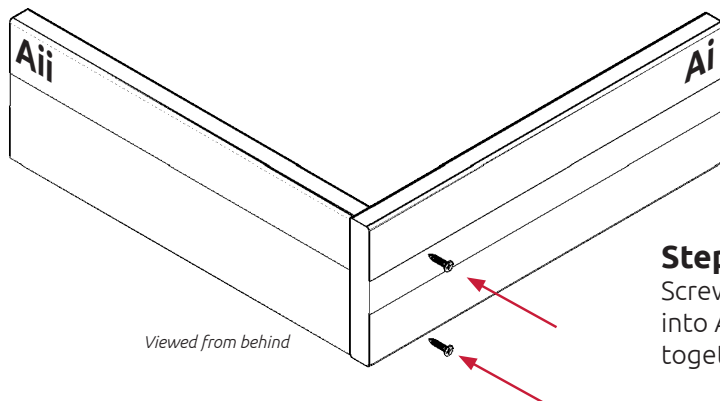
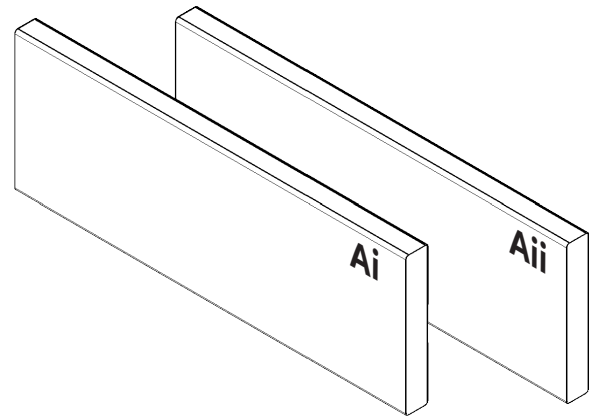

Step 57.

Screw through the inside face of part Ai into Aii using 1 1/4" screws fixing both parts together.

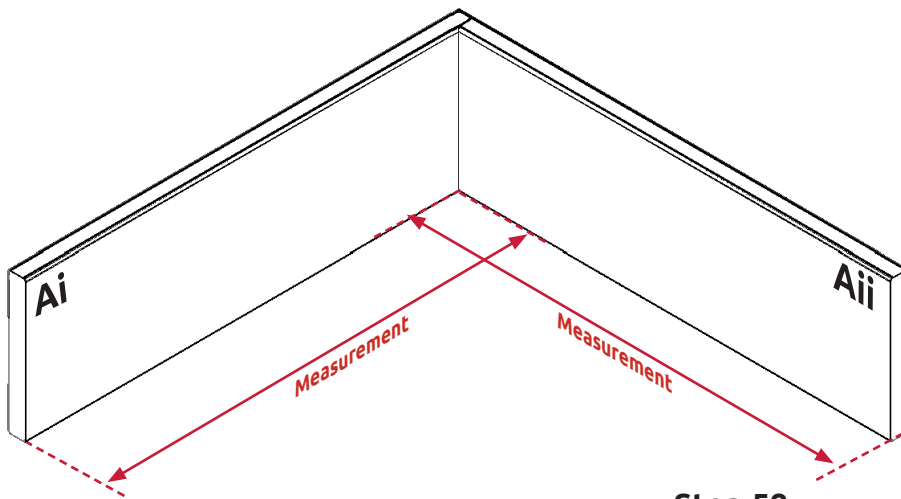

Step 58.

Measure the outside face of parts A as per the illustration above.

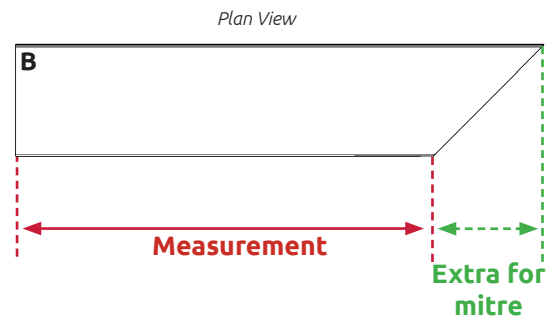
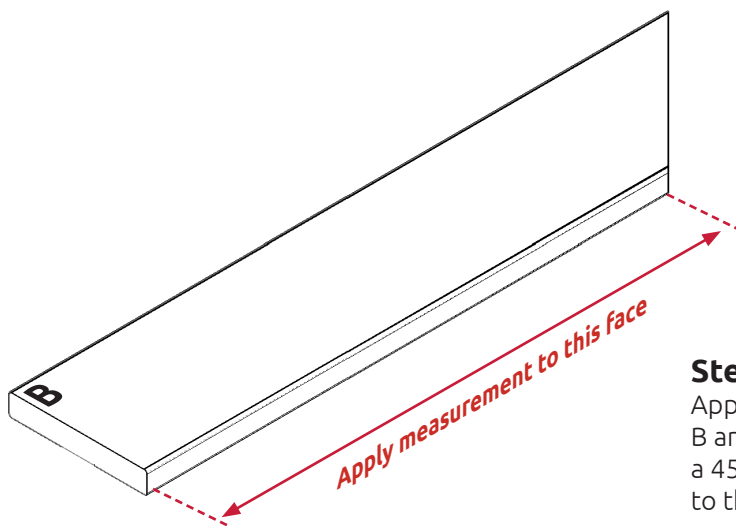

Step 59.

Apply measurement to the front face of part B and cut to size. Part B should be mitred at a 45° angle, make sure to add extra material to the measurement in order to achieve the required mitre joint (see illustration above).

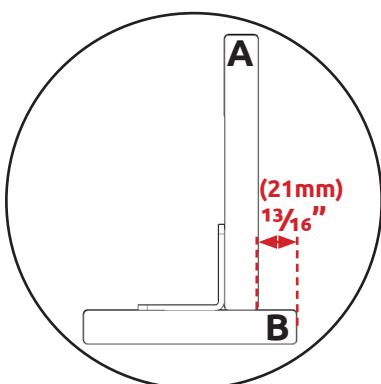

Step 60.

Fix together parts A and B using 'L' brackets. Fix each 'L' Bracket into place using 6 x 5/8" Screws. Make sure there is a 13/16" (21mm) gap between the front faces of parts A and B.

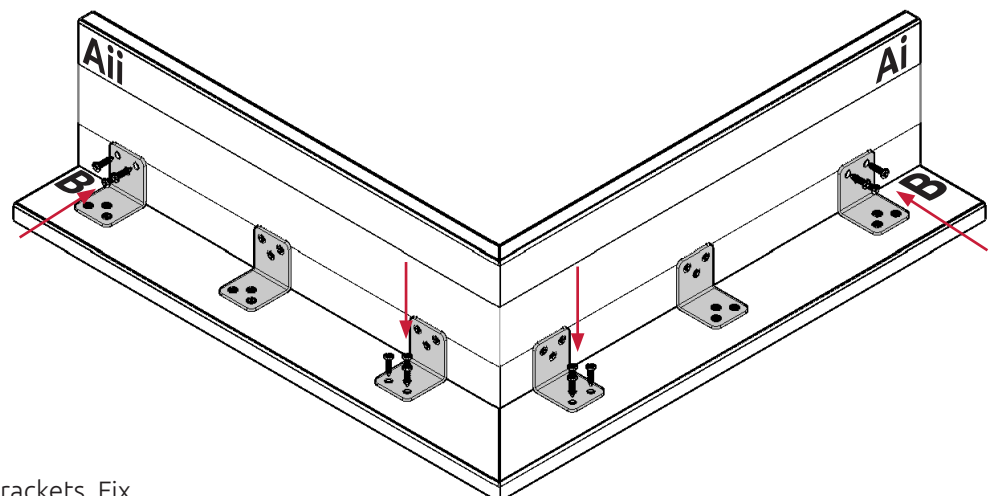

Viewed from behind

STACKED TRAD/CLASSIC CROWN MOLDING

FITTING GUIDE

Step 61.

Measure the outside face of part A

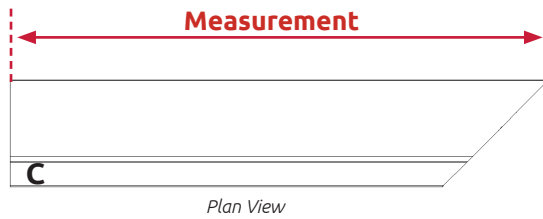
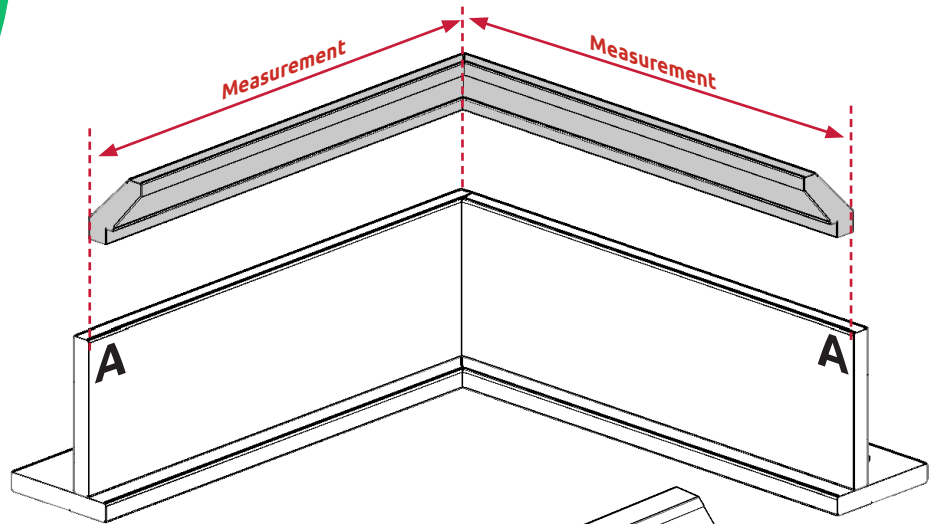

Step 62.

Apply measurements to the inside face of part C and cut to size. Part C should be mitred at a 45° angle.

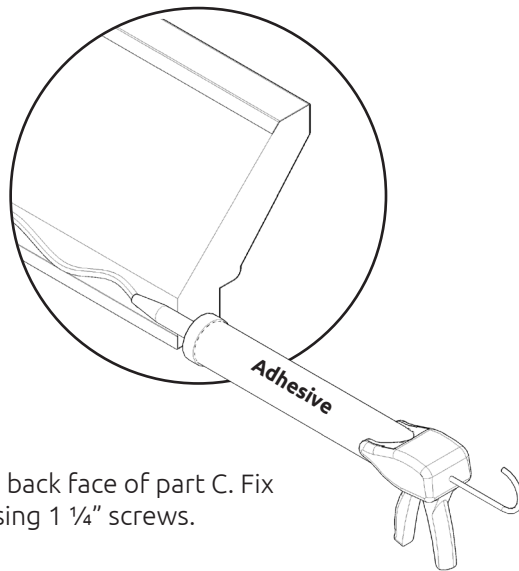
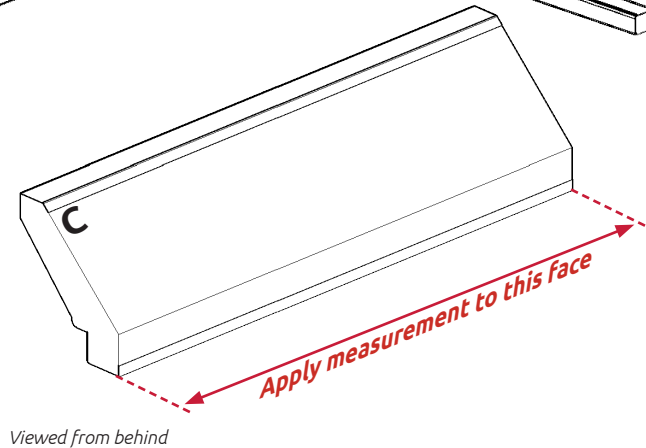

Step 63.

Apply adhesive to the back face of part C. Fix part C into position using 1 1/4" screws.

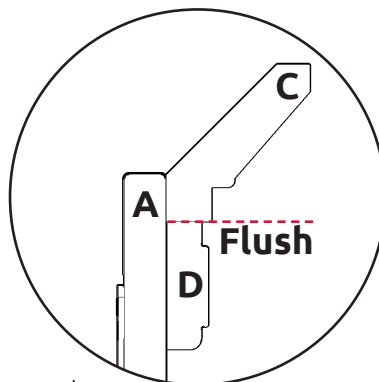
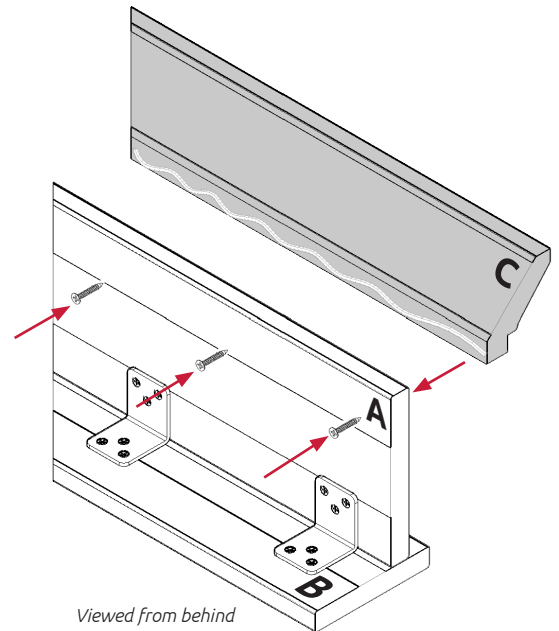

Step 64.

If using the classic crown moulding repeat steps 61-63. Make sure the top face of part D is touching the bottom face of part C.

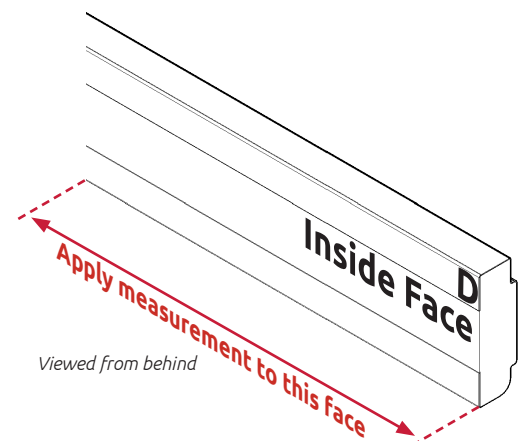

Final Fit

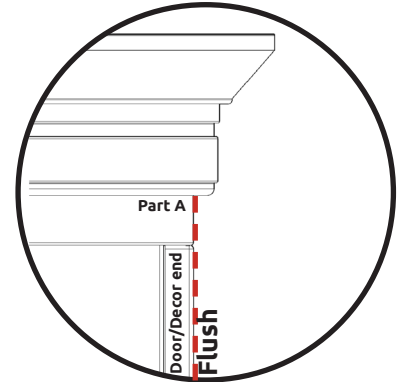
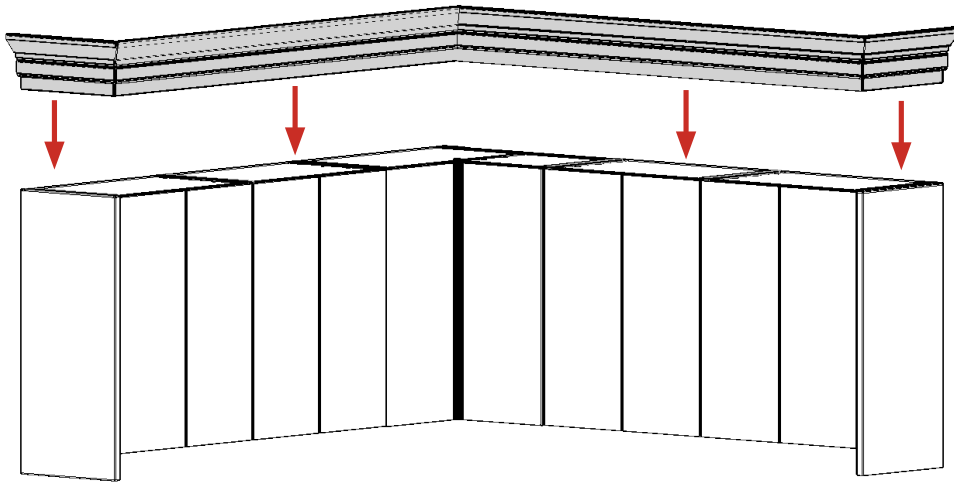

Stacked Traditional / Classic Crown Molding

Step 65.

Lift the assembled stacked crown molding onto the top of wall cabinets making sure the outside face of Part A is flush with the decor end/doors. **Please note this step should be carried out by a minimum of two people.**

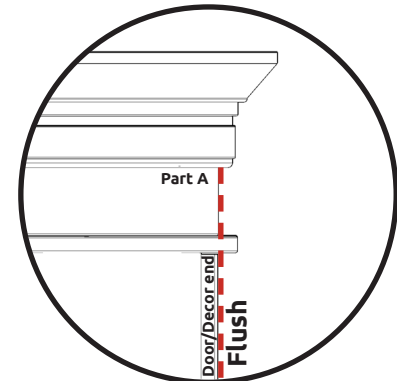

Stacked Traditional / Classic Stepped Crown Molding

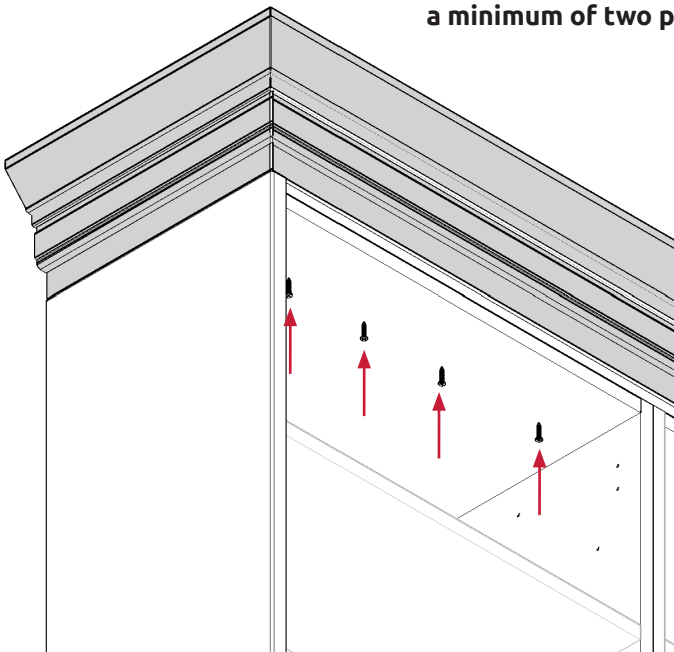

Step 66.

Secure the traditional stacked crown molding in place by screwing up through the cabinet top fixed shelves into part B using 1 1/4" screws. Conceal the screw heads using the screw caps provided.

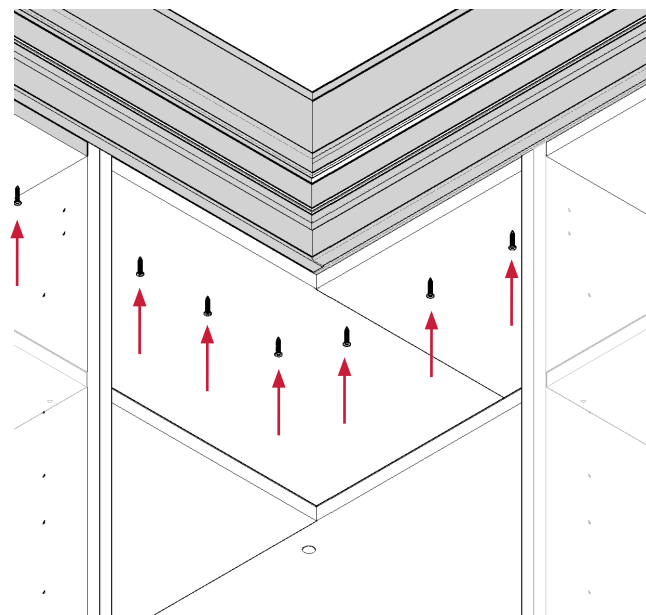

wren
KITCHENS