

05 / 2017

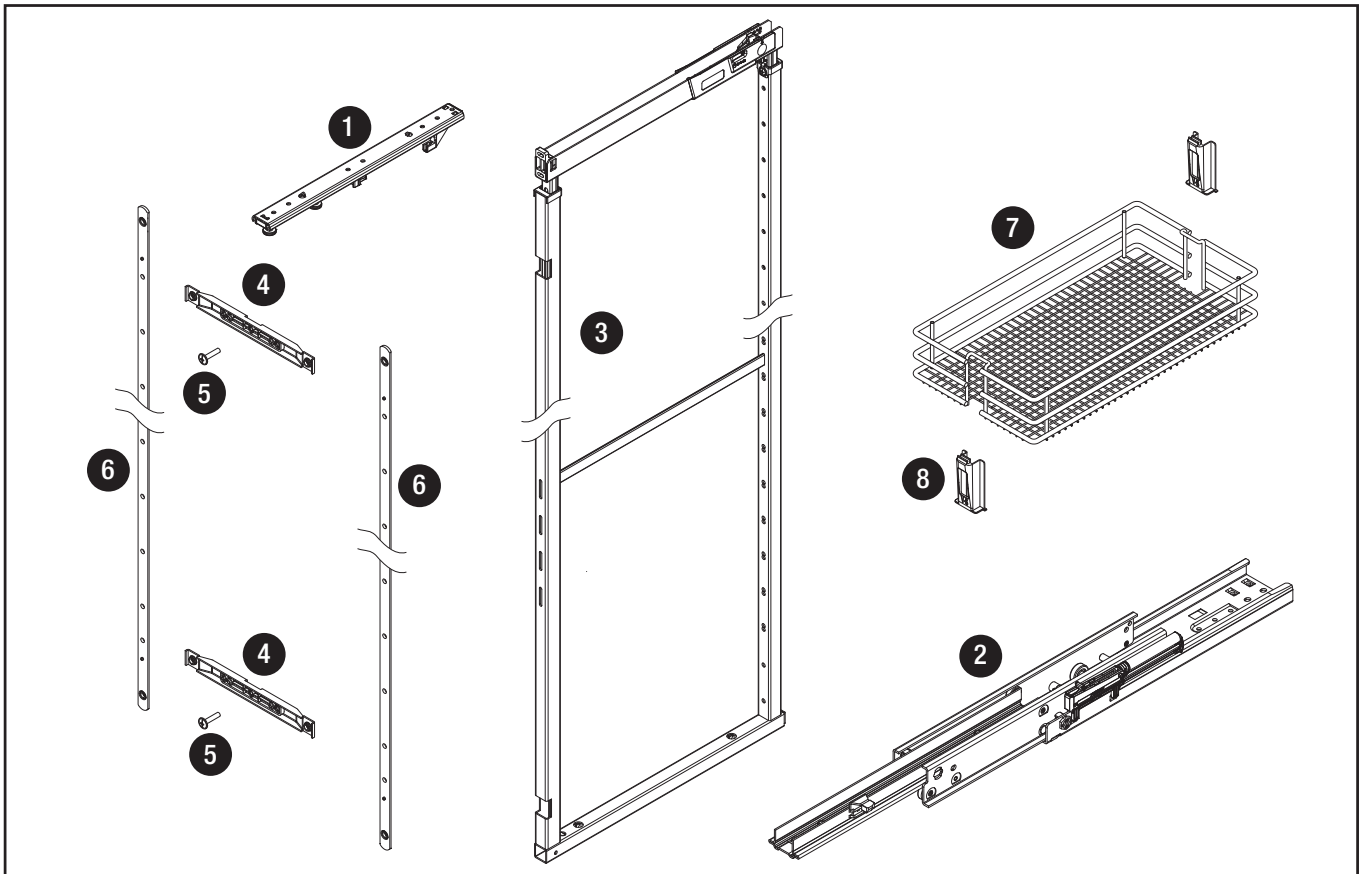

VS TAL Larder

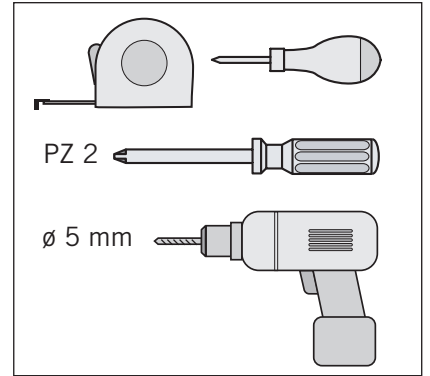

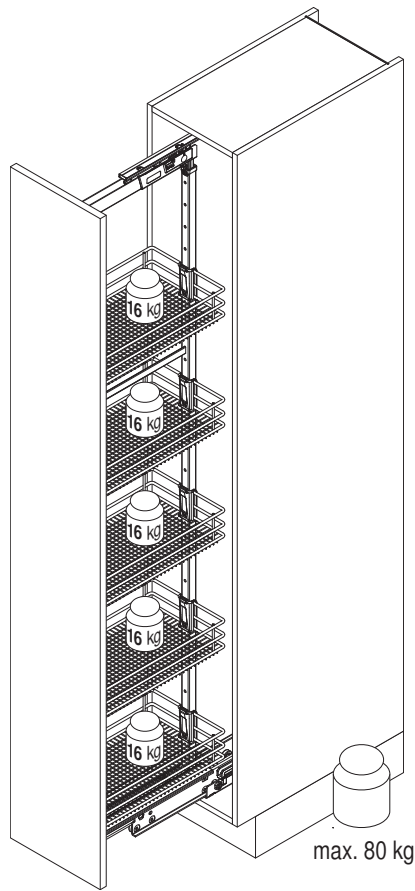
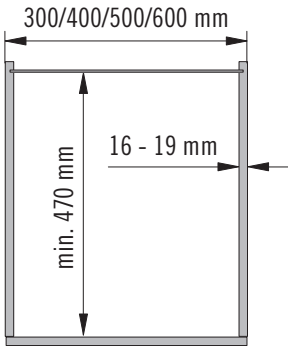
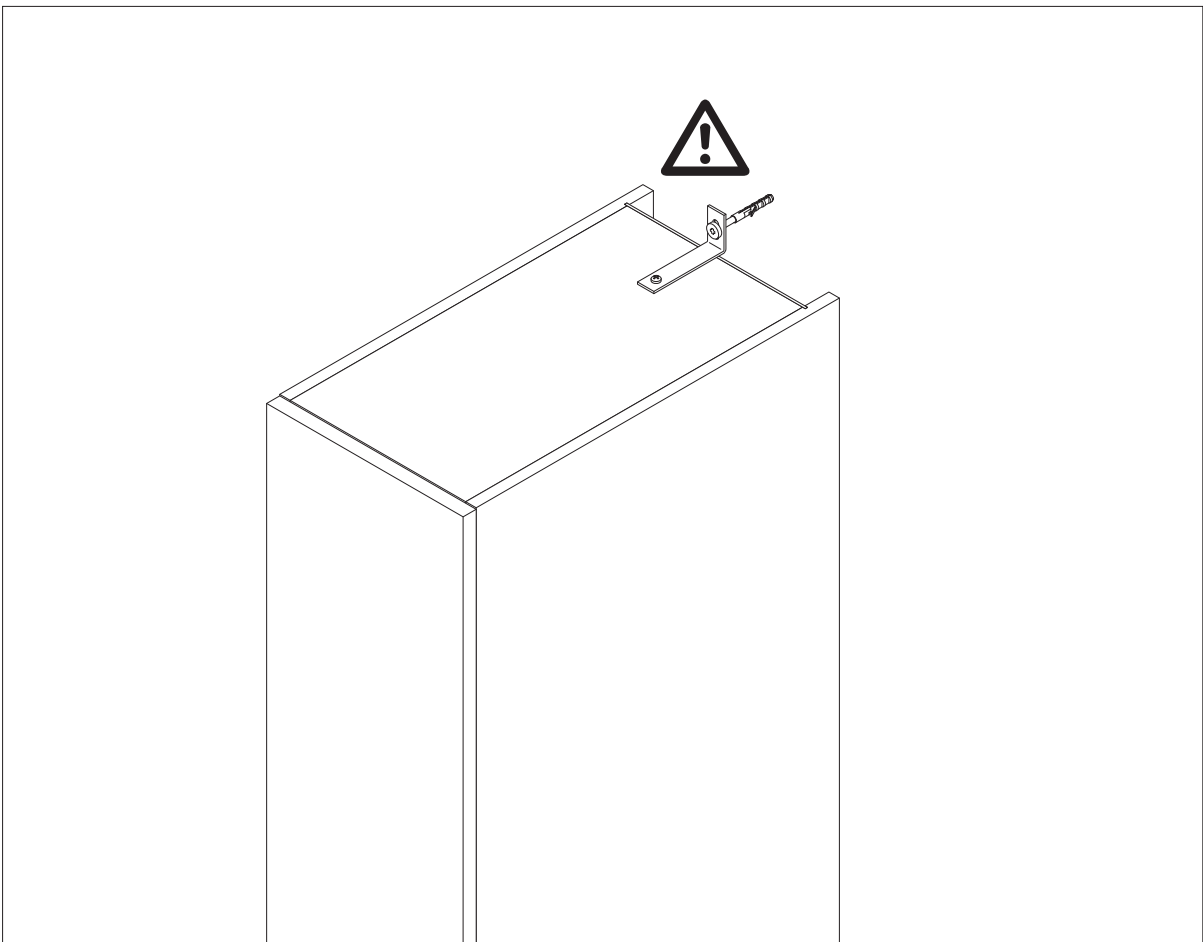
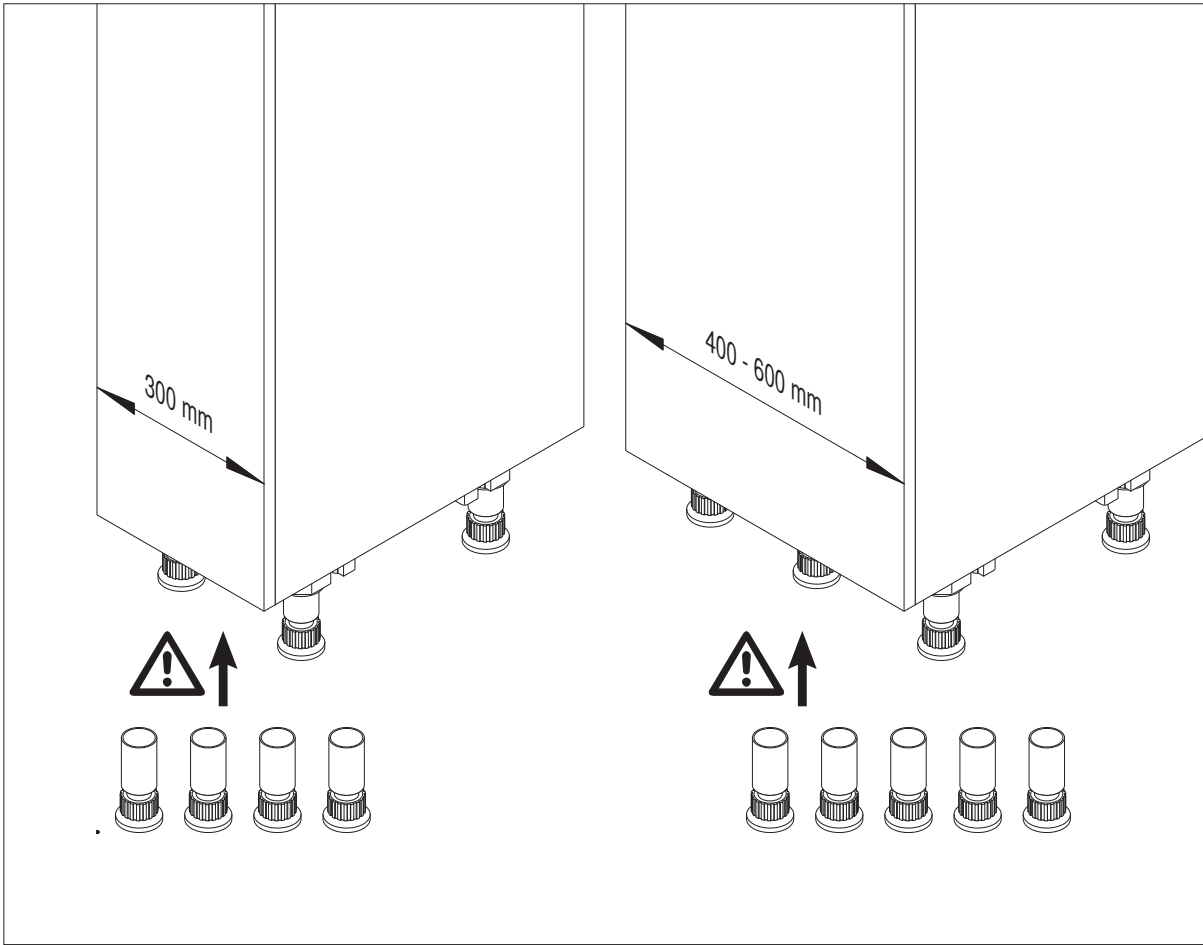

1

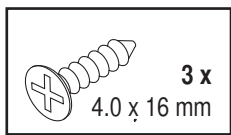
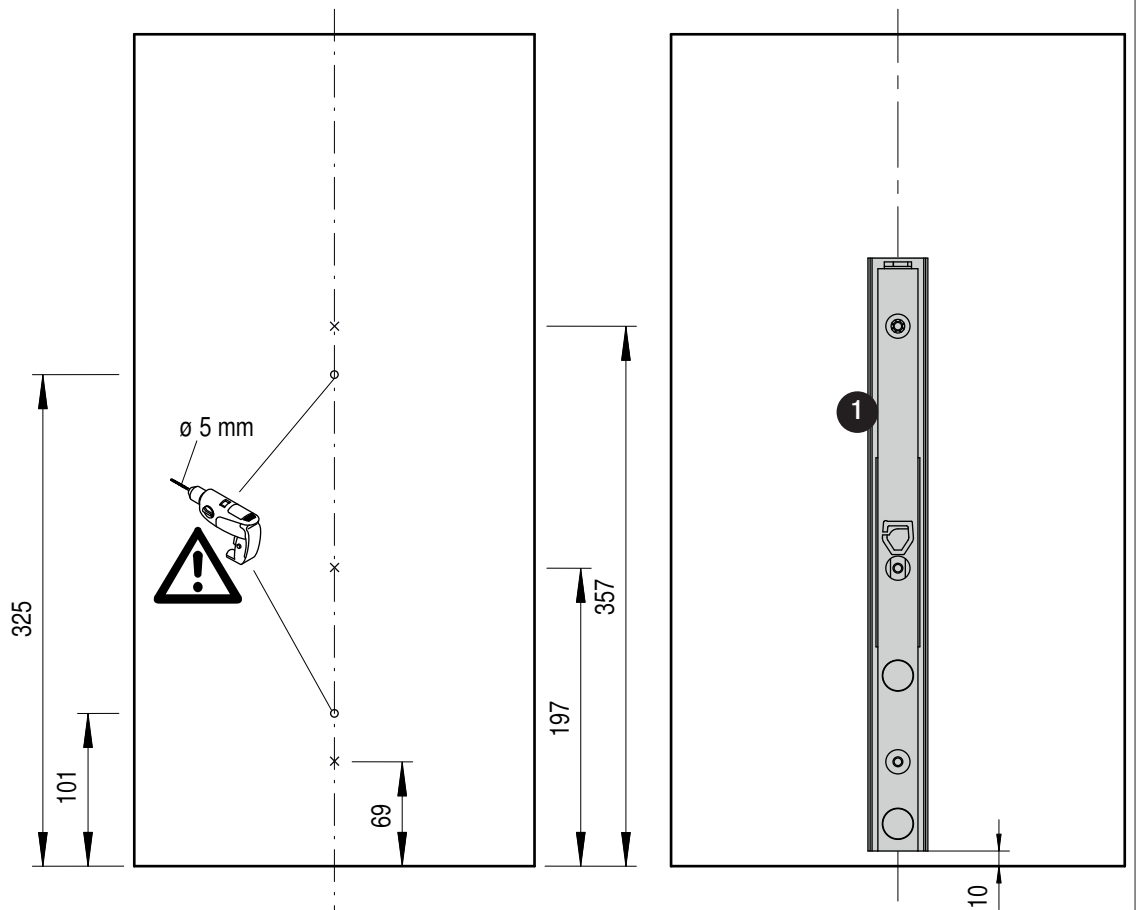
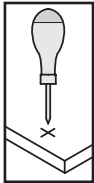
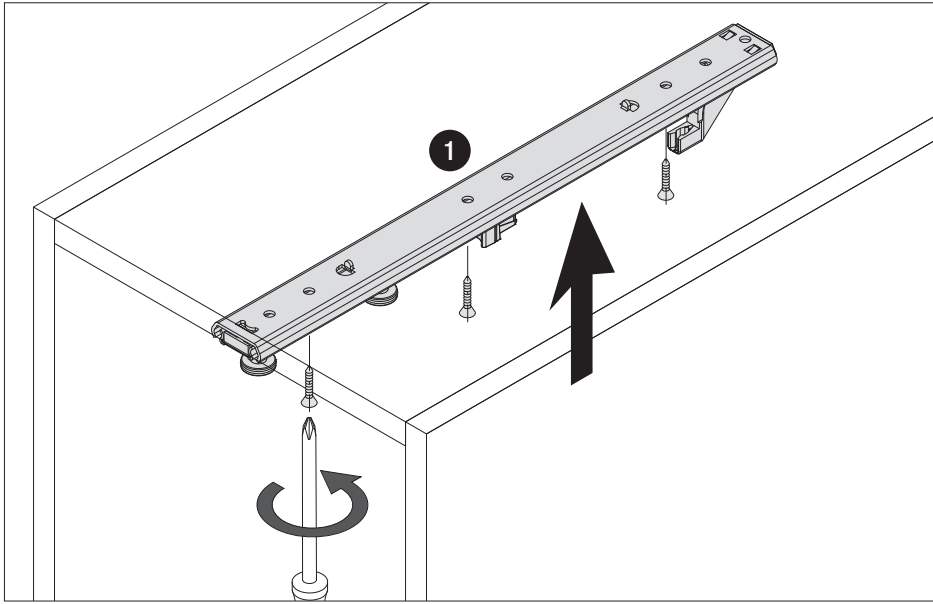

2

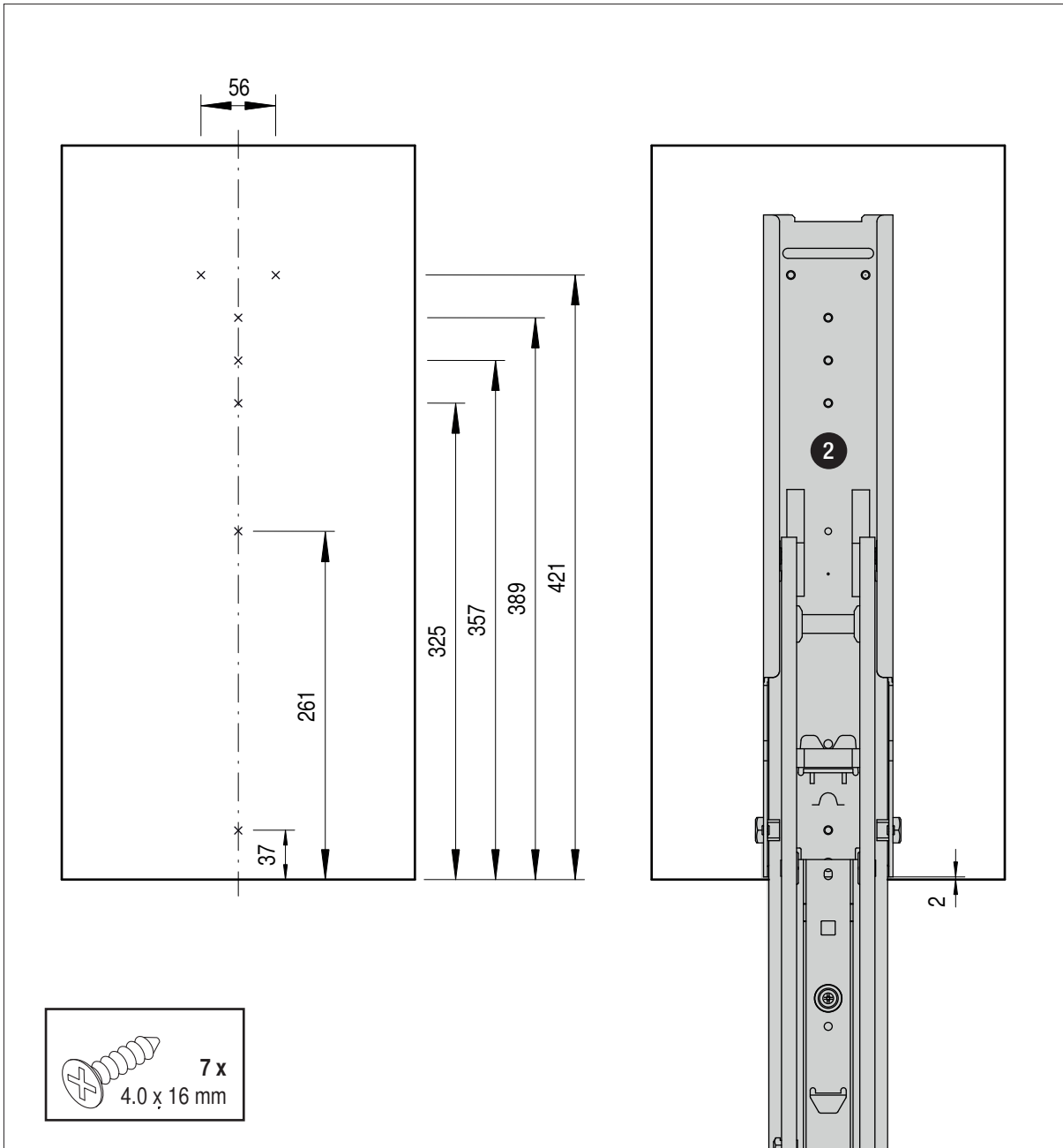
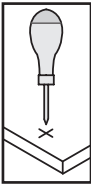
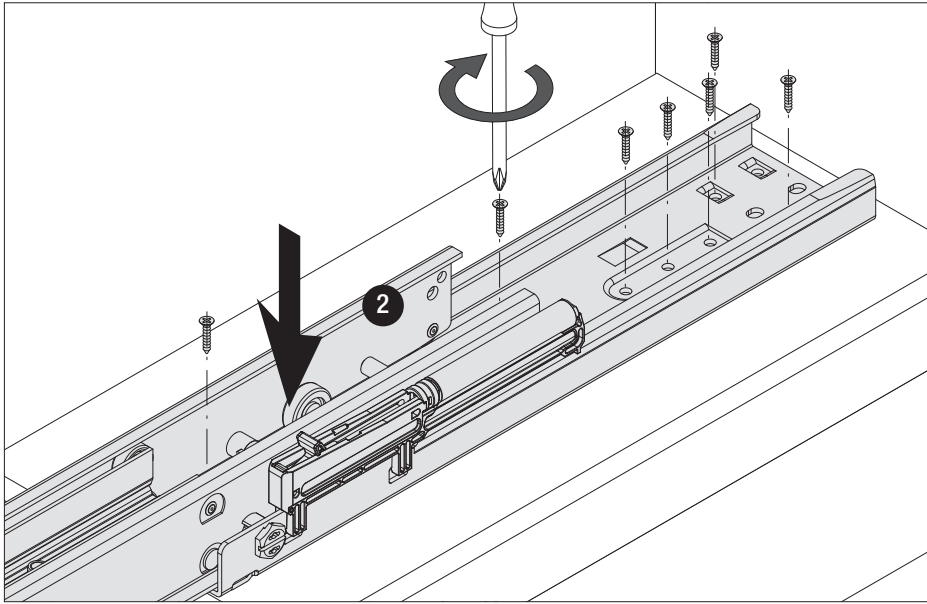

3

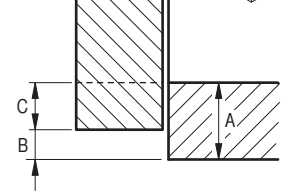
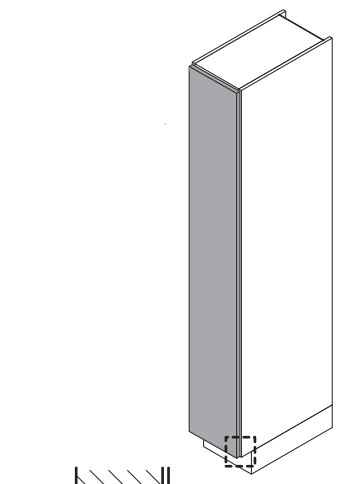
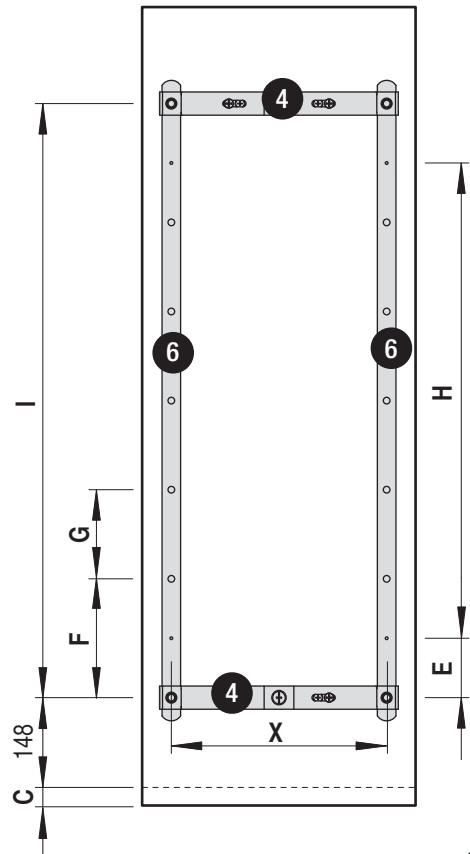
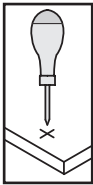
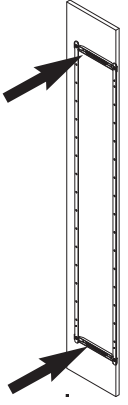
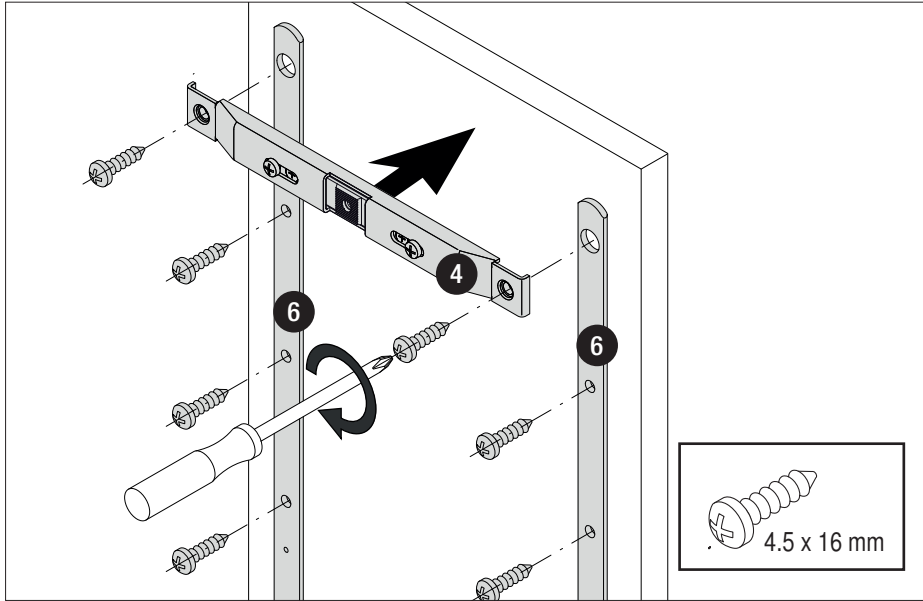

C door overlay = A - B

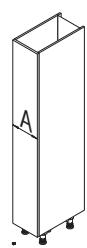

A	X
300	232 mm
400	325 mm
450	375 mm
500	425 mm
600	525 mm

	$\varnothing 5$ mm			$\varnothing 5$ mm	
	E	F	G	H	I
HSA 1	64 mm	96 mm	2 x 96 mm	256 mm	384 mm
HSA 2	64 mm	128 mm	4 x 96 mm	512 mm	640 mm
HSA 3	64 mm	112 mm	7 x 96 mm	768 mm	896 mm
HSA 4	64 mm	96 mm	10 x 96 mm	1024 mm	1152 mm
HSA 5	64 mm	128 mm	12 x 96 mm	1280 mm	1408 mm
HSA 6	64 mm	96 mm	14 x 96 mm	1408 mm	1536 mm
HSA 7	64 mm	96 mm	16 x 96 mm	1600 mm	1728 mm

4

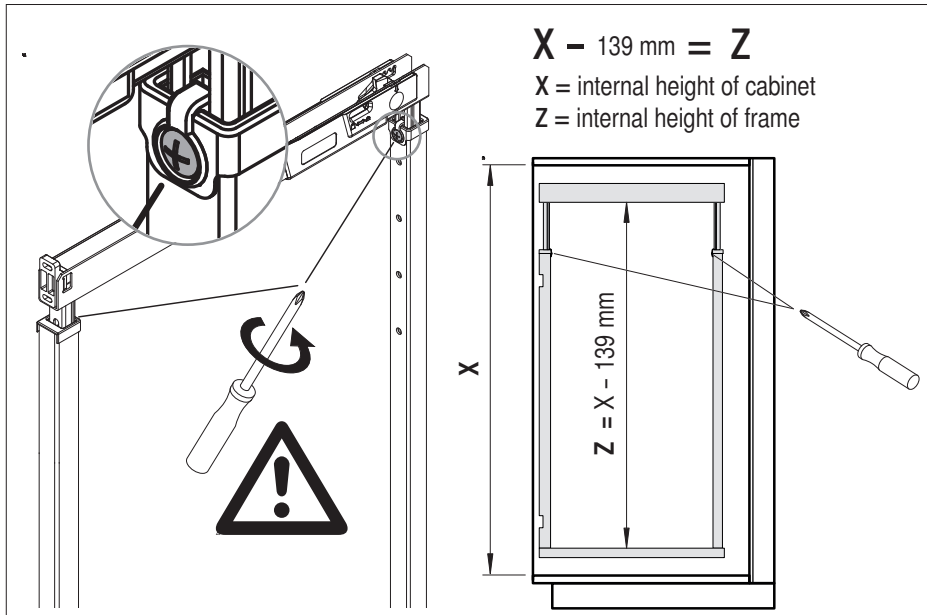

5

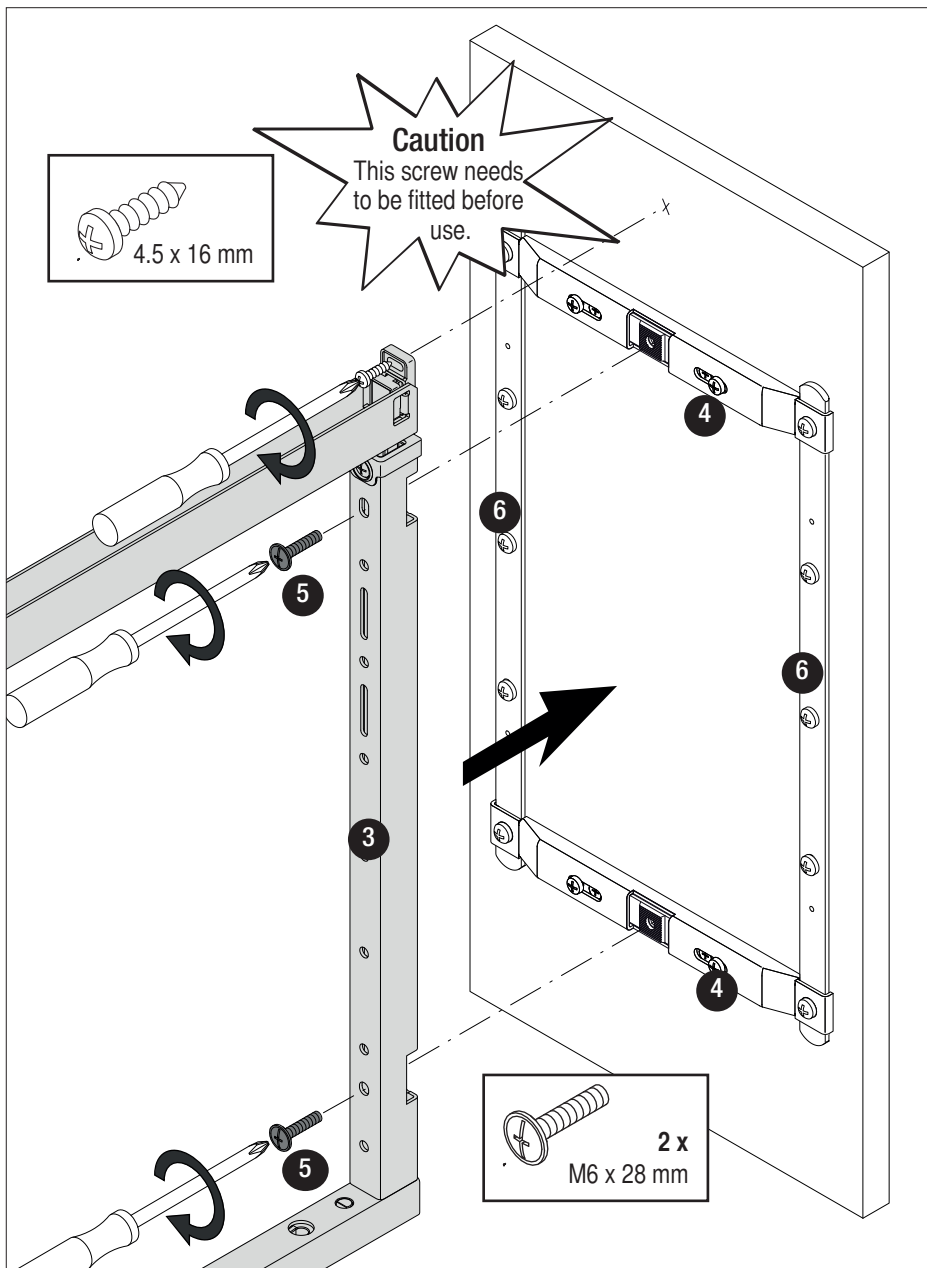

6

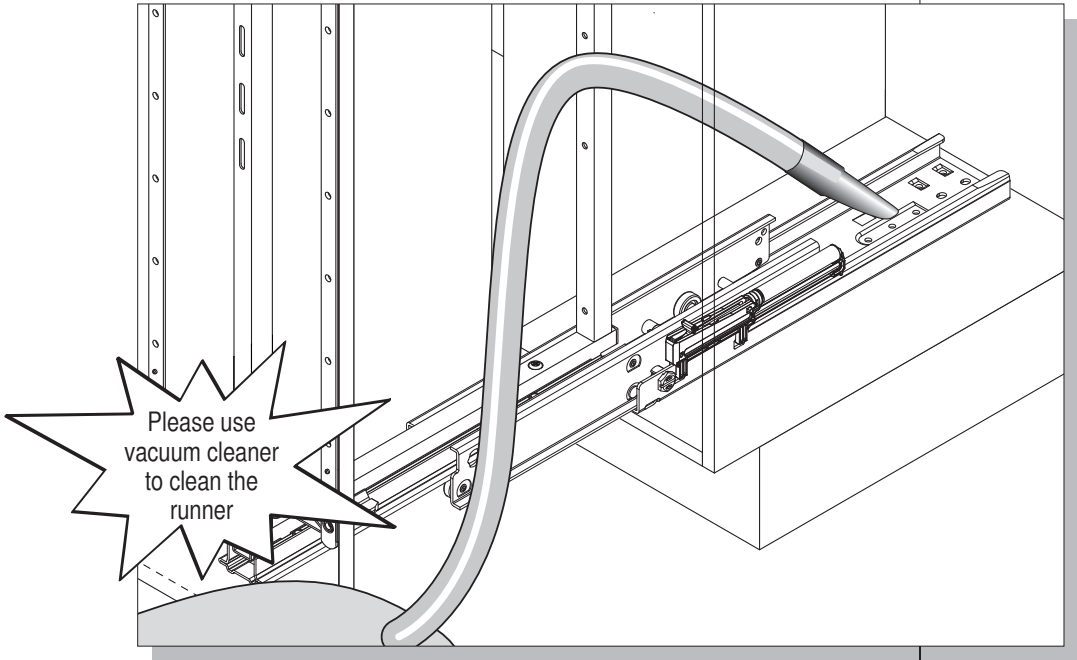
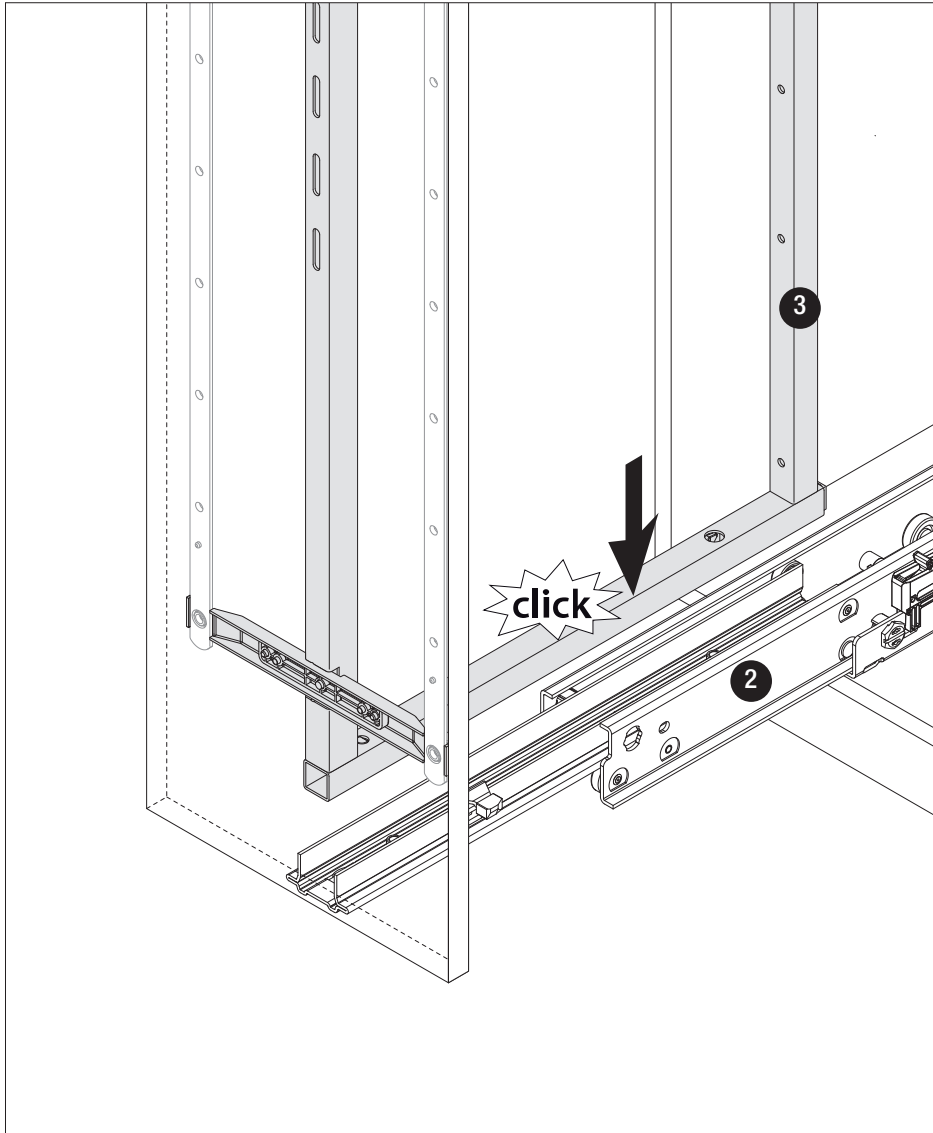

7

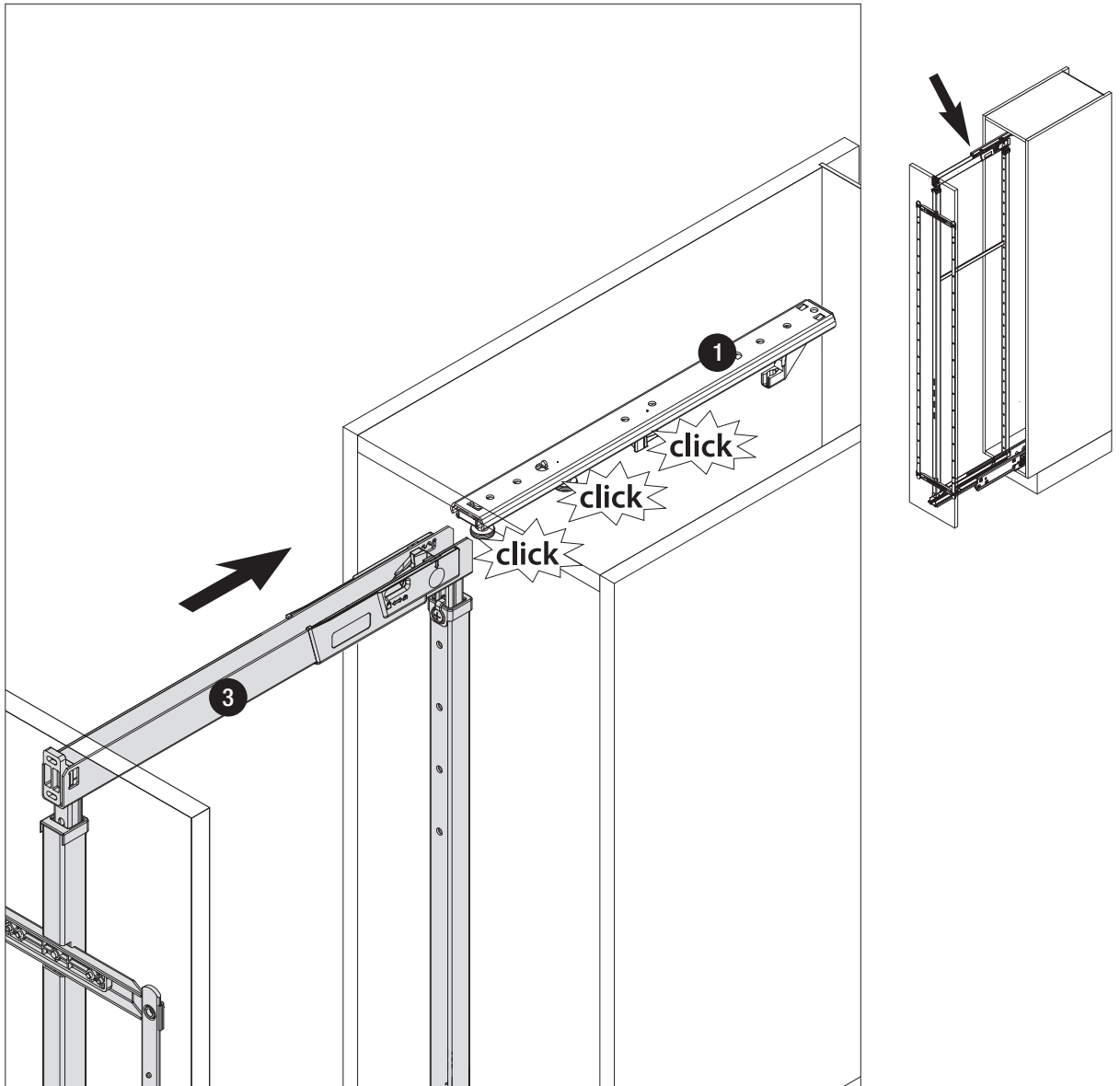

8

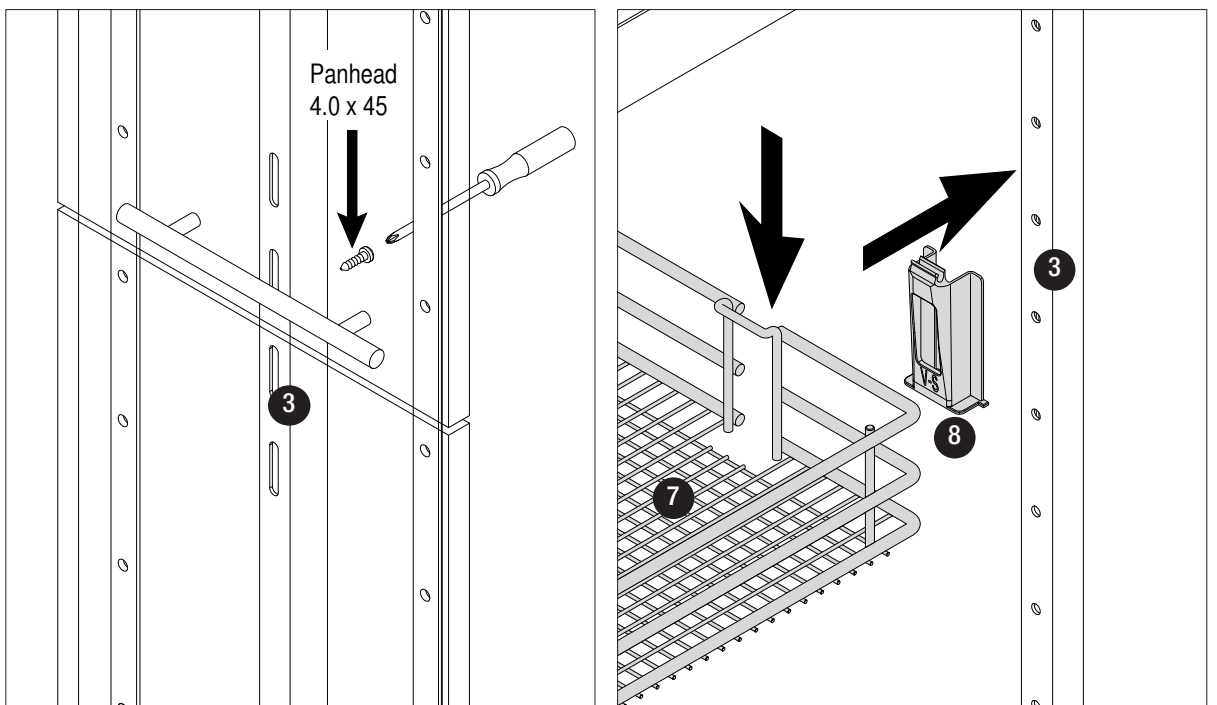

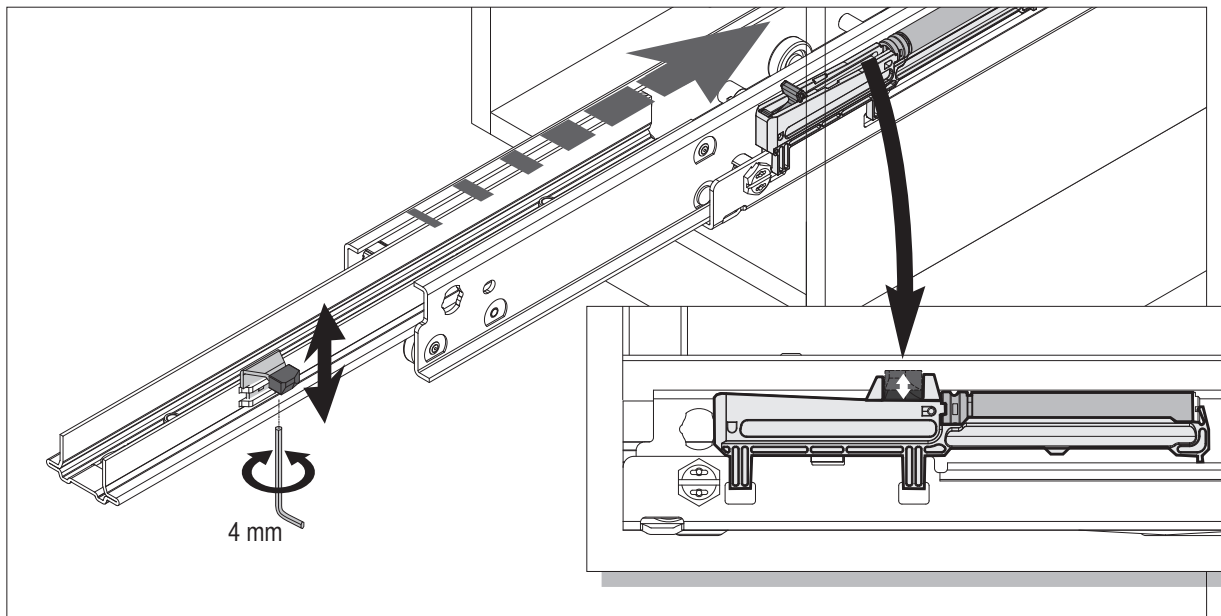
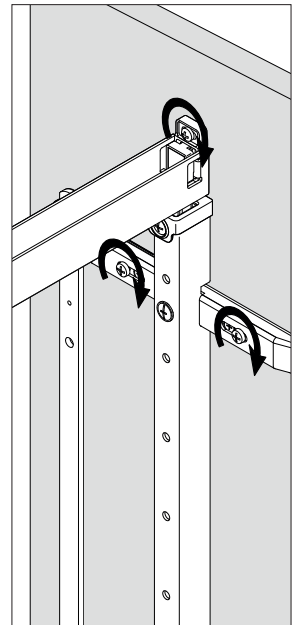
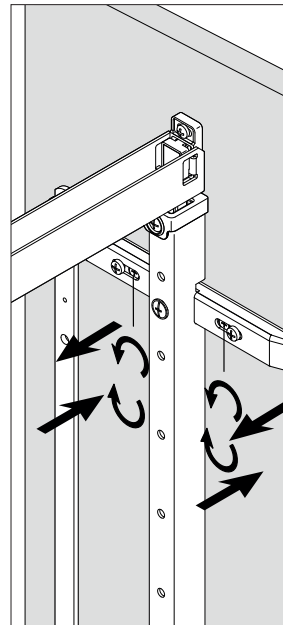
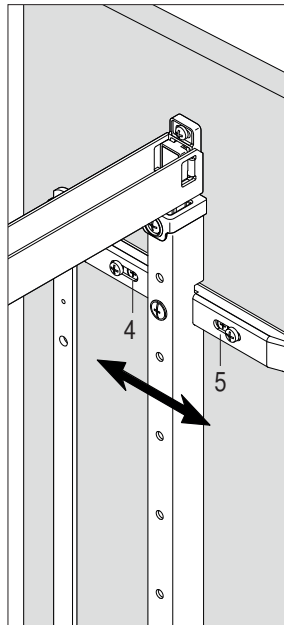
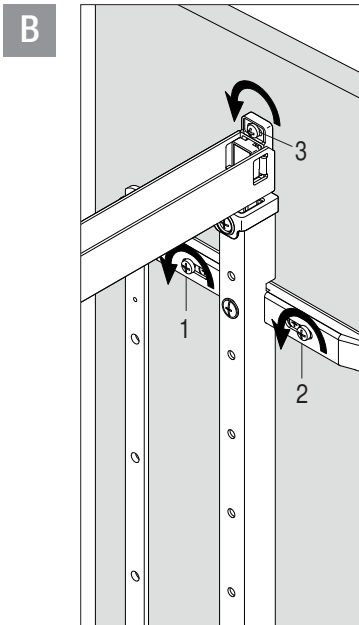
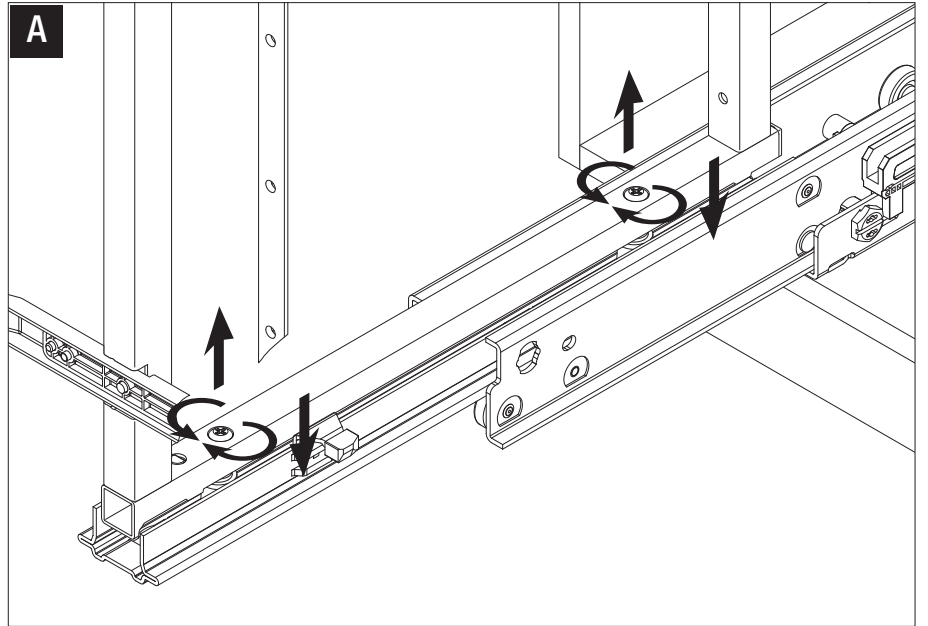
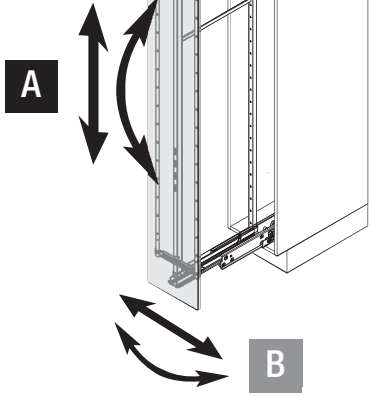

Removal of the frame

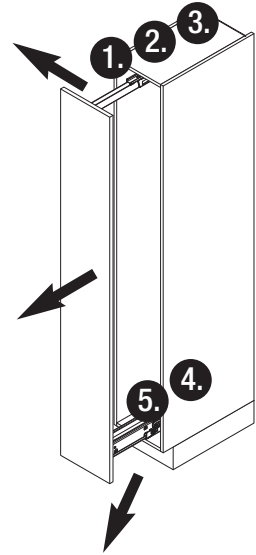
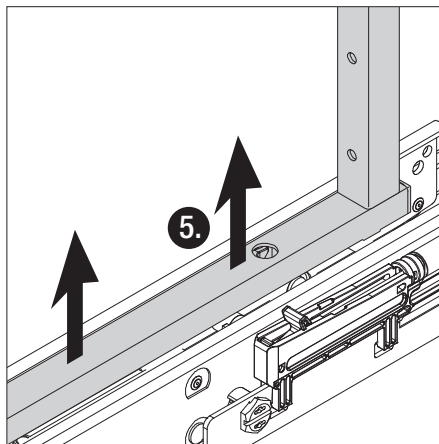
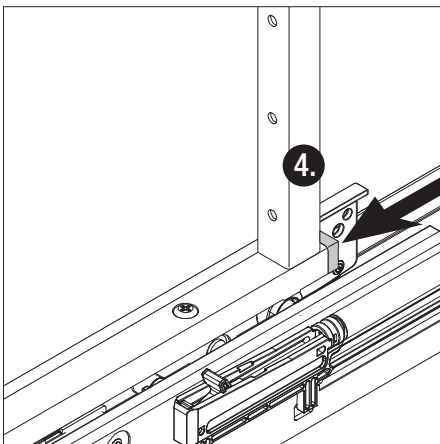
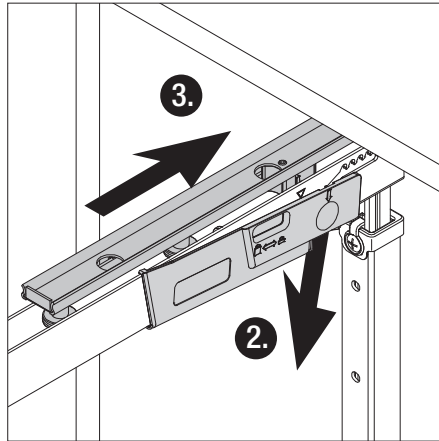
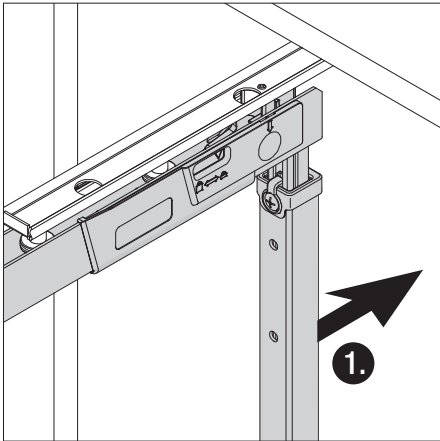

Weight adjustment on frame

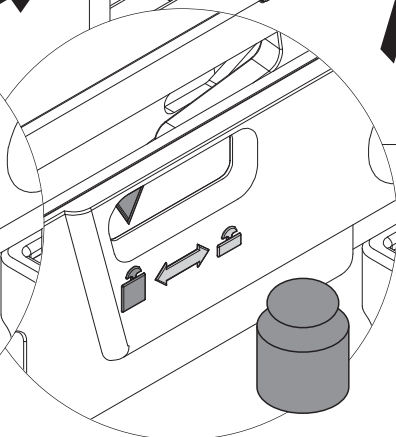
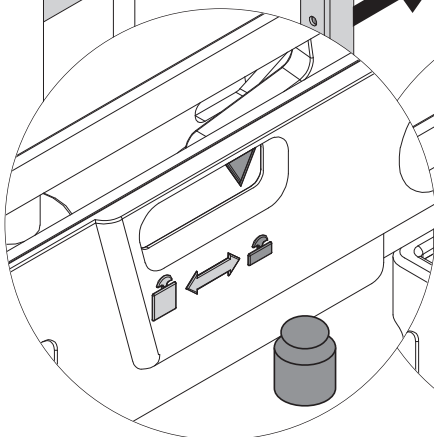
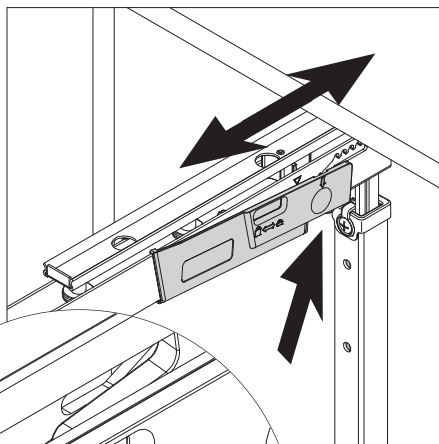
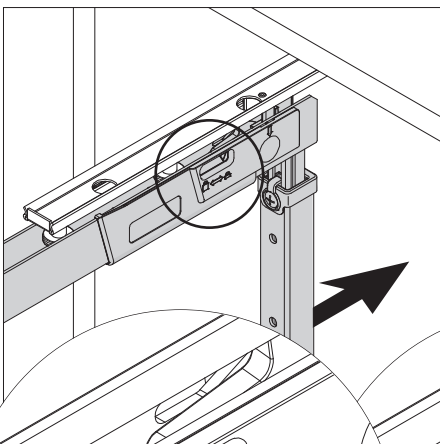

BEFORE USE OF THIS LARDER UNIT PLEASE ENSURE THE FOLLOWING IMPORTANT SAFETY POINTS HAVE BEEN FOLLOWED.

On 400, 500 and 600 mm Width Versions ensure the 5th Plinth foot (included) has been fitted to the base in a central position (Page 2/12)

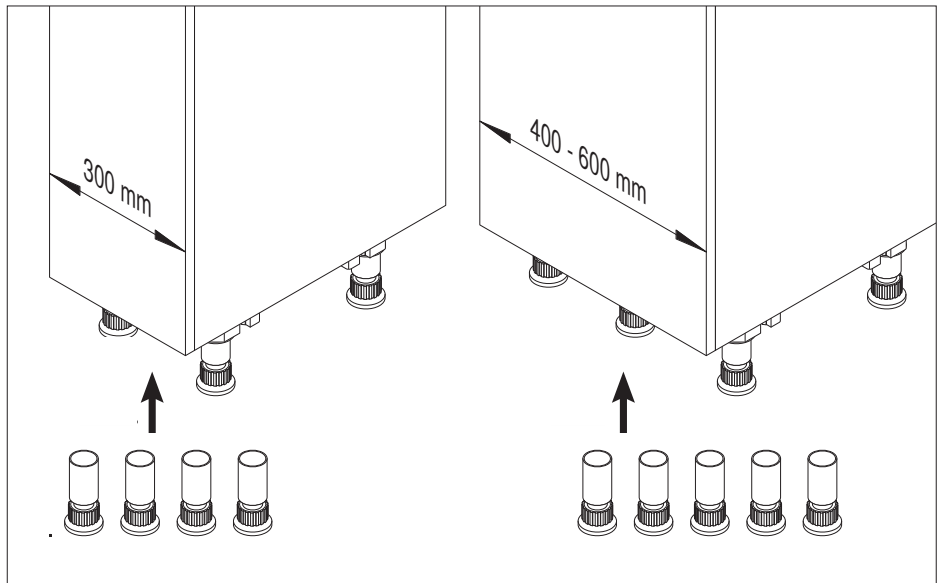

The frame has been correctly height adjusted to 139 mm less than the internal carcase height (Page 6/12)

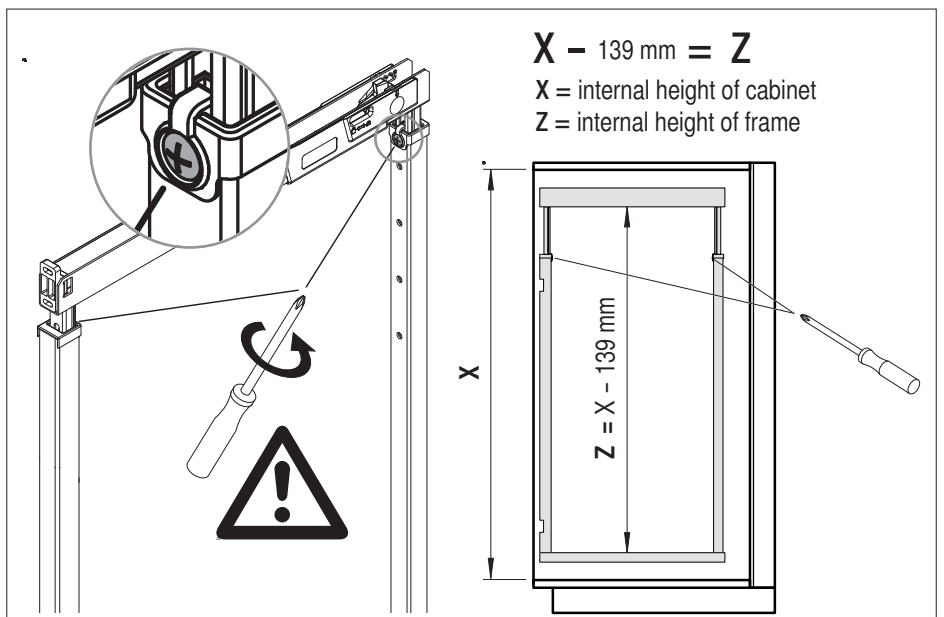

The security screw has been fitted through the top of the frame into the back of the top of the door (Page 6/12)

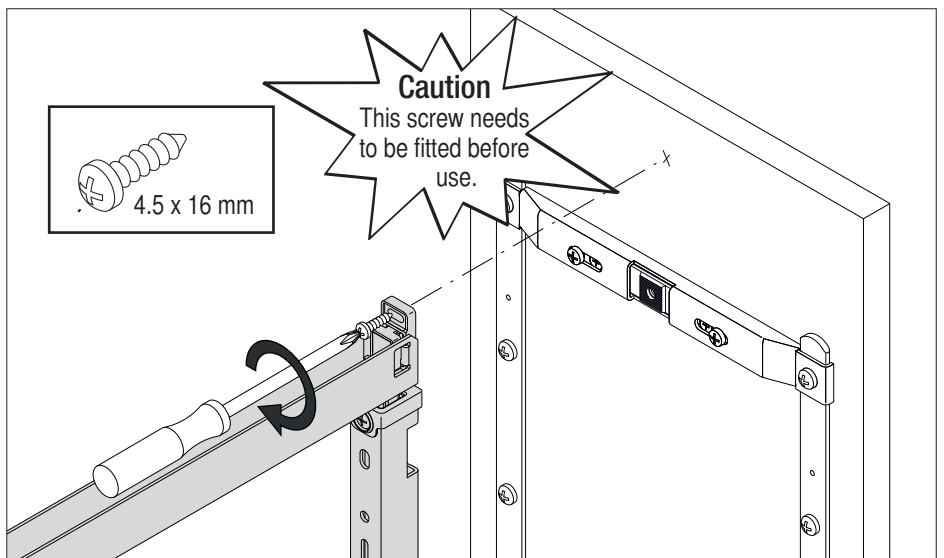

BEFORE USE OF THIS LARDER UNIT PLEASE ENSURE THE FOLLOWING IMPORTANT SAFETY POINTS HAVE BEEN FOLLOWED.

The bottom runner is clear of dirt and debris - Please do not use any lubricants (Page 7/12)

6

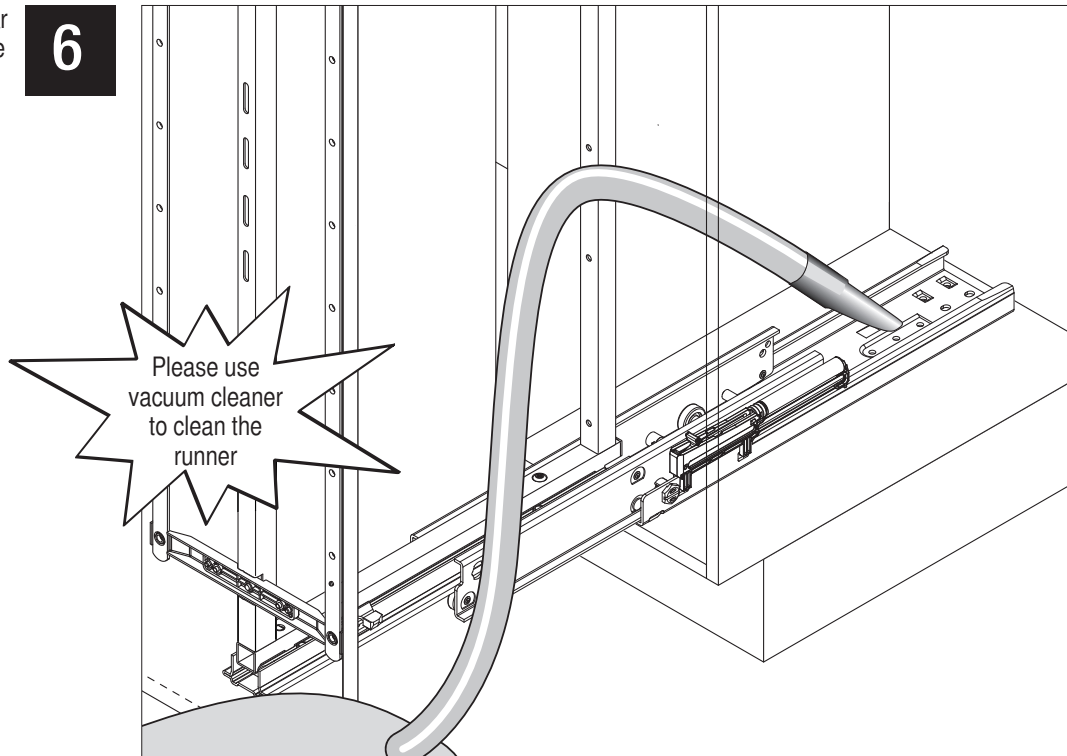

CLEANING THE LOWER RUNNER

